

# Panasonic

## Operating Instructions

2.4 GHz Digital Cordless Phone

Model No. **KX-TG3600BX**

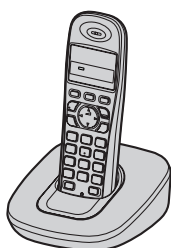

**Thank you for purchasing a Panasonic product.**

**Charge the batteries for about 7 hours before initial use.**

Please read these operating instructions before using the unit and save them for future reference.

## Table of Contents

### Introduction

Model composition . . . . .	3
Accessory information . . . . .	3

### Important Information

For your safety . . . . .	4
Important safety instructions . . . . .	5
For best performance . . . . .	5
Other information . . . . .	6
Specifications . . . . .	6

### Getting Started

Setting up . . . . .	7
Note when setting up . . . . .	8
Controls . . . . .	9
Initial settings . . . . .	10

### Making/Answering Calls

Making calls . . . . .	11
Answering calls . . . . .	11
Useful features during a call . . . . .	11

### Speed Dialer

Speed dial . . . . .	13
----------------------	----

### Programmable Settings

Ringer settings . . . . .	14
Telephone settings . . . . .	14

### Useful Information

Troubleshooting . . . . .	15
Wall mounting . . . . .	18

### Index

Index . . . . .	19
-----------------	----

## Introduction

### Model composition

Model No.	Base unit	Handset	
	Part No.	Part No.	Quantity
KX-TG3600	KX-TG3600	KX-TGA360	1

- The suffix (BX) in the following model numbers will be omitted in these instructions:  
KX-TG3600BX

### Accessory information

#### Supplied accessories

No.	Accessory item/Part number	Quantity
①	AC adaptor/PQLV219BX	1
②	Telephone line cord	1
③	Rechargeable batteries <sup>*1</sup> / HHR-65AAAB or N4DHYYY00003	2
④	Handset cover <sup>*2</sup>	1

<sup>\*1</sup> See page 3 for replacement battery information.

<sup>\*2</sup> The handset cover comes attached to the handset.



#### Additional/replacement accessories

Please contact your nearest Panasonic dealer for sales information.

Accessory item	Order number
Rechargeable batteries	HHR-4MPT <sup>*1</sup>
	Battery requirement: – Nickel metal hydride (Ni-MH) type battery – 2 AAA (R03) batteries

<sup>\*1</sup> Replacement batteries may have a different capacity from that of the supplied batteries.

## Important Information

### For your safety

To prevent severe injury and loss of life/property, read this section carefully before using the product to ensure proper and safe operation of your product.

#### WARNING

##### Power connection

- Use only the power source marked on the product.
- Do not overload power outlets and extension cords. This can result in the risk of fire or electric shock.
- Completely insert the AC adaptor/power plug into the power outlet. Failure to do so may cause electric shock and/or excessive heat resulting in a fire.
- Regularly remove any dust, etc. from the AC adaptor/power plug by pulling it from the power outlet, then wiping with a dry cloth. Accumulated dust may cause an insulation defect from moisture, etc. resulting in a fire.
- Unplug the product from power outlets if it emits smoke, an abnormal smell, or makes an unusual noise. These conditions can cause fire or electric shock. Confirm that smoke has stopped emitting and contact an authorized service center.
- Unplug from power outlets and never touch the inside of the product if its casing has been broken open.
- Never touch the plug with wet hands. Danger of electric shock exists.

##### Installation

- To prevent the risk of fire or electrical shock, do not expose the product to rain or any type of moisture.
- Do not place or use this product near automatically controlled devices such as automatic doors and fire alarms. Radio waves emitted from this product may cause such devices to malfunction resulting in an accident.
- Do not allow the AC adaptor or telephone line cord to be excessively pulled, bent or placed under heavy objects.

##### Operating safeguards

- Unplug the product from power outlets before cleaning. Do not use liquid or aerosol cleaners.
- Do not disassemble the product.
- Do not spill liquids (detergents, cleansers, etc.) onto the telephone line cord plug, or allow it to become wet at all. This may cause a fire. If the telephone line cord plug becomes wet, immediately pull it from the telephone wall jack, and do not use.

##### Medical

- Consult the manufacturer of any personal medical devices, such as pacemakers or hearing aids, to determine if they are adequately shielded from external RF (radio frequency) energy. (The product operates in the frequency range of 2.4 GHz to 2.48 GHz, and the RF transmission power is 125 mW (max.).)
- Do not use the product in health care facilities if any regulations posted in the area instruct you not to do so. Hospitals or health care facilities may be using equipment that could be sensitive to external RF energy.

#### CAUTION

##### Installation and relocation

- Never install telephone wiring during an electrical storm.
- Never install telephone line jacks in wet locations unless the jack is specifically designed for wet locations.
- Never touch uninsulated telephone wires or terminals unless the telephone line has been disconnected at the network interface.
- Use caution when installing or modifying telephone lines.
- The AC adaptor is used as the main disconnect device. Ensure that the AC outlet is installed near the product and is easily accessible.
- This product is unable to make calls when:
  - the handset batteries need recharging or have failed.
  - there is a power failure.

## Important Information

### Battery

- We recommend using the batteries noted on page 3. **USE ONLY rechargeable Ni-MH batteries AAA (R03) size.**
- Do not mix old and new batteries.
- Do not open or mutilate the batteries. Released electrolyte from the batteries is corrosive and may cause burns or injury to the eyes or skin. The electrolyte is toxic and may be harmful if swallowed.
- Exercise care when handling the batteries. Do not allow conductive materials such as rings, bracelets, or keys to touch the batteries, otherwise a short circuit may cause the batteries and/or the conductive material to overheat and cause burns.
- Charge the batteries provided with or identified for use with this product only, in accordance with the instructions and limitations specified in this manual.
- Only use a compatible base unit (or charger) to charge the batteries. Do not tamper with the base unit (or charger). Failure to follow these instructions may cause the batteries to swell or explode.

### Important safety instructions

When using your product, basic safety precautions should always be followed to reduce the risk of fire, electric shock, and injury to persons, including the following:

1. Do not use this product near water for example, near a bathtub, washbowl, kitchen sink, or laundry tub, in a wet basement or near a swimming pool.
2. Avoid using a telephone (other than a cordless type) during an electrical storm. There may be a remote risk of electric shock from lightning.
3. Do not use the telephone to report a gas leak in the vicinity of the leak.
4. Use only the power cord and batteries indicated in this manual. Do not dispose of batteries in a fire. They may explode. Check with local codes for possible special disposal instructions.

**SAVE THESE INSTRUCTIONS**

### For best performance

#### Base unit location/avoiding noise

The base unit and other compatible Panasonic units use radio waves to communicate with each other.

- For maximum coverage and noise-free communications, place your base unit:
  - at a convenient, high, and central location with no obstructions between the handset and base unit in an indoor environment.
  - away from electronic appliances such as TVs, radios, personal computers, wireless devices, or other phones.
  - facing away from radio frequency transmitters, such as external antennas of mobile phone cell stations. (Avoid putting the base unit on a bay window or near a window.)
- Coverage and voice quality depends on the local environmental conditions.
- If the reception for a base unit location is not satisfactory, move the base unit to another location for better reception.

#### Environment

- Keep the product away from electrical noise generating devices, such as fluorescent lamps and motors.
- The product should be kept free from excessive smoke, dust, high temperature, and vibration.
- The product should not be exposed to direct sunlight.
- Do not place heavy objects on top of the product.
- When you leave the product unused for a long period of time, unplug the product from the power outlet.
- The product should be kept away from heat sources such as heaters, kitchen stoves, etc. It should not be placed in rooms where the temperature is less than 0 °C or greater than 40 °C. Damp basements should also be avoided.
- The maximum calling distance may be shortened when the product is used in the following places: Near obstacles such as hills, tunnels, underground, near metal objects such as wire fences, etc.

## Important Information

- Operating the product near electrical appliances may cause interference. Move away from the electrical appliances.

### Routine care

- **Wipe the outer surface of the product with a soft moist cloth.**
- Do not use benzene, thinner, or any abrasive powder.

### Notice for product disposal, transfer, or return

- This product can store your private/confidential information. To protect your privacy/confidentiality, we recommend that you erase information such as phonebook or caller list entries from the memory before you dispose of, transfer, or return the product.

### ■ Operating conditions:

0 °C – 40 °C, 20 % – 80 % relative air humidity (dry)

### Note:

- Design and specifications are subject to change without notice.
- The illustrations in these instructions may vary slightly from the actual product.

## Other information

### Information on Disposal in other Countries outside the European Union



These symbols are only valid in the European Union. If you wish to discard these items, please contact your local authorities or dealer and ask for the correct method of disposal.

## Specifications

- **Frequency range:**  
2.4 GHz to 2.48 GHz
- **RF transmission power:**  
125 mW (max.)
- **Power source:**  
220–240 V AC, 50/60 Hz
- **Power consumption:**  
Standby: Approx. 1.2 W  
Maximum: Approx. 3.2 W

## Getting Started

### Setting up

#### Connections

- Use only the supplied Panasonic AC adaptor PQLV219BX.

#### ■ Base unit

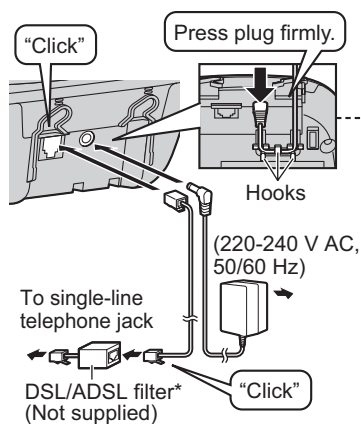

#### Correct

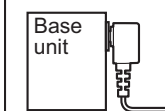

#### Wrong

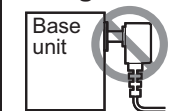

\*For DSL/ADSL service users

### Battery installation

- USE ONLY Ni-MH batteries AAA (R03) size.
- Do NOT use Alkaline/Manganese/Ni-Cd batteries.
- Confirm correct polarities ( $\oplus$ ,  $\ominus$ ).

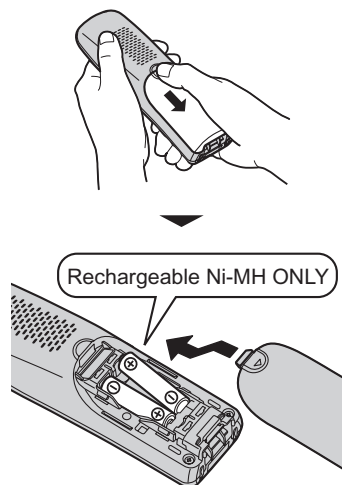

### Battery charge

Charge for about 7 hours.

- When the batteries are fully charged, the charge indicator goes off.

Charge indicator



## Getting Started

### Note when setting up

#### Note for connections

- The AC adaptor must remain connected at all times. (It is normal for the adaptor to feel warm during use.)
- The AC adaptor should be connected to a vertically oriented or floor-mounted AC outlet. Do not connect the AC adaptor to a ceiling-mounted AC outlet, as the weight of the adaptor may cause it to become disconnected.

#### During a power failure

The unit will not work during a power failure. We recommend connecting a corded-type telephone (without AC adaptor) to the same telephone line or to the same telephone line jack using a T-adaptor.

#### Note for battery installation

- Use the supplied rechargeable batteries. For replacement, we recommend using the Panasonic rechargeable batteries noted on page 3, 5.
- Wipe the battery ends (⊕, ⊖) with a dry cloth.
- Avoid touching the battery ends (⊕, ⊖) or the unit contacts.

#### Note for battery charge

- It is normal for the handset to feel warm during charging.
- Clean the charge contacts of the handset and base unit with a soft and dry cloth once a month. Clean more often if the unit is exposed to grease, dust, or high humidity.

### Panasonic Ni-MH battery performance (supplied batteries)

Operation	Operating time
In continuous use	5 hours max.* <sup>1</sup>
Not in use (standby)	11 days max.

\*<sup>1</sup> When the clarity booster feature is turned on (page 12): 3 hours max.

#### Note:

- Actual battery performance depends on a combination of how often the handset is in use and how often it is not in use (standby).
- Even after the handset is fully charged, the handset can be left on the base unit without any ill effect on the batteries.
- The battery level may not be displayed correctly after you replace the batteries. In this case, place the handset on the base unit and let it charge for at least 7 hours.



## Getting Started

### Controls

#### Handset

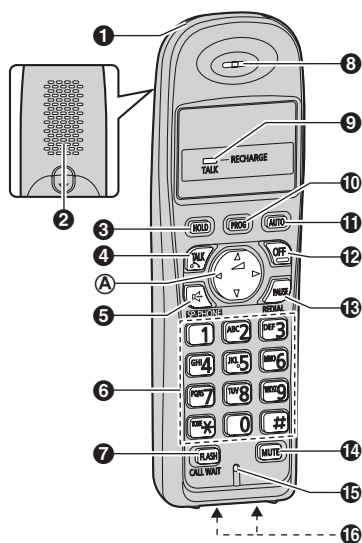

- 1 Charge indicator  
Ringer indicator
- 2 Speaker
- 3 [HOLD]
- 4 [TALK]
- 5 [SP-PHONE: Speakerphone]
- 6 Dial keypad ([\*]: TONE)
- 7 [FLASH] [CALL WAIT]
- 8 Receiver
- 9 TALK/RECHARGE indicator
- 10 [PROG] (Program)
- 11 [AUTO]
- 12 [OFF]
- 13 [PAUSE] [REDIAL]
- 14 [MUTE]
- 15 Microphone
- 16 Charge contacts

#### Control type

##### Ⓐ Navigator key/ (Volume) key

By pressing this key ([▲], [▼], [◀], or [▶]) repeatedly, you can:

- adjust the receiver or speaker volume (up or down) while talking
- select ringer tone (left or right)

#### Base unit

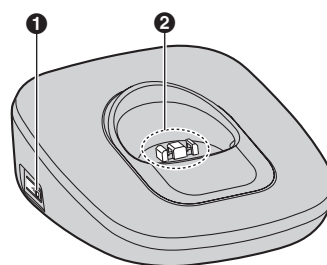

- 1 [( ))] (Locator)
- 2 Charge contacts

## Getting Started

### Initial settings

#### Important:

- Before setting, make sure the TALK indicator is off. The handset must be operated near the base unit and while off the base unit.

### Dialing mode

If you cannot make calls, change this setting according to your telephone line service. The default setting is Tone.

Tone: For tone dial service.

Pulse: For rotary/pulse dial service.

#### 1 [PROG]

- The TALK indicator flashes.

#### 2 [AUTO]

3 To select Pulse, press [⏏] 2 times.  
OR

To select Tone, press [✱] 2 times.

#### 4 [PROG]

- The handset beeps.

## Making/Answering Calls

### Making calls

- 1 Lift the handset, press **[📞]**, and then dial the phone number.
- 2 When you finish talking, press **[OFF]** or place the handset on the base unit.

### Using the speakerphone

- 1 Press **[📞]** and dial the phone number.
  - Speak alternately with the other party.
- 2 When you finish talking, press **[OFF]**.

#### Note:

- For best performance, use the speakerphone in a quiet environment.
- To switch to the receiver, press **[📞]**.

### Adjusting the receiver or speaker volume

Press **[▲]** or **[▼]** repeatedly while talking.

### To redial the last number dialed (48 digits max.)

**[📞] → [REDIAL]**

### Answering calls

When a call is being received, the ringer indicator on the handset flashes rapidly.

- 1 If the handset is off the base unit, press **[📞]** or **[📞]**.
  - You can also answer the call by pressing any button from **[0]** to **[9]**, **[\*]**, or **[#]**. (Any key talk feature)

OR

If the handset is on the base unit, just lift up.

- 2 When you finish talking, press **[OFF]**.

#### Note:

- You can change the handset ringer volume and ringer tone (page 14).

### Temporary ringer off

While the handset is ringing for a call, you can turn the ringer off temporarily by pressing **[OFF]**.

### Handset locator

You can locate a misplaced handset by pressing **[📞]** (Locator) on the base unit. To stop paging, press it again or **[OFF]** on the handset.

## Useful features during a call

### Hold

This feature allows you to put an outside call on hold.

Press **[HOLD]** during an outside call.

- To release the hold, press **[📞]**.

#### Note:

- If another phone is connected to the same line (page 8), you can also take the call by lifting its handset.
- If a call is kept on hold for more than 9 minutes, an alarm tone starts to sound and the ringer indicator on the handset flashes rapidly. After 1 additional minute on hold, the call is disconnected.

## Making/Answering Calls

### Mute

While mute is turned on, you can hear the other party, but the other party cannot hear you.

- 1 Press **[MUTE]** during an outside call.
  - The TALK indicator flashes.
- 2 To return to the conversation, press **[MUTE]** or **[↶]**.

### Flash

**[FLASH]** allows you to use the special features of your host PBX such as transferring an extension call, or accessing optional telephone services.

#### Note:

- To change the flash time, see page 14.

### For call waiting service users

To use call waiting, you must first subscribe to the call waiting service of your service provider/telephone company.

This feature allows you to receive calls while you are already talking on the phone. If you receive a call while on the phone, you will hear a call waiting tone.

- 1 Press **[CALL WAIT]** to answer the 2nd call.
- 2 To switch between calls, press **[CALL WAIT]**.

#### Note:

- Please contact your service provider/telephone company for details and availability of this service in your area.

### Temporary tone dialing (for rotary/pulse service users)

You can temporarily switch the dialing mode to tone when you need to access

touch-tone services (for example, answering services, telephone banking services, etc.).

Press **[\*]** (TONE) before entering access numbers which require tone dialing.

### Handset clarity booster

This feature can improve sound clarity when the handset is used in an area where there may be interference. During an outside call, this feature is turned on automatically when necessary.

#### Note:

- While this feature is turned on, the battery operating time is shortened (page 8).

## Speed Dialer

### Speed dial

You can assign 1 phone number to each of the 10 dial keys [0] – [9].

#### Assigning a phone number to a dial key

##### Important:

- Before assigning phone numbers, make sure the TALK indicator is off.

- 1 [PROG]**
  - The TALK indicator flashes.
- 2** Enter the phone number (max. 32 digits).
  - If a pause is required for dialing, press [PAUSE] where needed.
  - If you misdialed, press [PROG] or [OFF] and repeat from step 1.
- 3 [AUTO]**
- 4** Press a dial key [0] – [9].
  - The handset beeps.
  - To store other phone numbers, repeat from step 1.

##### Note:

- If a phone number is assigned in a dial key which already contains a phone number, the old number is erased.
- We recommend you make a note of which phone numbers are assigned in which dial keys.

#### PAUSE (for PBX/long distance service users)

A pause is sometimes required when making calls using a PBX or long distance service.

For example, if you need to dial the line access number "9" with a PBX:

In step 2, press [9], [PAUSE], then enter the phone number.

##### Note:

- A 3.5 second pause is inserted each time [PAUSE] is pressed. Press repeatedly to insert longer pauses.

#### Canceling a speed dial assignment

- 1 [PROG] → [AUTO]**
- 2** Press the desired dial key [0] – [9].
  - The handset beeps.

#### Making a call with speed dial

- 1** Press [↶] or [↷]. → [AUTO]
- 2** Press the desired dial key [0] – [9].
  - The stored phone number is dialed.

## Programmable Settings

### Ringer settings

#### Important:

- Before setting, make sure the TALK indicator is off. The handset must be operated near the base unit and while off the base unit.

#### Handset ringer volume

4 levels (high/medium/low/off) are available. The default setting is High.

#### Adjusting the handset ringer volume

- 1 Press [**▲**] or [**▼**] repeatedly to select the desired volume.
- 2 Press [**PROG**] or [**OFF**].

#### Tuning the ringer volume off

Press and hold [**▼**] until the handset beeps 2 times.

To turn the ringer on, press [**▲**].

#### Note:

- The handset rings at the low level when paged by the base unit.

#### Handset ringer tone

You can change the ringer tone heard when an outside call is received. There are 3 tones and 4 melodies. The default setting is Tone 1.

- 1 Press [**▼**] or [**▲**].
- 2 Press [**◀**] or [**▶**] repeatedly to select the desired setting.
  - You can also select the ringer tone by pressing [**1**] – [**7**].
  - [**1**] – [**3**]: Tones
  - [**4**] – [**7**]: Melodies
- 3 Press [**PROG**] or [**OFF**].

#### Note:

- If you select one of the melody ringer patterns, the ringer will continue to sound for several seconds if:

- the caller hangs up before you answer the call.
- another person answers the call using another phone connected on the same line.

### Telephone settings

#### Important:

- Before setting, make sure the TALK indicator is off. The handset must be operated near the base unit and while off the base unit.

#### Flash time

The flash time depends on your telephone exchange or host PBX. You can select: 90ms (milliseconds), 100ms, 110ms, 250ms, 300ms, 400ms, 600ms, or 700ms.

The default setting is 700 ms.

- 1 [**PROG**]
  - The TALK indicator flashes.
- 2 Press [**1**] – [**8**] to select the desired setting.
  - [**1**]: 90ms [**2**]: 100ms [**3**]: 110ms
  - [**4**]: 250ms [**5**]: 300ms [**6**]: 400ms
  - [**7**]: 600ms [**8**]: 700ms
- 3 [**AUTO**] → [**FLASH**]
  - The handset beeps.

#### Note:

- The flash time depends on your telephone exchange or host PBX. Contact your PBX supplier if necessary.

**Useful Information****Troubleshooting**

If you still have difficulties after following the instructions in this section, disconnect the base unit's AC adaptor, then reconnect the base unit's AC adaptor. Remove the batteries from the handset, and then insert the batteries into the handset again.

**General use**

Problem	Cause/solution
The unit does not work.	<ul style="list-style-type: none"><li>• Make sure the batteries are installed correctly (page 7).</li><li>• Fully charge the batteries (page 7).</li><li>• Check the connections (page 7).</li><li>• Unplug the base unit's AC adaptor to reset the unit. Reconnect the adaptor and try again.</li><li>• The handset has not been registered to the base unit. Register the handset (page 17).</li></ul>
An alarm tone sounds when you press [📞] or [📞].	<ul style="list-style-type: none"><li>• The handset is too far from the base unit. Move closer and try again.</li><li>• Plug in the base unit's AC adaptor.</li><li>• If the above remedies do not solve the problem, the handset may have lost communication with the base unit. Register the handset again (page 17).</li></ul>
I cannot hear a dial tone.	<ul style="list-style-type: none"><li>• The base unit's AC adaptor or telephone line cord is not connected. Check the connections.</li><li>• If you are using a splitter to connect the unit, remove the splitter and connect the unit to the wall jack directly. If the unit operates properly, check the splitter.</li><li>• Disconnect the base unit from the telephone line and connect the line to a known working telephone. If the working telephone operates properly, contact our service personnel to have the unit repaired. If the working telephone does not operate properly, contact your service provider/telephone company.</li></ul>

**Programmable settings**

Problem	Cause/solution
While programming, the handset starts to ring.	<ul style="list-style-type: none"><li>• A call is being received. Answer the call and start again after hanging up.</li></ul>

## Useful Information

### Battery recharge

Problem	Cause/solution
The RECHARGE indicator flashes slowly or the handset beeps intermittently.	<ul style="list-style-type: none"><li>• Battery charge is low. Fully charge the batteries (page 7).</li></ul>
I charged the battery fully, but the RECHARGE indicator continues to flash slowly.	<ul style="list-style-type: none"><li>• Clean the charge contacts and charge again (page 8).</li><li>• It is time to replace the batteries (page 5).</li></ul>
I fully charged the batteries, but the operating time seems to be shorter.	<ul style="list-style-type: none"><li>• Clean the battery ends (⊕, ⊖) and the charge contacts with a dry cloth, and charge again.</li></ul>

### Making/answering calls, intercom

Problem	Cause/solution
Noise is heard, sound cuts in and out.	<ul style="list-style-type: none"><li>• You are using the handset or base unit in an area with high electrical interference. Reposition the base unit and use the handset away from sources of interference.</li><li>• Move closer to the base unit.</li><li>• If you use a DSL/ADSL service, we recommend connecting a DSL/ADSL filter between the base unit and the telephone line jack. Contact your DSL/ADSL provider for details.</li></ul>
The handset does not ring.	<ul style="list-style-type: none"><li>• The ringer volume is turned off. Adjust the ringer volume (page 14).</li></ul>
I cannot make a call.	<ul style="list-style-type: none"><li>• The dialing mode may be set incorrectly. Change the setting (page 10).</li><li>• The handset is too far from the base unit. Move closer and try again.</li></ul>



**Useful Information****Registration**

Problem	Cause/solution
The handset registration may have been canceled or the communication between the base unit and the handset is unstable.	<ul style="list-style-type: none"><li>• Re-register the handset.<ol style="list-style-type: none"><li><b>1 Base unit:</b> Press and hold <b>[•••]</b> (Locator) for about 4 seconds. (No registration tone)<ul style="list-style-type: none"><li>– The next step must be completed within 90 seconds.</li></ul></li><li><b>2 Handset:</b> Press and hold <b>[FLASH]</b> until the TALK indicator flashes, then wait until the handset beeps.</li></ol></li><li>• If the above remedy does not solve the problem, contact your nearest Panasonic service center.</li></ul>

**Liquid damage**

Problem	Cause/solution
Liquid or other form of moisture has entered the handset/base unit.	<ul style="list-style-type: none"><li>• Disconnect the AC adaptor and telephone line cord from the base unit. Remove the batteries from the handset and leave to dry for at least 3 days. After the handset/base unit are completely dry, reconnect the AC adaptor and telephone line cord. Insert the batteries and charge fully before use. If the unit does not work properly, contact an authorized service center.</li></ul>

**Caution:**

- To avoid permanent damage, do not use a microwave oven to speed up the drying process.

## Useful Information

### Wall mounting

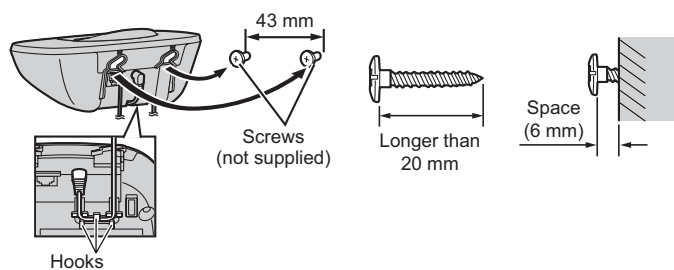

## Index

### Index

- A** Answering calls: 11
- B** Battery: 7, 8
  - Booster (Clarity booster): 12
- C** Call waiting: 12
  - Control type: 9
- D** Dialing mode: 10
- F** Flash: 12
- H** Handset locator: 11
  - Hold: 11
- M** Making calls: 11
  - Mute: 12
- P** Pause: 13
- R** Redialing: 11
  - Ringer tone: 14
- S** SP-PHONE (Speakerphone): 11
- T** Temporary tone dialing: 12
  - Troubleshooting: 15
- V** Volume
  - Receiver: 11
  - Ringer (Handset): 14
  - Speaker: 11
- W** Wall mounting: 18

**For your future reference**

We recommend keeping a record of the following information to assist with any repair under warranty.

Serial No.

Date of purchase

(found on the bottom of the base unit)

Name and address of dealer

Attach your purchase receipt here.

**Panasonic Communications Co., Ltd.**

1-62, 4-chome, Minoshima, Hakata-ku, Fukuoka 812-8531, Japan

**Copyright:**

This material is copyrighted by Panasonic Communications Co., Ltd., and may be reproduced for internal use only. All other reproduction, in whole or in part, is prohibited without the written consent of Panasonic Communications Co., Ltd.

© Panasonic Communications Co., Ltd. 2009



\*TG3600BX\*

**PNQX1811ZA** CM0109DM0