

Model No.	TH-L32B6G	TH-L39B6G	TH-L50B6G
	TH-L32B6K	TH-L39B6K	TH-L50B6K
	TH-L32B6M	TH-L39B6M	TH-L50B6M
	TH-L32B6X	TH-L39B6X	
	TH-L32B68G	TH-L39B68K	
	TH-L32B68K	TH-L39B69K	
	TH-L32B69K		

Operating Instructions LED TV

Contents

Safety Precautions	2
Setting Up the TV	3
Connecting the TV	5
Initial Setup	6
Operating the TV	7
Watching External Inputs	8
Using the Media Player	8
Using the Menu Functions	10
Additional Information	12
Troubleshooting	13
Specifications	14
Maintenance	15
Licence	15

VIERA



English

Thank you for purchasing this Panasonic product. Please read these instructions carefully before operating this product and retain them for future reference.

The images shown in this manual are for illustrative purposes only. Some illustrations are presented as conceptual images and may be different from the actual products. Illustrations shown may be different between models and countries.

Transport only in upright position



Safety Precautions

To help avoid risk of electrical shock, fire, damage or injury, please follow the warnings and cautions below:

Mains plug and lead

Warning

If you detect anything unusual, immediately remove the mains plug.
 * Mains plug types vary between countries.

* This TV is designed to operate on:
 – TH-L32B6K/TH-L32B68K/TH-L32B69K:
 AC 220 - 240 V, 50/60 Hz
 – Other models: AC Auto 110 - 240 V, 50/60 Hz
 * Insert the mains plug fully into the socket outlet.
 * Ensure that the mains plug is easily accessible.
 * Disconnect the mains plug when cleaning the TV.
 * Do not touch the mains plug with wet hands.

* Do not damage the mains lead.
 * Do not place a heavy object on the lead.

Do not place the lead near a high temperature object.
 Do not pull on the lead. Hold onto the mains plug body when disconnecting the plug.

Do not move the TV with the lead plugged into a socket outlet.
 Do not twist the lead, bend it excessively or stretch it.
 Do not use a damaged mains plug or socket outlet.
 * Ensure the TV does not crush the mains lead.

* Do not use any mains lead other than that provided with this TV.

Take care

Warning

* Do not remove covers and never modify the TV yourself as live parts are accessible when they are removed. There are no user serviceable parts inside.
 * Do not expose the TV to rain or excessive moisture. This TV must not be exposed to dripping or splashing water and objects filled with liquid, such as vases, must not be placed on top of or above the TV.
 * Do not insert foreign objects into the TV through the air vents.
 * Do not use an unapproved pedestal / mounting equipment. Be sure to ask your local Panasonic dealer to perform the setup or installation of approved wall-hanging brackets.
 * Do not apply strong force or impact to the display panel.

* Do not place the TV on sloped or unstable surfaces, and ensure that the TV does not hang over the edge of the base.
 * This TV is designed for table-top use.
 * Do not expose the TV to direct sunlight and other sources of heat.

To prevent the spread of fire, keep candles or other open flames away from this product at all times

Dangerous part / Small object

Warning

* This product contains possibly dangerous parts such as plastic bags, that can be breathed in or swallowed by young children accidentally. Keep these parts out of reach of young children.

Pedestal

Warning

* Do not disassemble or modify the pedestal.

Caution

* Do not use any pedestal other than the one provided with this TV.
 * Do not use the pedestal if it becomes warped or physically damaged. If this occurs, contact your nearest Panasonic dealer immediately.
 * During setup, make sure that all screws are securely tightened.
 * Ensure that the TV does not suffer any impact during installation of the pedestal.
 * Ensure that children do not climb onto the pedestal.
 * Install or remove the TV from the pedestal with at least two people.
 * Install or remove the TV by the specified procedure.

Ventilation

Caution

Allow sufficient space around the TV in order to help prevent excessive heat, which could lead to early failure of some electronic components.

Minimum distance (cm)

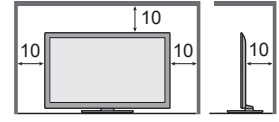

Ventilation should not be impeded by covering the ventilation openings with items such as newspapers, tablecloths and curtains.
 * Whether you are using a pedestal or not, always ensure the vents at the bottom of the TV are not blocked and there is sufficient space to enable adequate ventilation.

Moving the TV

Caution

Before moving the TV, disconnect all cables.
 * Move the TV with at least two people. Support as shown to avoid injury by the TV tipping or falling.

When not in use for a long time

Caution

This TV will still consume some power even in the Off mode, as long as the mains plug is still connected to a live socket outlet.
 * Remove the mains plug from the wall socket when the TV is not in use for a prolonged period of time.

Use conditions

Caution

* This appliance is intended for use in tropical climates.

Battery for the Remote Control

Caution

* Incorrect installation may cause battery leakage, corrosion and explosion.
 * Replace only with the same or equivalent type.
 * Do not mix old and new batteries.
 * Do not mix different battery types (such as alkaline and manganese batteries).
 * Do not use rechargeable batteries (Ni-Cd, etc.).
 * Do not burn or break up batteries.
 * Do not expose batteries to excessive heat such as sunshine, fire or the like.
 * Make sure you dispose of batteries correctly.

Setting Up the TV

Standard accessories

Accessories may not be placed all together. Take care not to throw them away unintentionally.

Remote Control

* NQ2AYB000823

Batteries (R6) x 2

* (p. 3)

Mains Lead * (p. 5)

* TH-L32B6G/K/X, TH-L32B68G/K, TH-L32B69K, TH-L39B6G/K/X, TH-L39B68K, TH-L39B69K, TH-L50B6G/K

* TH-L32B6M, TH-L39B6M, TH-L50B6M

Clamper

For 32" models only * (p. 6)

Pedestal

Assembly screws

A - 32" models: $\Phi 3 \times 4$ - 39" & 50" models: $(M5 \times 16) \times 4$

Bracket

B - 32" models: - 32" models: (M4 x 25) x 4 - 39" & 50" models: (M4 x 12) x 4

Base

- 32" models: - 39" & 50" models:

Inserting remote's batteries

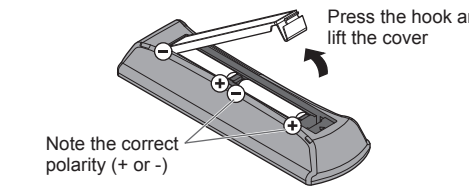

Attaching the pedestal

1 Assemble the pedestal

32" models

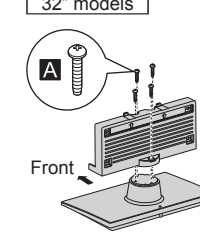

39" & 50" models

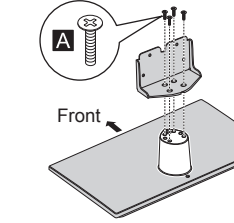

2 Attach the TV to the pedestal

32" models

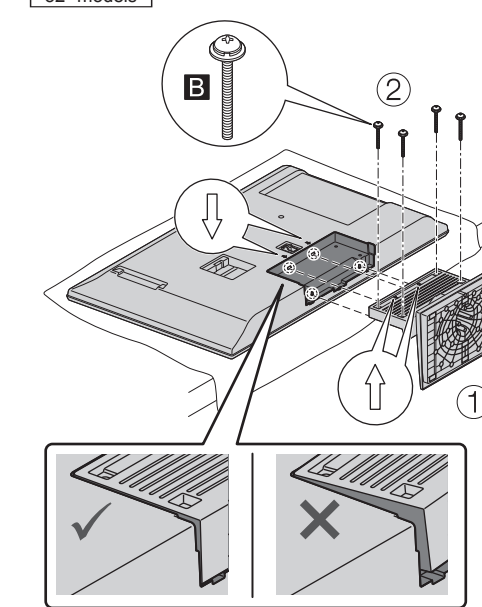

39" & 50" models

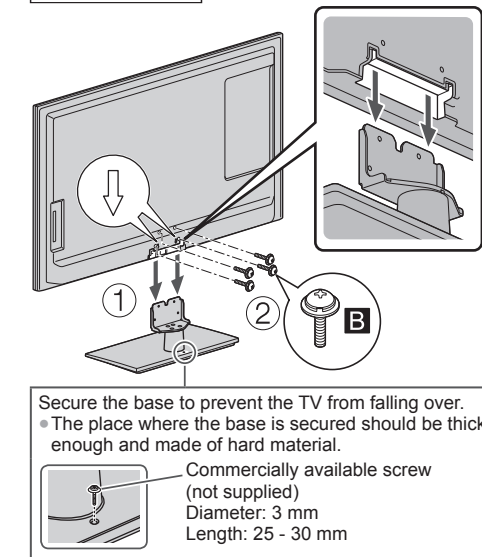

Removing the pedestal from the TV

Be sure to remove the pedestal in the following way when using the wall-hanging bracket or repacking the TV.

- 1 Remove the assembly screws B from the TV.
- 2 Pull out the pedestal from the TV.
- 3 Remove the assembly screws A from the bracket.

Optional accessories

Wall-hanging bracket (not supplied)
 Please contact your local Panasonic dealer to purchase the recommended optional accessories.

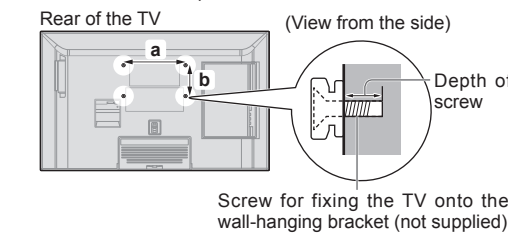

Holes for wall-hanging bracket installation

Models	a	b
TH-L32B6G/K/M/X TH-L32B68G/K TH-L32B69K	200 mm	100 mm
TH-L39B6G/K/M/X TH-L39B68K TH-L39B69K	200 mm	200 mm
TH-L50B6G/K/M	400 mm	400 mm

Screw specification

Models	Type	Depth of screw	
		Minimum	Maximum
TH-L32B6G/K/M/X TH-L32B68G/K TH-L32B69K	M4	10 mm	16 mm
TH-L39B6G/K/M/X TH-L39B68K TH-L39B69K	M6	12 mm	22 mm
TH-L50B6G/K/M	M6	16 mm	30 mm

Warning

* When optional accessories such as wall brackets etc. are used, always read and follow the manufacturer's installation and usage instructions.
 * Do not mount the unit directly below ceiling lights (such as spotlights or halogen lights) which typically give off high heat. Doing so may warp or damage plastic cabinet parts.
 * When installing wall brackets you must ensure the wall bracket is not electrically grounded to metal wall studs. Always ensure that there are no electrical cables, pipes etc. in the wall before you begin the wall bracket installation.
 * To prevent fall and injury, remove the TV from its fixed wall position when it is no longer in use.

Panasonic does not guarantee operation and performance of peripheral devices made by other manufacturers; and we disclaim any liability or damage arising from operation and/or performance from usage of such other maker's peripheral devices.

The recording and playback of content on this or any other device may require permission from the owner of the copyright or other such rights in that content.
 Panasonic has no authority to and does not grant you that permission and explicitly disclaims any right, ability or intention to obtain such permission on your behalf. It is your responsibility to ensure that your use of this or any other device complies with applicable copyright legislation in your country. Please refer to that legislation for more information on the relevant laws and regulations involved or contact the owner of the rights in the content you wish to record or playback.

Panasonic and its affiliates make no representations or warranties of any kind with respect to the USB devices and the performance of communication between the USB devices and the USB port of Panasonic products, and expressly disclaims any and all warranties, whether express or implied or otherwise, including without limitation any implied warranty of fitness for a particular purpose, any loss of data, and any implied warranties arising from course of dealing or course of performance of data communication between the USB devices and the USB port of Panasonic products.

This product is licensed under the AVC patent portfolio license for the personal and non-commercial use of a consumer to (i) encode video in compliance with the AVC Standard ("AVC Video") and/or (ii) decode AVC Video that was encoded by a consumer engaged in a personal and non-commercial activity and/or was obtained from a video provider licensed to provide AVC Video. No license is granted or shall be implied for any other use. Additional information may be obtained from MPEG LA, LLC.
 See <http://www.mpegla.com>.

Information on Disposal in other Countries outside the European Union

This symbol is only valid in the European Union. If you wish to discard this product, please contact your local authorities or dealer and ask for the correct method of disposal.

Customer's Record

The model number and serial number of this product may be found on its rear panel. You should note this serial number in the space provided below and retain this book, plus your purchase receipt, as a permanent record of your purchase to aid in identification in the event of theft or loss, and for Warranty Service purposes.

Model Number _____
 Serial Number _____

Connecting the TV

- * External equipment and cables shown are not supplied with this TV.
- * Ensure that the unit is disconnected from the mains socket before attaching or disconnecting any leads.
- * Check the type of terminals and cable plugs are correct when connecting.
- * When using an HDMI cable, use the fully wired one.
- * Keep the TV away from electronic equipment (video equipment, etc.) or equipment with an infrared sensor. Otherwise, distortion of image / sound may occur or operation of other equipment may be interfered.
- * Also read the manual of the equipment being connected.

Terminals

Rear of the TV

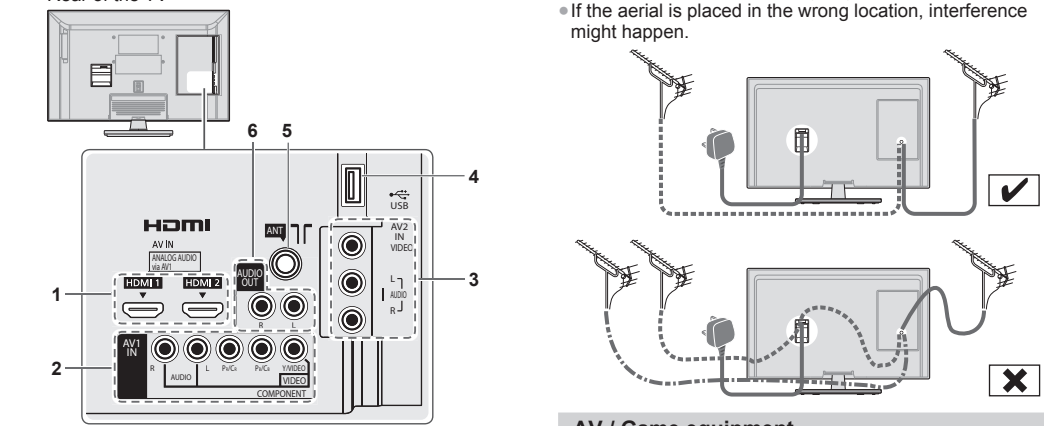

- 1 HDMI 1 - 2
- 2 AV1 IN
- 3 AV2 IN
- 4 USB port
- 5 Aerial terminal
- 6 AUDIO OUT

Connections

Aerial and mains lead

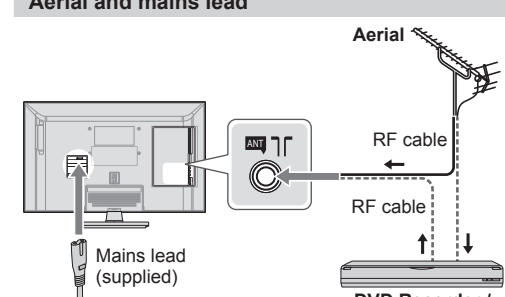

--- Alternative connection

- * Keep the space between the TV and RF cable to prevent distorted image.
- * Do not put the RF cable close to the mains lead to avoid noise.
- * Do not place the RF cable under the TV.
- * An aerial, correct cable (75 Ω coaxial) and correct terminating plug are required to obtain optimum quality picture and sound.
- * If a communal aerial system is used, you may require the correct connection cable and plug between the wall aerial socket and the TV.
- * Your local Television Service Centre or dealer may be able to assist you in obtaining the correct aerial system for your particular area and the accessories required.
- * Any matters regarding aerial installation, upgrading of existing systems or accessories required, and the costs incurred, are the responsibility of you, the customer.
- * If the aerial is placed in the wrong location, interference might happen.

AV / Game equipment

Using HDMI terminal

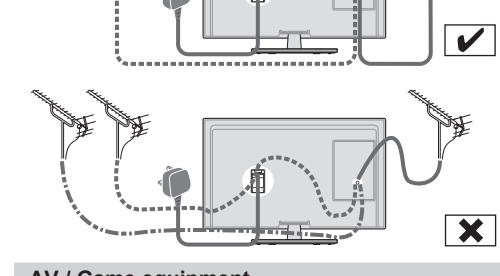

Using COMPONENT terminals

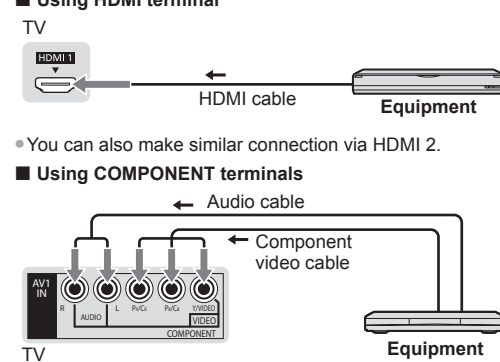

Using COMPOSITE terminals

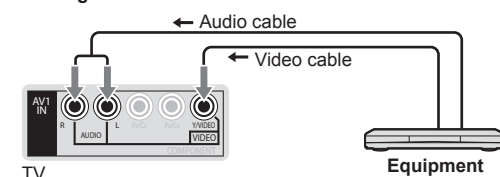

* You can also make similar connections via AV2 IN.

Set top box

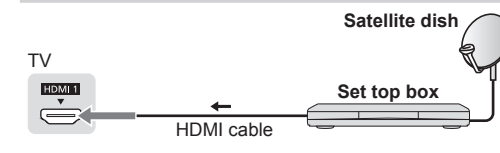

Speaker system

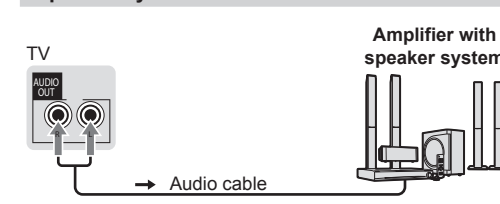

Using the clamper

For 32" models only

- * Do not bundle the RF cable and mains lead together (could cause distorted image).
- * Fix cables with clampers as necessary.
- * When using the optional accessory, follow the option's assembly manual to fix cables.



1 Attach the clamper

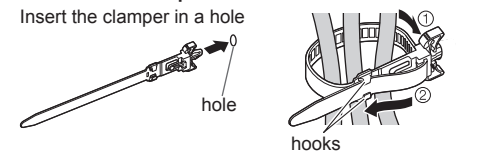

2 Bundle the cables

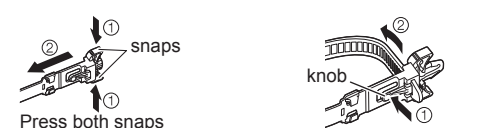

To remove from the TV



To loosen



Initial Setup

When you first turn on the TV, a series of steps will pop-up to guide you to setup your TV.
 * These steps are not necessary if the setup has been completed by your local dealer.

1 Plug the mains plug into the socket outlet, then switch on the TV

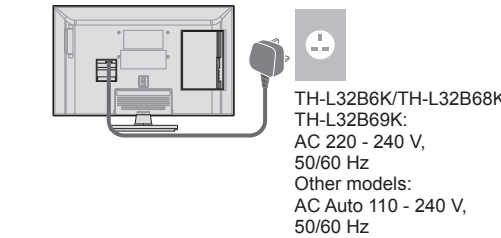

TH-L32B6K/TH-L32B68K/TH-L32B69K:
 AC 220 - 240 V, 50/60 Hz
 Other models:
 AC Auto 110 - 240 V, 50/60 Hz

2 Select your language



* When selecting [CATV/Other], press **OK**, and then select the Channel Plan from [Indian CATV], [South Africa], [American System], [American CATV] or [Japan].

3 Start Auto Tuning

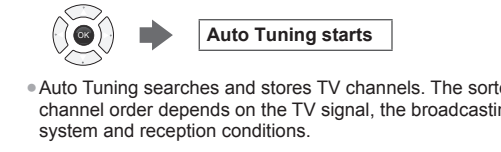

* Auto Tuning searches and stores TV channels. The sorted channel order depends on the TV signal, the broadcasting system and reception conditions.

4 Select [Home]

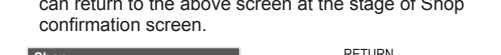

* [Shop] is for shop display. If you selected [Shop], you can return to the above screen at the stage of Shop confirmation screen.

* To change the viewing environment later on, you need to initialise all settings by accessing [Shipping Condition] (p. 11).

Setup is now complete and your TV is ready for viewing.

Operating the TV

Using the remote control

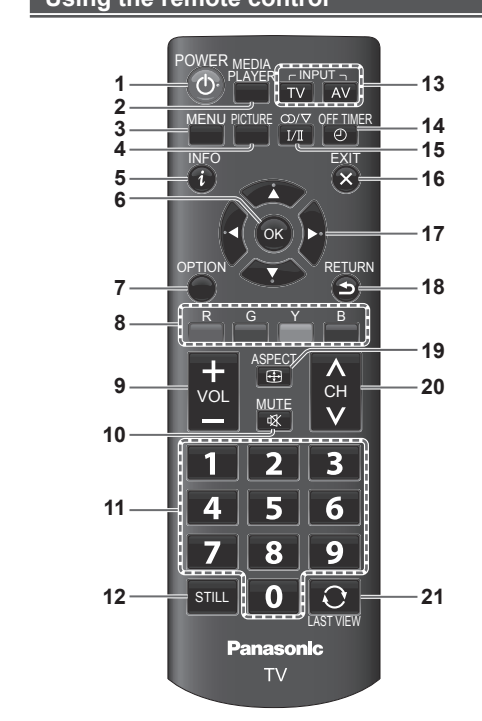

- 1 Switches the TV On / Standby
- 2 MEDIA PLAYER * (p. 8)
- 3 Displays [Main Menu] * (p. 10)
- 4 Selects picture mode * [Viewing Mode] (p. 10) * Press repeatedly to select.
- 5 Displays information banner
- 6 **OK**
 * Confirms selections.
 * Press after selecting channel positions to quickly change channel.
- 7 Displays [Option Menu]
 * Shortcuts to some setting menus for picture, sound, etc.
 * Follow the operation guide to select / change the settings.
- 8 **Coloured buttons**
 * Performs multiple operations which correspond to the operation guide displayed on the menu screen.
- 9 **Volume Up / Down**
- 10 **Sound Mute On / Off**
- 11 **Numeric buttons**
 * Changes channel.
 * When in Standby mode, switches TV On.
- 12 **Freezes / unfreezes picture**

- 13 **Input mode selection**
 * TV - switches to TV input mode
 * AV - displays [Input Selection] screen (p. 8) or press repeatedly to select the AV input mode
- 14 **OFF TIMER**
 * Press repeatedly to select the period after which the TV will turn to Standby mode automatically.
 [0] / [15] / [30] / [45] / [60] / [75] / [90] (minutes)
- 15 **Changes multiplex sound mode (if available)**
 Sound mode indicator:
 [] : STEREO I : MAIN I
 [] : MONO II : SUB II
- 16 **Exits to the TV viewing screen**
- 17 **Cursor buttons**
 * Makes selections or adjustments.
- 18 **Returns to the previous menu / page**
- 19 **ASPECT**
 * Displays the [Aspect Selection] screen. Follow the operation guide to select the mode.
 [16:9] / [14:9] / [Just] / [4:3] / [4:3 Full] / [Zoom1] / [Zoom2] / [Zoom3] * (p. 12)
 * You can also press the button repeatedly to select the mode.
- 20 **Channel Up / Down**
- 21 **Returns to the last viewed channel**

About operation guide

When operating the TV with the remote control, follow the operation guide available at the bottom of the screen to perform the operation you want.

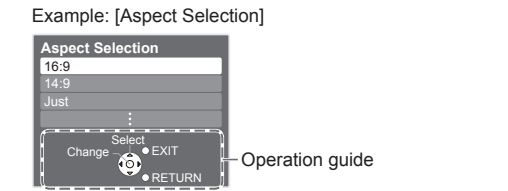

Referring to the operation guide:

* To select the mode

* To change to the selected mode

* To return to the previous menu

* To exit the menu

Using the TV controls

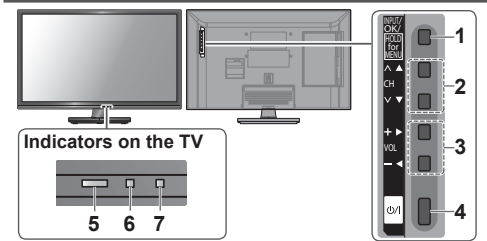

- Displays [Input Selection] screen**
 - On first press, the [Input Selection] screen for control panel is displayed. Pressing the button again will toggle cursor movement.
 - Displays [Main Menu] when press and hold for 3 seconds
 - Confirms selection (OK button) while in the menu system
- Channel Up / Down**
Cursor Up / Down
 - Makes selections or adjustments when in the menu system
- Volume Up / Down**
Cursor Left / Right
 - Makes selections or adjustments when in the menu system
- Switches TV On or Standby**
 - To completely turn off the TV, remove the mains plug from the wall socket.
- Remote control signal receiver**
- C.A.T.S. (Contrast Automatic Tracking System) sensor**
 - Senses brightness to adjust picture quality when [Eco Mode] in the Picture Menu is set to [On].
- Power LED**
 - Red: Standby
 - Green: On

Watching External Inputs

Connect the external equipment (p. 5 - 6), then select the input corresponds to the connected terminal.

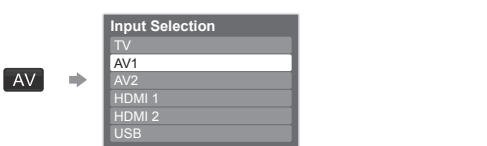

- Note**
- [USB]: Switches to Media Player ⤴ (p. 8)
 - * You can label or skip each input mode (except [USB]).
 - * "Input Labels" (p. 14)
- Skipped inputs will not be displayed when the AV button is pressed.

8

[Auto Tuning]

Scans and stores all channels automatically.

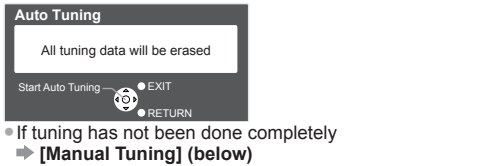

[Manual Tuning]

Scans and stores channels manually.

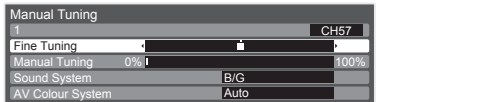

- Set [Sound System] and [AV Colour System].**
 - Normally set [AV Colour System] to [Auto].
- Select a channel position to store the channel.**
 - If a VCR is connected only with the RF cable, select channel position [0].
- Start tuning.**
 - Tuning stops when a channel is found.
- Press OK to store the channel or press the cursor button to continue tuning.**

[Fine Tuning]

Refines the tuning of a channel.

Additional Information

Auto power standby function

- The TV will automatically go into Standby mode in the following conditions:
- No signal is received and no operation is performed for 30 minutes in Analogue TV mode.
 - [Off Timer] is active in the Setup Menu.
 - No operation is performed for the period selected in [Auto Standby] (p. 11).

Input signal that can be displayed

Signal name	COMPONENT	HDMI
525 (480) / 60i, 60p	○	○
625 (576) / 50i, 50p	○	○
750 (720) / 60p, 50p	○	○
1,125 (1,080) / 60i, 50i	○	○
1,125 (1,080) / 60p, 50p, 24p	○	○

- Mark : Applicable input signal
- Signals other than above may not be displayed properly.
- The above signals are reformatted for optimal viewing on your display.

Supported file format in Media Player

- **Photo:**
 - JPEG (.jpg, .jpeg)
 - Supported image resolution: 8 × 8 to 30,719 × 17,279
 - DCF and EXIF standards
 - Sub-sampling: 4:4:4, 4:2:2, 4:2:0
 - Progressive JPEG is not supported.
- **Music:**
 - MP3 (.mp3) / AAC (.m4a)*1 / WMA (.wma)*1-2

12

Using the Media Player

Media Player allows you to enjoy photo, music or video recorded on a USB Flash Memory.

- The picture may not appear correctly on this TV depending on the digital camera used.
- Display may take some time when there are many files and folders in the USB Flash Memory.
- Partly degraded files might be displayed at a reduced resolution.
- The folder and file names may be different depending on the digital camera used.
- If a non-standard file is played, the TV might misoperate. To recover, switch the Mains Power Off, then On again.

1 Insert the USB Flash Memory

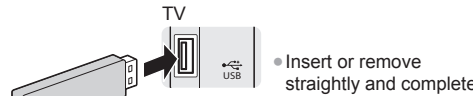

2 Start Media Player



[Photo]: Displays the thumbnail of all photos in the USB device.

[Music]: Displays the thumbnail of music folders in the USB device.

[Movie]: Displays the thumbnail of video titles in the USB device.

[Contents Select]

Switching between modes
When you are in the thumbnail view of any mode, you change to the other mode by returning to the [Contents Select] screen.

Photo mode



■ Video

AVI (.avi) / MKV (.mkv) / ASF (.asf, .wmv) / MP4 (.mp4) / FLV (.flv) / 3GPP (.3gp, .3g2) / TS (.ts) / PS (.vob, .vro) / RMVB*1

- * Copy-protected files cannot be played back.
- * WMA Pro and WMA Lossless are not supported.
- * RMVB files are only supported by TH-L32B6K/TH-L32B68K/TH-L39B6K/TH-L39B68K/TH-L50B6K/TH-L50B6M models.

Note

- Even if these conditions are fulfilled, some files may not be played back depending on how they are encoded.
- Do not use two-byte characters or other special codes for data.
- The device may become unusable with this TV if the file or folder names are changed.

9

Follow the operation guide to perform available operations in Photo mode.

To display / hide the operation guide during [Single View] and [Slideshow] → INFO

[View]

Enters Single view mode to view photo one at a time

[Slideshow]

Lets you view all photos in the slideshow mode

[View Select]

Lets you toggle between thumbnail view and folder view.

[Option Menu]

Contains [Slideshow Settings] menus to set up slideshow.

■ Transition Effect

Effect for photo switching during slideshow
[None] / [Dissolve] / [Wipe right] / [Wipe left] / [Wipe up] / [Wipe down] / [Box in] / [Box out] / [Random]

■ Screen Mode

Screen mode for Single view and Slideshow
[Normal] / [Zoom]

- Depending on the photo size, it may not be fully enlarged to fill the screen, e.g. portrait style picture.

■ Interval

Slideshow interval [5] / [10] / [15] / [30] / [60] / [90] / [120] (seconds)

■ Repeat

Slideshow repeat [Off] / [On]

■ Back Ground Music

Background music during photo viewing
[Off] / [Type1] / [Type2] / [Type3]

■ Note

- * Picture quality may suffer depending on the slideshow settings.
- * Picture setting may not work depending on the slideshow settings.

Music mode



While in thumbnail view:

■ Repeat

Playback repeat within the title [Off] / [On]

■ Subtitle

Selects the subtitle (if available)
[Off] / [Subtitle1] / [Subtitle2] (...)

■ Aspect Change

[16:9] / [14:9] / [Just] / [4:3] / [4:3 Full] / [Zoom1] / [Zoom2] / [Zoom3]

■ Note

- You can also change the aspect using the ASPECT button.

To playback all music in the selected folder



10

To playback the selected file only

Select the folder → Select the file → Play

[Option Menu]

Contains [Music Setup] menu to set up play mode.

■ Repeat

[Folder]: Playback repeat within the selected folder
[One]: Playback repeat on the selected one file
[Off]: Playback repeat off

Movie mode

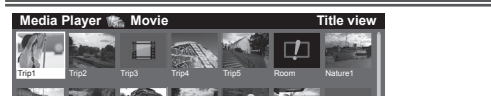

Operation guide

■ Error display

Follow the operation guide to perform available operations in Movie mode.

To display / hide the operation guide and information banner during playback → INFO

To playback all movies in the selected title folder



11

To playback the selected file in the title folder

Select the title → Select the file → Play



12

[Option Menu]

Contains [Video Setup] menus to set up Movie mode.

■ Repeat

Playback repeat within the title [Off] / [On]

■ Multi Audio

Selects the sound tracks (if available)

■ Subtitle

Selects the subtitle (if available)
[Off] / [Subtitle1] / [Subtitle2] (...)

■ Aspect Change

[16:9] / [14:9] / [Just] / [4:3] / [4:3 Full] / [Zoom1] / [Zoom2] / [Zoom3]

■ Note

- You can also change the aspect using the ASPECT button.

■ Note

- * For NTSC signal, Component or HDMI input

13

Using the Menu Functions

1 Display the menu



2 Select the menu



Viewing Mode Dynamic

Background 100

Contrast 50

Brightness 0

Contrast 50

Change the setting option

Viewing Mode Dynamic

Adjust the intensity bar

Contrast 50

Access the submenu

Child Lock Access

Note

- * A different menu will be displayed in the mode of Media Player (p. 8 - 9).
- * Only available items can be selected.

Picture Menu

Sets preset picture mode for each input.

[Dynamic]: Improves contrast and sharpness.

[Normal]: For viewing in a normal lighting condition.

[Cinema]: Improves the performance of contrast, black and colour reproduction.

[True Cinema]: Reproduces the original image quality precisely without any revision.

[Game]: For viewing when playing games

- Not valid on TV mode.

- To display a continuous record of time spent using Game mode → [Playing Time Display] (p. 11).

In each Viewing Mode, [Contrast], [Brightness], [Colour], [Sharpness], [Tint], [Eco Mode], [Eco Mode], [P-NR] and [3D-COMB] can be adjusted and stored for each input.

[Backlight] / [Contrast] / [Brightness] / [Colour] / [Sharpness]

Adjusts the levels of these options to your preference.

[Tint]

Adjusts the picture hue.

* For NTSC signal, Component or HDMI input

14

[Colour Balance]

Sets the overall colour tone of the picture.

[Cool] / [Normal] / [Warm]

* Not valid when [Viewing Mode] is set to [True Cinema]

[Channel Colour Set]

Adjusts the suitable colour density from 3 levels for each channel.

* Select the channel to adjust and set this function.

[Eco Mode]

Automatic Brightness Control function

Adjusts picture settings automatically depending on ambient lighting conditions [Off] / [On]

[P-NR] (Picture Noise Reduction)

Reduces unwanted picture noise and flicker noise in the contoured parts of a picture [Off] / [Min] / [Mid] / [Max]

[3D-COMB]

Makes still or slow moving pictures more vivid [Off] / [On]

* Occasionally, while viewing still or slow moving pictures, colour patterning may be seen. Set to [On] to display sharper and more accurate colours.

* For PAL or NTSC signal reception only.

* Not valid on Component, HDMI and Media Player.

[Reset to Defaults]

Press OK to reset the present picture [Viewing Mode] of the selected input to the default settings.

Sound Menu

[Mode]

Sets preset sound mode. The selected mode affects all input signals.

[Music]*: Improves sound quality for watching music videos, etc.

[Speech]*: Improves sound quality for watching news, drama, etc.

[User]: Adjusts the sounds manually by using the equaliser

- For the User mode, [Equaliser] will appear on the Sound Menu instead of [Bass] and [Treble]. Select [Equaliser] and adjust the frequency → (below).

* In Music and Speech modes, you can adjust [Bass] and [Treble] settings, and those settings will be stored for each mode.

[Bass] / [Treble]

Adjusts the effect to your preference.

[Equaliser]

Select the frequency and change the frequency level by using the cursor buttons.

* This function is available when [Mode] is set to [User].

* To enhance the bass sound, raise the level of the lower frequency. To enhance the treble sound, raise the level of the higher frequency.

* To reset the levels of each frequency to the default settings, select [Reset to Defaults] by using the cursor button, and then press the OK button.

[Balance]

Adjusts volume level of right and left speakers

[Surround]

Surround sound settings [Off] / [On]

[Auto Gain Control]

Automatically regulates large sound level differences between channels and inputs [Off] / [On]

[Volume Correction]

Adjusts the volume of individual channel or input mode

15

[Speaker Distance to Wall]

Compensates for the low frequency sound due to the distance between the speakers and the wall

[Over 30cm] / [Up to 30cm]

* If the back space between the TV and wall is over 30 cm, [Over 30cm] is recommended.

* If the back space between the TV and wall is within 30 cm, [Up to 30cm] is recommended.

[MPX]

Selects multiplex sound mode (if available)

[Stereo]: Use this normally

[Mono]: When stereo signal cannot be received

[M1] / [M2]: Available while mono signal is transmitted

[HDMI/2 Input]

Selects to fit the input signal (p. 12)

[Digital]: When sound is carried via the HDMI cable connection

[Analogue]: When sound is not carried via the HDMI-DVI adaptor cable connection

* For HDMI input

[Reset to Defaults]

Press OK to reset the present settings of [Mode], [Balance] and [Surround] to the default.

Setup Menu

[Off Timer]

Sets the time until the TV automatically goes to Standby mode [Off] / [15] / [30] / [45] / [60] / [75] / [90] (minutes)

[Child Lock]

Locks channels / AV input modes

Enter the PIN number (4 digits) to access.

First setting:
On the [Child Lock-PIN Entry] screen, enter your preferred number twice to create the PIN.

[Change PIN]

Lets you change your PIN number.

- Enter a new PIN number twice.

- Performing [Shipping Condition] erases the PIN number and all settings.

[Child Lock List]

Displays the Child Lock List.

- From the list, selects the channel / input to be locked.

[Tuning Menu]

→ (p. 11)

[OSD Language]

Changes language for on-screen displays → (p. 6)

[Display Settings]

Accesses the input labels list to select the label of each input mode or set to skip unconnected one for easier identification and selection in [Input Selection] (p. 8) or banner