

Panasonic®

Operating Instructions Compact Stereo System

Model No. SC-HC28DB
SC-HC18

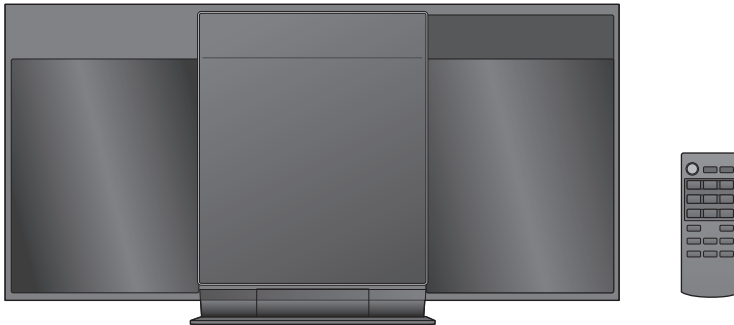

Thank you for purchasing this product.
Please read these instructions carefully before using this product,
and save this manual for future use.
Model number suffix "EB" denotes UK model.

EB

RQT9731-1B



Caution for AC Mains Lead

(For the AC mains plug of three pins)

For your safety, please read the following text carefully.

This appliance is supplied with a moulded three pin mains plug for your safety and convenience.

A 5-ampere fuse is fitted in this plug.

Should the fuse need to be replaced please ensure that the replacement fuse has a rating of 5-ampere and that it is approved by ASTA or BSI to BS1362. Check for the ASTA mark  or the BSI mark  on the body of the fuse.

If the plug contains a removable fuse cover you must ensure that it is refitted when the fuse is replaced.

If you lose the fuse cover the plug must not be used until a replacement cover is obtained.

A replacement fuse cover can be purchased from your local dealer.

Before use

Remove the connector cover.

How to replace the fuse

The location of the fuse differ according to the type of AC mains plug (figures A and B). Confirm the AC mains plug fitted and follow the instructions below. Illustrations may differ from actual AC mains plug.

1. Open the fuse cover with a screwdriver.

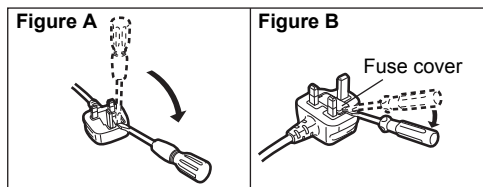

2. Replace the fuse and close or attach the fuse cover.

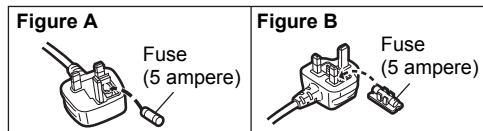

Safety precautions

WARNING

Unit

- To reduce the risk of fire, electric shock or product damage,
 - Do not expose this unit to rain, moisture, dripping or splashing.
 - Do not place objects filled with liquids, such as vases, on this unit.
 - Use only the recommended accessories.
 - Do not remove covers.
 - Do not repair this unit by yourself. Refer servicing to qualified service personnel.
 - Do not let metal objects fall inside this unit.
 - Do not place heavy items on this unit.

AC mains lead

- To reduce the risk of fire, electric shock or product damage,
 - Ensure that the power supply voltage corresponds to the voltage printed on this unit.
 - Insert the mains plug fully into the socket outlet.
 - Do not pull, bend, or place heavy items on the lead.
 - Do not handle the plug with wet hands.
 - Hold onto the mains plug body when disconnecting the plug.
 - Do not use a damaged mains plug or socket outlet.
- The mains plug is the disconnecting device. Install this unit so that the mains plug can be unplugged from the socket outlet immediately.

Button-type battery (Lithium battery)

- Risk of fire, explosion and burns. Do not recharge, disassemble, heat above **60 °C** or incinerate.
- Keep the Button-Type battery out of the reach of children. Never put Button-Type battery in mouth. If swallowed call your doctor.

CAUTION

Unit

- This unit utilizes a laser. Use of controls or adjustments or performance of procedures other than those specified herein may result in hazardous radiation exposure.
- Do not place sources of naked flames, such as lighted candles, on this unit.
- This unit may receive radio interference caused by mobile telephones during use. If such interference occurs, please increase separation between this unit and the mobile telephone.
- This unit is intended for use in moderate climates.

Placement

- Place this unit on an even surface.
- To reduce the risk of fire, electric shock or product damage,
 - Do not install or place this unit in a bookcase, built-in cabinet or in another confined space. Ensure this unit is well ventilated.
 - Do not obstruct this unit's ventilation openings with newspapers, tablecloths, curtains, and similar items.
 - Do not expose this unit to direct sunlight, high temperatures, high humidity, and excessive vibration.

Button-type battery (Lithium battery)

- Danger of explosion if battery is incorrectly replaced. Replace only with the type recommended by the manufacturer.
- Insert with poles aligned.
- Mishandling of batteries can cause electrolyte leakage and may cause a fire.
 - Remove the battery if you do not intend to use the remote control for a long period of time. Store in a cool, dark place.
 - Do not heat or expose to flame.
 - Do not leave the battery(ies) in a car exposed to direct sunlight for a long period of time with doors and windows closed.
- When disposing the batteries, please contact your local authorities or dealer and ask for the correct method of disposal.

Product Identification Marking is located on the bottom of the unit.

Sales and Support Information

Customer Communications Centre

- For customers within the UK: 0844 844 3899
- For customers within Ireland: 01 289 8333
- Monday–Friday 9:00 am - 5:00 pm (Excluding public holidays).
- For further support on your product, please visit our website: www.panasonic.co.uk

Direct Sales at Panasonic UK

- Order accessory and consumable items for your product with ease and confidence by phoning our Customer Communications Centre Monday–Friday 9:00 am - 5:00 pm (Excluding public holidays).
- Or go on line through our Internet Accessory ordering application at www.pas-europe.com.
- Most major credit and debit cards accepted.
- All enquiries transactions and distribution facilities are provided directly by Panasonic UK.
- It couldn't be simpler!
- Also available through our Internet is direct shopping for a wide range of finished products. Take a browse on our website for further details.

Table of contents

Caution for AC Mains Lead	2
Safety precautions.....	2
Accessories.....	3
Control reference guide	4
Connections	5
Unit and media care.....	5
Inserting media	6
Media playback operations.....	7
SC-HC28DB Listening to DAB/DAB+.....	8
Listening to FM radio	10
Sound adjustment	11
Clock and Timer.....	11
Others	12
Troubleshooting.....	12
Playable media	14
Licenses	15
Specifications	16
SC-HC28DB Attaching the support pad to this unit.....	19

About descriptions in these operating instructions

- Pages to be referred to are indicated as "→ ○○".
- These operating instructions are applicable to models SC-HC28DB and SC-HC18. Unless otherwise indicated, illustrations in these operating instructions are of SC-HC28DB.
 - SC-HC28DB** : indicates features applicable to SC-HC28DB only.
 - SC-HC18** : indicates features applicable to SC-HC18 only.

Accessories

Check the supplied accessories before using this unit.

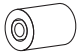
- | | |
|---|---|
| <input type="checkbox"/> 1 Remote control (with a battery)
SC-HC28DB
(N2QAYC000079) | <input type="checkbox"/> 1 AC mains lead (K2CT2YY00097) |
| <input type="checkbox"/> SC-HC18
(N2QAYC000080) | <input type="checkbox"/> SC-HC18
1 FM indoor antenna (RSAX0002) |
| <input type="checkbox"/> SC-HC28DB
1 DAB antenna (N1EADY000001) |  |
| <input type="checkbox"/> SC-HC28DB
1 Pad sheet (→ 19) (RFA3465) | <input type="checkbox"/> SC-HC18
1 Antenna plug adaptor (K1YZ02000013) |
| |  |



- Do not use AC mains lead with other equipment.
- Product numbers provided in these operating instructions are correct as of December 2012. These may be subject to change.

Control reference guide

Unless otherwise indicated, operations are described using the remote control.

- 1 **Standby/on switch (⏻/⏻)**
Press to switch the unit from on to standby mode or vice versa.
In standby mode, the unit is still consuming a small amount of power.
- 2 Select the audio source
- 3 Basic playback control buttons
- 4 Enter setup menu
- 5 Change displayed information
SC-HC28DB Enter the iPod/iPhone menu
- 6 Set the sleep timer
- 7 Change the brightness of the display panel
- 8 Adjust the volume (0 (min) to 50 (max))
- 9 Mute the sound
Mutes the sound. Press again to cancel. "MUTE" is also cancelled when the volume is adjusted or the unit is turned off.
- 10 Enter playback menu
- 11 Enter sound menu
- 12 Selection/OK
- 13 **SC-HC28DB**
"IPOD_PORT" for iPod/iPhone/iPad (→ 6)
USB port (→ 6)
SC-HC18 USB port (→ 6)
- 14 Open or close the sliding door
- 15 Sliding door
- 16 Display
- 17 Remote control signal sensor
Distance: Within approx. 7 m directly in front.
• To avoid interference, please do not put any objects in front of signal sensor.
- 18 **SC-HC28DB** "IPOD_DOCK" for iPod/iPhone/iPad mini (→ 6)

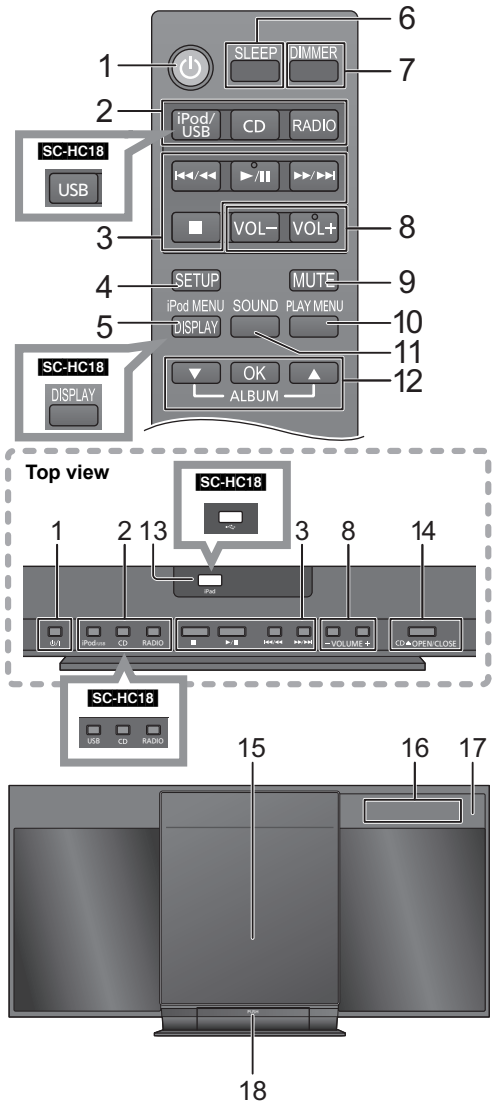

■ Before using for the first time

Remove the insulation sheet **A**.



- Set the button-type battery with its (+) mark facing upward.
- Keep the button-type battery out of reach of children to prevent swallowing.

■ To replace a button-type battery

Battery type: CR2025 (Lithium battery)

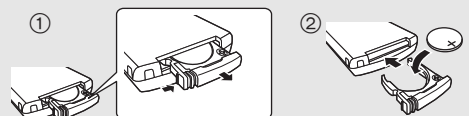

Connections

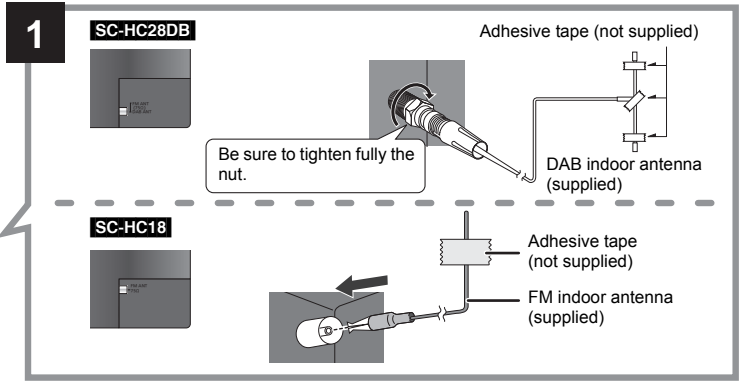

2 Connect the AC mains lead after all other connections are completed.

This unit consumes a small amount of AC power (→ 16) even when turned off.

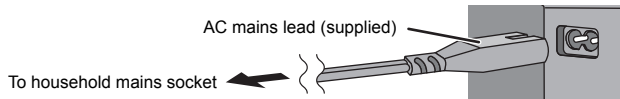

- In the interest of power conservation, if you will not be using this unit for an extended period of time, unplug it from the household mains socket.

READ THE CAUTION FOR THE AC MAINS LEAD ON PAGE 2 BEFORE CONNECTION.



- These speakers do not have magnetic shielding. Do not place them near a television, personal computer or other devices easily influenced by magnetism.
- Tape the DAB/FM antenna to a wall or column in a position with the least amount of interference. (Use an DAB/FM outdoor antenna if radio reception is poor.)

Unit and media care

Pull out the AC mains lead from the outlet before maintenance.

■ Clean this unit with a soft, dry cloth

- When dirt is heavy, wring a cloth moistened in water tightly to wipe the dirt, and then wipe it with a dry cloth.
- Never use alcohol, paint thinner or benzene to clean this unit.
- Before using chemically treated cloth, carefully read the instructions that came with the cloth.

■ Maintenance of the lens

- Clean the lens regularly to prevent malfunctions. Use a blower to remove dust and a cotton swab if it is extremely dirty.
- You cannot use a CD type lens cleaner.
- Do not leave the sliding door open for prolonged periods of time. This will cause the lens to get dirty.
- Be careful not to touch the lens with your fingers.

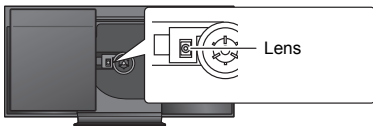

■ Clean discs

DO



DO NOT



Wipe with a damp cloth and then wipe dry.

■ Disc handling precautions

- Handle discs by the edges to avoid inadvertent scratches or fingerprints on the disc.
- Do not attach labels or stickers to discs.
- Do not use record cleaning sprays, benzene, thinner, static electricity prevention liquids or any other solvent.
- Do not use the following discs:
 - Discs with exposed adhesive from removed stickers or labels (rented discs etc.).
 - Discs that are badly warped or cracked.
 - Irregularly shaped discs, such as heart shapes.

■ To dispose or transfer this unit

The unit may keep the user settings information in the unit. If you discard this unit either by disposal or transfer, then follow the procedure to return all the settings to the factory presets to delete the user settings. (→ 12, "To return all settings to the factory preset")

Inserting media

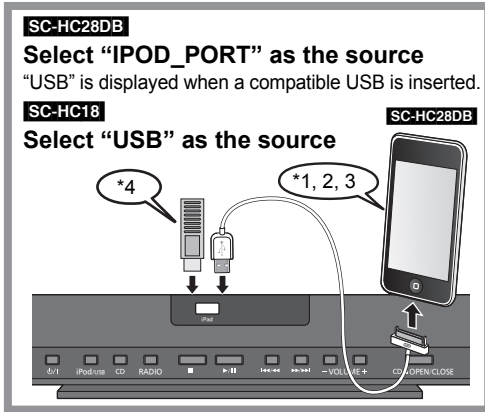

SC-HC28DB

Select "IPOD_PORT" as the source

"USB" is displayed when a compatible USB is inserted.

SC-HC18

Select "USB" as the source

SC-HC28DB

SC-HC28DB: Attach the pad before using this unit.
(→ 19)

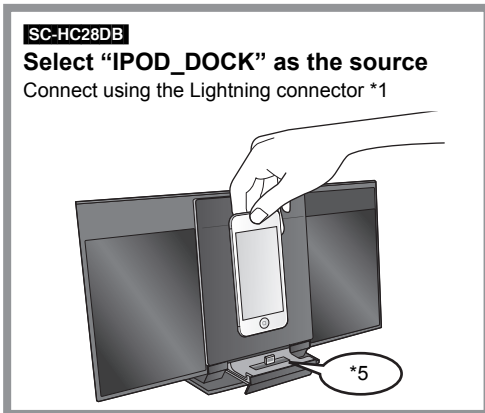

SC-HC28DB

Select "IPOD_DOCK" as the source

Connect using the Lightning connector *1

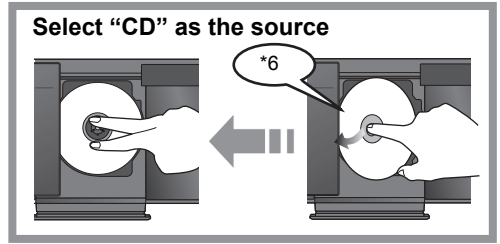

Select "CD" as the source

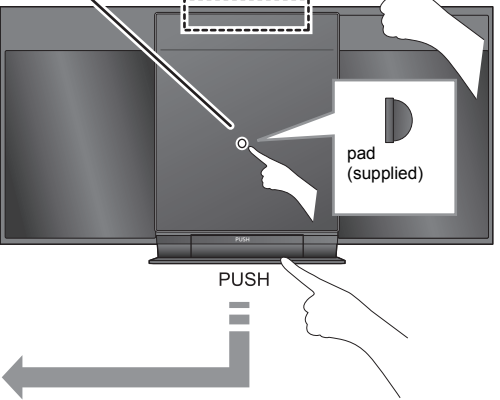

- *1: Refer to "Playable media" for compatible models. (→ 14)
 - Do not connect an iPad (4th generation) to the "IPOD_DOCK" connection. This unit might fall over. Use the "IPOD_PORT" connection.
- *2: When using the "IPOD_PORT" connection, do not connect the following models to this unit:
 - iPod classic, iPod [4th (colour display), and 5th (video) generation]
 - Unexpected behaviour may occur.
- *3: Connect using the dedicated USB cable (not supplied).
- *4: Insert the USB device directly. Do not use any USB extension cable.
- *5: When using the "IPOD_DOCK" connection:
 - Be sure to remove the iPod/iPhone/iPad mini from its case.
 - Make sure that the iPod/iPhone/iPad mini is fully inserted.
 - If the iPod/iPhone/iPad mini is pushed to the left or right, make sure to check that it is still fully inserted.
 - Make sure to hold the dock when removing the iPod/iPhone/iPad mini.
 - Make sure to close the dock properly after using it.
 - If not,
 - The sliding door will not open.
 - The standby power consumption will increase.
- *6: Make sure to tilt the disc so as not to touch the sliding door.

- Do not open the sliding door manually.
- Make sure that the unit does not fall when inserting or removing media.
- When moving this unit, be sure to remove all media and turn this unit to standby mode.
- Before removing the USB device, select a source other than "USB".

SC-HC28DB

Charging an iPod/iPhone/iPad

- Charging starts when an iPod*2/iPhone/iPad is connected to this unit.
- During standby mode, charging will not start from the "IPOD_PORT" connection, however it will start as usual from the "IPOD_DOCK" connection.
 - To charge from the "IPOD_PORT" connection, start the charging before turning this unit to standby mode.



- Check the iPod/iPhone/iPad to see if the battery is fully charged. (Once fully recharged, additional recharging will not occur.)
- If this unit is switched to standby mode "IPOD CHARGING" is shown on the unit's display.

Media playback operations

The following marks indicate the availability of the feature.

- CD**: CD audio in CD-DA format and a CD that contains MP3 files (→ 14)
- iPod**: Compatible iPod/iPhone/iPad (→ 14)
- USB**: USB devices containing MP3 files (→ 14)

iPod is only available for **SC-HC28DB**.

Preparation

- Turn the unit on.
- Insert the media. (→ 6)
- Press [CD], [iPod/USB] (**SC-HC28DB**) or [USB] (**SC-HC18**) to select the audio source.



- When using iPod/iPhone/iPad, the operation may vary among those models.

Basic play (CD, iPod, USB)

Play	Press [▶/].
Stop	Press [■]. • USB : The position is memorised and "RESUME" is displayed.
Pause	Press [▶/]. Press again to restart play.
Skip	Press [◀◀/▶▶] or [▶▶/▶▶] to skip track. CD, USB Press [▲] or [▼] to skip the MP3 album.
Search	During play or pause Press and hold [◀◀/▶▶] or [▶▶/▶▶]. • iPod : Backwards search is only within the current track.

CD, USB To display information

Press [DISPLAY] repeatedly.



- Maximum number of displayable characters: approx. 30
- This unit supports ver. 1.0, 1.1 and 2.3 ID3 tags. Text data that is not supported will not be displayed or shown differently.
- Album and track indication for MP3 files.



"A _ _ _": MP3 album number.

"T _ _ _": MP3 track number.

- " _ _ _" stands for the album or track number.

"■": This indication is also used to refer to an album.

"▶": This indication is also used to refer to a track.

iPod To navigate through the iPod/iPhone menu

Open the Music App to use this feature with iPod touch/iPhone.

- [▲, ▼]: To navigate menu items.
- [OK]: To go to the next menu.
- [iPod MENU]: To return to the previous menu.



- Depending on the model (e.g., iPod nano 7th generation, etc.), it may be necessary to select the album, artist, etc. on the iPod/iPhone.

Playback modes (CD, USB)

Select the playback mode.

- 1 Press [PLAY MENU] to select "PLAYMODE" or "REPEAT".
- 2 Press [▲, ▼] to select the setting and then press [OK].

PLAYMODE

OFF PLAYMODE	Select to cancel the play mode setting.
1-TRACK	Only plays the selected track. • "1", "▶" is displayed. (Skip to the desired track.)
1-ALBUM	Only plays the selected MP3 album. • "1", "■" is displayed.
RANDOM	Plays the contents randomly. • "RND" is displayed.
1-ALBUM RANDOM	Plays the tracks in the selected MP3 album randomly. • Press [▲] or [▼] to select the MP3 album. • "1", "■", "RND" is displayed.

REPEAT

ON REPEAT	Turn on repeat mode. • "↺" is displayed.
OFF REPEAT	Turn off repeat mode.



- When using iPod/iPhone/iPad, use the setting on the iPod/iPhone/iPad.
- During random play, you cannot skip to the previous track.
- The mode is cancelled when you open the sliding door.

Listening to DAB/DAB+

Preparation

- Make sure that the DAB antenna is connected. (→ 5)
- Turn the unit on.

Memorising stations

To listen to DAB/DAB+ broadcasts, the available stations need to be memorised in this unit.

- This unit will automatically start the “DAB AUTO SCAN” and memorise the stations that are available in your region if the memory is empty.

Press [RADIO] to select “DAB/DAB+”.



- “SCAN FAILED” is displayed when the auto scan is unsuccessful. Locate the position with the best reception (→ 9, “To verify or improve the signal reception quality”) and then re-scan DAB/DAB+ stations.

To re-scan DAB/DAB+ stations

When new stations are added or when the antenna has been moved, reperform the auto scan.

- 1 Press [PLAY MENU] to select “AUTOSCAN” and then press [OK].
- 2 While “START ?” is flashing, Press [OK].



- When updating the memory with the auto scan, preset stations will be erased. Preset them again (→ right).

Listening to the memorised stations

Preparation*1

- ① Press [RADIO] to select “DAB/DAB+”.
- ② Press [PLAY MENU] repeatedly to select “TUNEMODE”.
- ③ Press [▲, ▼] to select “STATION” and then press [OK].

- 1 Press [RADIO] to select “DAB/DAB+”.
- 2 Press [◀◀/▶▶] or [▶▶/▶▶] to select the station.

Presetting DAB/DAB+ stations

You can preset up to 20 DAB/DAB+ stations.

Preparation

- Press [RADIO] repeatedly to select “DAB/DAB+”.

- 1 While listening to a DAB broadcast Press [OK].
- 2 Press [▲, ▼] to select the desired preset channel number and then press [OK].



- You cannot preset stations when the station is not broadcasting or when the secondary service is selected.
- The station occupying a channel is erased if another station is preset in that channel.

Listening to preset DAB/DAB+ stations

Preparation*1

- ① Press [RADIO] to select “DAB/DAB+”.
- ② Press [PLAY MENU] repeatedly to select “TUNEMODE”.
- ③ Press [▲, ▼] to select “PRESET” and then press [OK].

- 1 Press [RADIO] to select “DAB/DAB+”.
- 2 Press [◀◀/▶▶] or [▶▶/▶▶] to select the station.



- To select by preset, make sure that stations have already been preset manually.
- To add additional preset stations, select the station using the method mentioned in “Listening to the memorised stations” (→ left).

Listening to the secondary service

Some DAB/DAB+ stations provide a secondary service as well as the primary service. If the station you are listening to is providing secondary service, “” will be displayed.

- 1 While “” is displayed. Press [PLAY MENU] repeatedly to select “DAB SECONDARY”.
- 2 Press [▲, ▼] to select the secondary service and press [OK].



- The setting will go back to primary service when changes are made (e.g. the station is changed).

*1: The “TUNEMODE” setting is memorised until it is changed.

Display

Press [DISPLAY] to change the display.

The information will scroll through the display. Each time you press the button:

Dynamic label:	Information about the broadcast
PTY display:	Programme type
Ensemble label:	The name of the ensemble
Frequency display:	The frequency block and frequency is displayed.
Time display:	Current time

Automatic clock adjustment

If the DAB broadcast includes time information, this unit's clock will be automatically updated.

- 1 Press [PLAY MENU] repeatedly to select "AUTO CLOCK ADJ".
- 2 Press [▲, ▼] to select "ON ADJUST" and then press [OK].



- Select "OFF ADJUST" to turn the automatic clock adjustment function off.

To verify or improve the signal reception quality

To check the signal reception quality, at least 1 frequency block needs to be successfully memorised.

- If "SCAN FAILED" is displayed after "DAB/DAB+" is selected or after an auto scan, proceed to "Manually tuning 1 frequency block" (→ below)
- If stations have already been memorised to this unit, proceed to "Checking the DAB/DAB+ signal reception quality" (→ right)

Manually tuning 1 frequency block

Use this function to scan 1 frequency block after adjusting the position of the DAB antenna.

Preparation

Note down a frequency block that can be received in your region (e.g., 12B 225.648 MHz).

- 1 While "SCAN FAILED" is displayed. Adjust the position of the DAB antenna.
- 2 Press [PLAY MENU] repeatedly to select "MANUAL SCAN".
- 3 Press [▲, ▼] to select the frequency block that is receivable in your region and then press [OK].



- If broadcasting stations are memorised, proceed to "To re-scan DAB/DAB+ stations" to memorise stations on other frequency blocks. (→ 8)
- If "SCAN FAILED" is still displayed, repeat steps 1 to 3 until a station is memorised. If the situation does not improve, try using an outdoor DAB antenna or consult your dealer.

Checking the DAB/DAB+ signal reception quality

- 1 While listening to the DAB broadcast: Press [PLAY MENU] repeatedly to select "SIGNAL QUALITY" and then press [OK].

- The current frequency block is displayed and then the reception quality is indicated.

Reception quality
0 (poor) – 8 (excellent)



- 2 If the signal reception quality is poor, move the antenna to a position where the reception quality improves.
- 3 To continue checking the quality of other frequency blocks: Press [▲, ▼] again and select the desired frequency.
- 4 Press [OK] to exit.



- If the antenna has been adjusted, perform auto scanning and update the station memory. (→ 8)

Changing the Auto scan frequency range

Only the frequencies currently used in your region as of December 2012 on BAND III are Auto scanned ("LOCAL", factory setting).

Select "ALL BAND III" when you want to store stations on other frequencies to memory.

- 1 Press [PLAY MENU] repeatedly to select "SCANMODE".
 - 2 Press [▲, ▼] to select "ALL BAND III" or "LOCAL" and then press [OK].
- The "DAB AUTO SCAN" begins automatically.



- The DAB preset channels are erased when the "SCANMODE" is changed.
- If the play timer has been set and DAB/DAB+ is the music source, the timer switches off. (→ 11)

Listening to FM radio

You can preset up to 30 channels.

Preparation

- Make sure that the antenna is connected. (→ 5)
- Turn the unit on.
- Press [RADIO] to select "FM".



- A station previously stored is overwritten when another station is stored in the same channel preset.

Presetting stations automatically

- 1 Press [PLAY MENU] to select "A.PRESET".
- 2 Press [▲, ▼] to select "LOWEST" or "CURRENT" and then press [OK].

LOWEST:

To begin auto preset with the lowest frequency (FM 87.50).

CURRENT:

To begin auto preset with the current frequency.*
* To change the frequency, refer to "Manual tuning and presetting".

The tuner starts to preset all the stations it can receive into the channels in ascending order.

Listening to a preset channel

Preparation

- ① Press [PLAY MENU] repeatedly to select "TUNEMODE".
- ② Press [▲, ▼] to select "PRESET" and then press [OK].

Press [◀◀/◀◀] or [▶▶/▶▶] to select the channel.

Manual tuning and presetting

Select a radio broadcast.

- 1 Press [PLAY MENU] repeatedly to select "TUNEMODE".
- 2 Press [▲, ▼] to select "MANUAL" and then press [OK].
- 3 Press [◀◀/◀◀] or [▶▶/▶▶] to tune to the required station.
 - To start automatic tuning, press and hold [◀◀/◀◀], [▶▶/▶▶] until the frequency starts scrolling. Tuning stops when a station is found.

To preset the channel

- 4 While listening to the radio broadcast Press [OK].
- 5 Press [▲, ▼] to select the channel and then press [OK].

To improve FM sound quality

- 1 While receiving FM broadcasts, press [PLAY MENU] repeatedly to select "FM MODE".
 - 2 Press [▲, ▼] to select "MONO" and then press [OK].
- This setting can be preset and memorised. To do so, continue to step 4 of "Manual tuning and presetting".



- Select "STEREO" in step 2 to return to stereo broadcasts.
- "MONO" is cancelled if the frequency is changed.
- If "MONO" is selected, regardless of the type of signal this unit is receiving, "FM MONO" is displayed. (→ below)

To display the current FM signal status

SC-HC28DB

While receiving FM broadcast, press [DISPLAY].

SC-HC18

While receiving FM broadcast, press [PLAY MENU] to display "FM STATUS" and then press [OK].

"FM ST": The FM signal is in stereo.

"FM": The FM signal is in monaural.

- "FM" is also displayed even if this unit is not tuned to a station.

SC-HC18 To display RDS text data

Press [DISPLAY] to display the text data.

- Each time you press the button:
 - "PS": Programme service
 - "PTY": Programme type
 - "FREQ": Frequency display



- "STEREO" is displayed when this unit tunes to a stereo broadcast.
- The unit can display the text data transmitted by the radio data system (RDS) available in some areas. (RDS displays may not be available if reception is poor.)

Sound adjustment

The following sound effects can be added to the audio output.

- 1 Press [SOUND] repeatedly to select the effect.
- 2 Press [▲, ▼] to select the setting and then press [OK].

Preset EQ (PRESET EQ)	“HEAVY” (heavy), “SOFT” (soft), “CLEAR” (clear), “VOCAL” (vocal) or “FLAT” (flat/off). <ul style="list-style-type: none">• The factory preset is “HEAVY”.
Bass (BASS) or Treble (TREBLE)	Adjust the level (−4 to +4).
Dynamic Bass (D.BASS)	“ON D.BASS” or “OFF D.BASS”. <ul style="list-style-type: none">• The factory preset is “ON D.BASS”.
Surround (SURROUND)	“ON SURROUND” or “OFF SURROUND”. <ul style="list-style-type: none">• The factory preset is “OFF SURROUND”.

- You may experience a reduction in sound quality when these effects are used with some sources. If this occurs, turn the sound effects off.

Clock and Timer

Setting the clock

This is a 24-hour clock.

- 1 Press [SETUP] to select “CLOCK”.
- 2 Press [▲, ▼] to set the time and then press [OK].



- To display the clock, press [SETUP] to select “CLOCK” and then press [OK] once. The time is displayed for 10 seconds. (During standby, press [DISPLAY] once.)
- The clock is reset when there is a power failure or when the AC mains lead is removed.
- Reset the clock regularly to maintain accuracy.

Play timer

You can set the timer so this unit turns on at a certain time every day.

Preparation

Set the clock (→ left).

Setting the timer

- 1 Press [SETUP] repeatedly to select “TIMER ADJ”.
- 2 Press [▲, ▼] to set the starting time (“ON TIME”) and then press [OK].
- 3 Press [▲, ▼] to set the finishing time (“OFF TIME”) and then press [OK].

Turn the timer on

- 1 Select the music source*1 and set the desired volume.
- 2 Press [SETUP] repeatedly to select “TIMER SET”.
- 3 Press [▲, ▼] to select “SET” and then press [OK].
 - “⊙” is displayed.
 - To turn the timer off, select “OFF”.
- 4 Press [⏻] to turn the unit off.



- To display the timer settings, press [SETUP] repeatedly to select “TIMER ADJ” and then press [OK] once. The music source and volume will also be displayed if the timer is turned on.
- During standby, if the timer is turned on, press [DISPLAY] twice to display the settings.
- This unit can be used as normal after the timer is set, however:
 - Turn the unit to standby mode before the timer start time.
 - Even if the audio source or the volume is changed, the timer will still use the audio source and volume that was set when the timer was turned on.

*1: “CD”, “USB”, “IPOD_PORT” (SC-HC28DB), “IPOD_DOCK” (SC-HC28DB), “DAB/DAB+” (SC-HC28DB) and “FM” can be set as the music source.

Sleep timer

The sleep timer can turn the unit off after a set time.

Press [SLEEP] repeatedly to select the time.

“SLEEP 30” → “SLEEP 60” → “SLEEP 90” → “SLEEP 120”
↑ OFF (Cancel) ↓

- The remaining time is indicated on the unit’s display except when other operations are performed.
- The play timer and sleep timer can be used together. The sleep timer always has priority.

Others

Automatic standby

As a factory preset, this unit will always turn off automatically if there is no sound output and no operation for approx. 30 minutes.

To cancel this function

- 1 Press [SETUP] repeatedly to select "AUTO OFF".
- 2 Press [▲, ▼] to select "OFF" and then press [OK].



- To turn automatic standby on, select "ON" in step 2.
- This setting cannot be selected when "DAB/DAB+" or "FM" is the source.

Display brightness

The brightness of this unit's display can be changed.

Press [DIMMER].

Changing the unit and remote control code

When other Panasonic equipment responds to the supplied remote control, change the remote control code.

- 1 Press [CD] to select "CD".
- 2 Press and hold [CD] on the unit and [CD] on the remote control until the unit's display shows "REMOTE 2".
- 3 Press and hold [OK] and [CD] on the remote control for at least 4 seconds.



- To change the mode back to "REMOTE 1", repeat the steps above but replace the button pressed on the remote control from [CD] to [RADIO].

Troubleshooting

Before requesting service, make the following checks. If you are in doubt about some of the check points, or if the solutions indicated in the following guide do not solve the problem, consult your dealer for instructions.

To return all settings to the factory preset

When the following situations occur, reset the memory:

- There is no response when buttons are pressed.
 - You want to clear and reset the memory contents.
- ① Disconnect the AC mains lead. (Wait for at least 3 minutes before proceeding to step ②.)
 - ② While pressing and holding down [⏻/|] on the unit, reconnect the AC mains lead.
 - "-----" appears on the display.
 - ③ Release [⏻/|].



- All the settings are returned to the factory preset. You will need to reset the memory items.

Common problems

Humming heard during play.

- An AC mains lead or fluorescent light is near the cords. Keep other appliances and cords away from this unit's cables.

MP3 cannot be read.

- You may not be able to play MP3 if you have copied a multi-session disc that has no data between sessions.
- When creating a multi-session disc, it is necessary to close the session.
- The amount of data on the disc is too small. Set the amount of data to above 5 MB.

Disc operations

Incorrect display or play will not start.

- Make sure that the disc is compatible with this unit. (→ 14)
- There is moisture on the lens. Wait for about an hour and then try again.

USB operations

No response when [▶/||] is pressed.

- Disconnect the USB device and then reconnect it. Alternatively, turn the unit off and on again.

The USB drive or its contents cannot be read.

- The USB drive format or its contents is/are not compatible with the unit (→ 14).
- The USB host function of this product may not work with some USB devices.

Slow operation of the USB flash drive.

- Large file size or high memory USB flash drive takes longer time to read.

The elapsed time displayed is different from the actual play time.

- Copy the data to another USB device or backup the data and reformat the USB device.

Radio

SC-HC28DB

DAB/DAB+ reception is poor.

- Keep the antenna away from computers, televisions, other cables and cords.
- Use an outdoor antenna (→ 5).

A beat sound or noise is heard while receiving radio broadcast.

- Confirm the antenna is properly connected. (→ 5)
- Adjust the position of the antenna.
- Try to keep a certain amount of distance between the antenna and AC mains lead.
- Try using an outdoor antenna if there are buildings or mountains nearby.
- Switch the television or other audio players off or separate it from this unit.
- Keep this unit away from mobile phones if the interference is apparent.

SC-HC28DB

iPod/iPhone/iPad operations

Cannot charge or operate.

- Have you selected the appropriate selector?
Press [iPod] to select either "IPOD_DOCK" or "IPOD_PORT".
- Check that the iPod/iPhone/iPad is connected properly. (→ 6)
- The battery of the iPod/iPhone/iPad is depleted. Charge the iPod/iPhone/iPad, and then operate again.
- Connect the iPod/iPhone/iPad again or try to restart the iPod/iPhone/iPad.
- When this unit is in standby mode, charging will not start when using the "IPOD_PORT" connection.
Turn this unit on and make sure the charging has started before switching this unit to standby mode.

Remote control

The remote control doesn't work properly.

- The remote control and this unit are using a different code. (→ 14, "REMOTE □")
- Is the battery depleted or is the battery inserted incorrectly? (→ 4)

Messages

The following messages or service numbers may appear on the unit's display.

"--:--"

- You plugged the AC mains lead in for the first time or there was a power failure recently. Set the time (→ 11).

"ADJUST CLOCK"

- Clock is not set. Adjust the clock accordingly.

"ADJUST TIMER"

- Play timer is not set. Adjust the play timer accordingly.

"AUTO OFF"

- The unit has been left unused for about 30 minutes and will shut down within a minute. Press any button to cancel it.

SC-HC28DB "CHECKING CONNECTION"

- The unit is checking the connected iPod/iPhone/iPad.
- If this display keeps appearing, make sure that the battery of the iPod/iPhone/iPad is not depleted and that the iPod/iPhone/iPad is turned on and connected correctly (→ 6).

SC-HC28DB

"DOCK OPEN"

- Is the dock open? Close the dock completely to open the sliding door.

"ERROR"

- Incorrect operation is performed. Read the instructions and try again.

"F□□" ("□" stands for a number.)

- There is a problem with this unit.
Note down the displayed number, disconnect the AC mains lead and consult your dealer.

"ILLEGAL OPEN"

- Sliding door is not in correct position. Turn the unit off and on again. If this display appears again, consult the dealer.

SC-HC28DB

"IPOD_DOCK OVER CURRENT ERROR"

"IPOD_PORT OVER CURRENT ERROR"

- The iPod/iPhone/iPad is drawing too much power. Disconnect the iPod/iPhone/iPad and turn the unit off and on again.
- The USB device is drawing too much power. Switch to "CD" mode, remove the USB and turn the unit off.

"NODEVICE"

- SC-HC28DB The iPod/iPhone/iPad device is not inserted correctly. Read the instructions and try again (→ 6).
- SC-HC28DB The battery of the iPod/iPhone/iPad is depleted. Charge the iPod/iPhone/iPad and turn it on before connecting.
- The USB device is not inserted. Check the connection.

"NO DISC"

- Insert the disc to be played (→ 6).

SC-HC28DB**“NO MEMORY”**

- There are no preset DAB/DAB+ stations to select. Preset some channels. (→ 8)

“NO PLAY”

- A CD that is not in CD-DA or MP3 format is inserted. It cannot be played.
- If there are more than 255 albums or folders (audio and non-audio), some of the MP3 files in these albums may not be read and played. Transfer these music albums to another USB. Alternatively, reformat the USB device and save these music albums prior to saving the other non-audio folders.

SC-HC28DB**“NO SIGNAL”**

- This station cannot be received. Check your antenna (→ 5).

SC-HC28DB “NOT SUPPORTED”

- You have connected an iPod/iPhone/iPad that cannot be played (→ right).
- If the iPod/iPhone/iPad is compatible, turn it on and connect it correctly.

“READING”

- The unit is checking the CD information. After this display has disappeared, start operating.

“REMOTE □” (“□” stands for a number.)

- The remote control and this unit are using different codes. Change the code on the remote control.
 - When “REMOTE 1” is displayed, press and hold [OK] and [RADIO] for more than 4 seconds.
 - When “REMOTE 2” is displayed, press and hold [OK] and [CD] for more than 4 seconds.

SC-HC28DB**“SCAN FAILED”**

- Stations are not receivable. Check your antenna and try Auto scanning (→ 8).
If “SCAN FAILED” is still displayed find the best signal reception with the “MANUAL SCAN” tuning function. (→ 9)

SC-HC18 “USB OVER CURRENT ERROR”

- The USB device is drawing too much power. Switch to “CD” mode, remove the USB and turn the unit off.

Playable media

SC-HC28DB**Compatible iPod/iPhone/iPad****Compatible with “IPOD_DOCK” connection
(Using Lightning connector)****iPod touch** (5th generation)**iPod nano** (7th generation)**iPhone 5****iPad mini****Compatible with “IPOD_PORT” connection
[Using dedicated USB cable (not supplied)]****iPod touch**

1st, 2nd, 3rd, 4th, and 5th generation

iPod nano

2nd, 3rd, 4th, 5th, 6th, and 7th generation

**iPhone 5 / iPhone 4S / iPhone 4 / iPhone 3GS /
iPhone 3G / iPhone****iPad** (3rd, and 4th generation) / **iPad 2 / iPad****iPad mini**

(as of December 2012)



- Compatibility depends on the software version. Update your iPod/iPhone/iPad to the latest software before using it with this unit.
- Please be aware that Panasonic accepts no responsibility for the loss of data and/or information.

Compatible CD

- A disc with the CD Logo.



- This unit can play back discs that conform to the CD-DA format.
- The unit may not be able to play some discs due to the condition of the recording.

Compatible USB devices

- This unit does not guarantee connection with all USB devices.
- FAT12, FAT16 and FAT32 file systems are supported.
- This unit supports USB 2.0 full speed.
- This unit can support USB devices of up to 32 GB.

Compatible MP3 files

- Supported format: Files with the extension ".mp3" or ".MP3".
- Compatible compression rate: Between 64 kbps and 320 kbps (stereo).
- Depending on how you create the MP3 files, they may not play in the order you numbered them or may not play at all.

Creating MP3 files on a CD-R/RW

- Maximum number of tracks and albums: 999 tracks and 254 albums (Excluding Root folder).
- Disc formats: ISO9660 level 1 and level 2 (except for extended formats).
- If the disc includes both MP3 and normal audio data (CD-DA), the unit plays the type recorded in the inner part of the disc.
- This unit cannot play files recorded using packet write.

Creating MP3 files on a USB device

- Maximum number of tracks and albums: 2500 tracks and 254 albums (Excluding Root folder).
- Only one memory card will be selected when connecting a multiport USB card reader, typically the first memory card inserted.

Licenses

SC-HC28DB

Made for



iPod



iPhone



iPad

"Made for iPod", "Made for iPhone", and "Made for iPad" mean that an electronic accessory has been designed to connect specifically to iPod, iPhone, or iPad, respectively, and has been certified by the developer to meet Apple performance standards. Apple is not responsible for the operation of this device or its compliance with safety and regulatory standards. Please note that the use of this accessory with iPod, iPhone, or iPad may affect wireless performance. iPad, iPhone, iPod, iPod classic, iPod nano, and iPod touch are trademarks of Apple Inc., registered in the U.S. and other countries.

MPEG Layer-3 audio coding technology licensed from Fraunhofer IIS and Thomson.

Specifications

■ GENERAL

Power consumption	SC-HC28DB 40 W
	SC-HC18 12 W
Power consumption in standby mode*1	Approx. 0.2 W
SC-HC28DB	
Power consumption in standby mode (With the iPod dock open)	Approx. 0.4 W
Power supply	AC 220 V to 240 V, 50 Hz

Dimensions (W×H×D)

400 mm×213 mm×110 mm
(Min. Depth: 72 mm)

SC-HC28DB (Depth when tray open: 134 mm)

Mass **SC-HC28DB** Approx. 2 kg

SC-HC18 Approx. 1.9 kg

Operating temperature range
0 °C to +40 °C

Operating humidity range
35 % to 80 % RH (no condensation)

■ AMPLIFIER SECTION

Output power

RMS Output Power Stereo mode

Front Ch (both ch driven)

5 W per channel (6 Ω), 1 kHz, 10 % THD

Total RMS Stereo mode power

10 W

■ TUNER SECTION

Preset Memory FM 30 stations

Frequency Modulation (FM)

Frequency range

87.50 MHz to 108.00 MHz (50 kHz step)

Antenna terminals

75 Ω (unbalanced)

■ **SC-HC28DB** DAB SECTION

DAB memories 20 channels

Frequency Band (Wavelength)

Band III (LOCAL)

10B to 12D

(211.648 MHz to 229.072 MHz)

Band III (ALL BAND III)

5A to 13F

(174.928 MHz to 239.200 MHz)

Sensitivity *BER 4x10⁻⁴

Min Requirement

-98 dBm

DAB External Antenna

Terminal

F - Connector (75 Ω)

■ DISC SECTION

Disc played (8 cm or 12 cm)

CD, CD-R/RW (CD-DA, MP3*2)

Pick up

Wavelength

790 nm (CD)

Audio output (Disc)

Number of channels

2 ch (FL, FR)

■ SPEAKER SYSTEM SECTION

Type

1 way, 1 speaker system (Bass reflex)

Speaker unit(s)

Full range

8 cm Cone type×1 per channel

Impedance

6 Ω

■ TERMINAL SECTION

SC-HC28DB "IPOD_DOCK" connection

DC OUT 5 V 2.1 A MAX

"IPOD_PORT" connection (**SC-HC28DB**) /

"USB" connection (**SC-HC18**)

SC-HC28DB DC OUT 5 V 2.1 A MAX

SC-HC18 DC OUT 5 V 500 mA MAX

USB Standard

USB 2.0 full speed

Media file format support

MP3 (*.mp3)

USB device file system

FAT12, FAT16, FAT32



- Specifications are subject to change without notice. Mass and dimensions are approximate.
- Total harmonic distortion is measured by a digital spectrum analyzer.

*1: **SC-HC28DB** When the iPod/iPhone/iPad is not charging and the dock is closed.

*2: MPEG-1 Layer 3, MPEG-2 Layer 3

Information for Users on Collection and Disposal of Old Equipment and used Batteries



These symbols on the products, packaging, and/or accompanying documents mean that used electrical and electronic products and batteries should not be mixed with general household waste.

For proper treatment, recovery and recycling of old products and used batteries, please take them to applicable collection points, in accordance with your national legislation and the Directives 2002/96/EC and 2006/66/EC.

By disposing of these products and batteries correctly, you will help to save valuable resources and prevent any potential negative effects on human health and the environment which could otherwise arise from inappropriate waste handling.

For more information about collection and recycling of old products and batteries, please contact your local municipality, your waste disposal service or the point of sale where you purchased the items.

Penalties may be applicable for incorrect disposal of this waste, in accordance with national legislation.



For business users in the European Union

If you wish to discard electrical and electronic equipment, please contact your dealer or supplier for further information.

[Information on Disposal in other Countries outside the European Union]

These symbols are only valid in the European Union. If you wish to discard these items, please contact your local authorities or dealer and ask for the correct method of disposal.



Note for the battery symbol (bottom two symbol examples):

This symbol might be used in combination with a chemical symbol. In this case it complies with the requirement set by the Directive for the chemical involved.

Cd

SC-HC28DB Attaching the support pad to this unit

Attach the supplied support pad to prevent damage or scratches to this unit's sliding door or the device connected to the "IPOD_DOCK".

Attach the support pad before using this unit.

- The location is the same for either iPod touch, iPod nano, iPhone or iPad mini.

1 Align this page to the sliding door and locate the position to attach the pad.

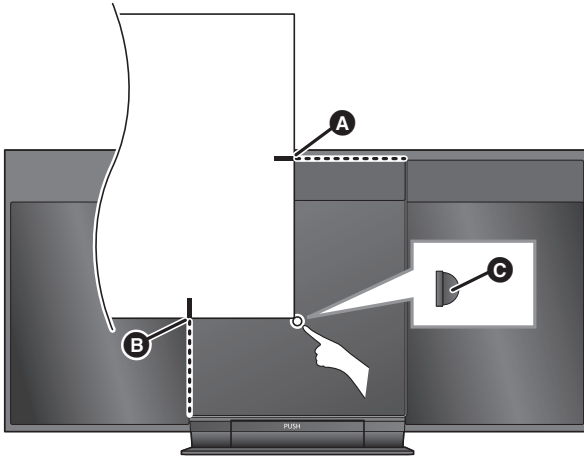

- A** Align with the top of the sliding door.
- B** Align with the side of the sliding door.
- C** Pad (supplied)

2 Attach the pad near the corner of this page.

e.g., iPhone 5

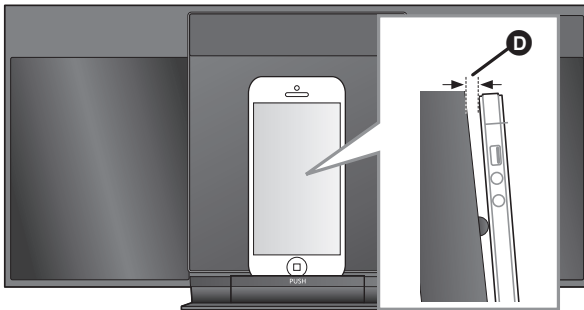

- D** There will be a gap between this unit's sliding door and the connected device.



- 2 pads are supplied with this unit.
Keep the other pad in a secure place for future use.

A

B

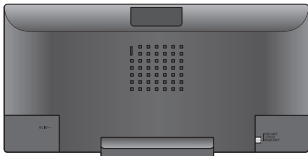

(Bottom of product)

Pursuant to the applicable EU legislation
Panasonic Marketing Europe GmbH
Panasonic Testing Centre
Winsbergring 15, 22525 Hamburg, Germany



Panasonic Corporation
Web Site: <http://panasonic.net>

