



Operating Instructions

Blu-ray Disc™ Home Theater Sound System

Model No. SC-BTT880
SC-BTT480
SC-BTT460
SC-BTT400
SC-BTT300



Unless otherwise indicated, illustrations in these operating instructions are of SC-BTT880.



Firmware updates

Panasonic is constantly improving the unit's firmware to ensure that our customers are enjoying the latest technology.

Panasonic recommends updating your firmware as soon as you are notified.

For details, refer to "Firmware updates" (⇒ 21) or

<http://panasonic.jp/support/global/cs/> (This site is in English only.)

Thank you for purchasing this product.

Please read these instructions carefully before using this product, and save this manual for future use.

Precautions

WARNING

Unit

- To reduce the risk of fire, electric shock or product damage,
- Do not expose this unit to rain, moisture, dripping or splashing.
 - Do not place objects filled with liquids, such as vases, on this unit.
 - Use only the recommended accessories.
 - Do not remove covers.
 - Do not repair this unit by yourself. Refer servicing to qualified service personnel.
 - Do not let metal objects fall inside this unit.
 - Do not place heavy items on this unit.

AC mains lead

- To reduce the risk of fire, electric shock or product damage,
- Ensure that the power supply voltage corresponds to the voltage printed on this unit.
 - Insert the mains plug fully into the socket outlet.
 - Do not pull, bend, or place heavy items on the lead.
 - Do not handle the plug with wet hands.
 - Hold onto the mains plug body when disconnecting the plug.
 - Do not use a damaged mains plug or socket outlet.

The mains plug is the disconnecting device.

Install this unit so that the mains plug can be unplugged from the socket outlet immediately.

Small object

- Keep the Memory Card out of reach of children to prevent swallowing.
- Keep the screws out of reach of children to prevent swallowing.

CAUTION

Unit

- This unit utilizes a laser. Use of controls or adjustments or performance of procedures other than those specified herein may result in hazardous radiation exposure.
- Do not place sources of naked flames, such as lighted candles, on this unit.
- This unit may receive radio interference caused by mobile telephones during use. If such interference occurs, please increase separation between this unit and the mobile telephone.
- **For Australia and New Zealand**
This unit is intended for use in moderate climates.
- **Except Australia and New Zealand**
This unit is intended for use in tropical climates.
- **BT1680 For wireless system**
Product Identification Marking is located on the bottom of the wireless system.

Placement

Place this unit on an even surface.

- To reduce the risk of fire, electric shock or product damage,
- Do not install or place this unit in a bookcase, built-in cabinet or in another confined space. Ensure this unit is well ventilated.
 - Do not obstruct this unit's ventilation openings with newspapers, tablecloths, curtains, and similar items.
 - Do not expose this unit to direct sunlight, high temperatures, high humidity, and excessive vibration.

Speaker

- **Use only supplied speakers**
The main unit and supplied speakers are to be used only as indicated in these operating instructions. Failure to do so may lead to damage to the amplifier and/or the speakers, and may result in the risk of fire. Consult a qualified service person if damage has occurred or if you experience a sudden change in performance.
- Be careful not to cross (short-circuit) or reverse the polarity of the speaker wires as doing so may damage the speakers.
- Hold the speaker firmly to avoid injury by dropping the speaker when carrying.
- You can damage your speakers and shorten their useful life if you play sound at high levels over extended periods.
- Do not touch the front area of the speakers. Hold by the sides.
- Place speakers on flat, secure surfaces.
- To avoid injury by falling or dropping the speaker, place the speaker cables with care not to stumble or hook.
- Do not stand on the speaker. Be cautious when children are near.

Batteries

Mishandling of batteries can cause electrolyte leakage and may cause a fire.

- Danger of explosion if battery is incorrectly replaced. Replace only with the type recommended by the manufacturer.
- When disposing the batteries, please contact your local authorities or dealer and ask for the correct method of disposal.
- Do not mix old and new batteries or different types at the same time.
- Do not heat or expose to flame.
- Do not leave the battery(ies) in a car exposed to direct sunlight for a long period of time with doors and windows closed.
- Do not take apart or short circuit.
- Do not recharge alkaline or manganese batteries.
- Do not use batteries if the covering has been peeled off.

Remove batteries if you do not intend to use the remote control for a long period of time. Store in a cool, dark place.

Wireless LAN connection

The following limits are in place regarding the usage of this unit or Wireless LAN Adaptor. You must be aware of these limits before using these devices.

Panasonic will in no way be responsible for any incidental damage which may arise due to a failure to obey these limits, or to any condition of use or misuse of these devices.

- **Data transmitted and received over radio waves may be intercepted and monitored.**
- **This unit and Wireless LAN Adaptor contain delicate electronic components.**

Please use these devices in the manner in which they were intended and follow the following points:

- Do not expose these devices to high temperatures or direct sunlight.
- Do not bend, or subject these devices to strong impacts.
- Keep these devices away from moisture.
- Do not disassemble or alter these devices in any way.

To dispose or transfer this unit

The unit may keep the user settings information in the unit. If you discard this unit either by disposal or transfer, then follow the procedure to return all the settings to the factory presets to delete the user settings. (→ 46, "To return all settings to the factory preset.")

- The operation history may be recorded in the memory of this unit.

– If you see this symbol –

Information on Disposal in other Countries outside the European Union

This symbol is only valid in the European Union. If you wish to discard this product, please contact your local authorities or dealer and ask for the correct method of disposal.



Restriction on use of unauthorized copied content

This unit adopts the following technology for copyright protection.

Cinavia Notice

This product uses Cinavia technology to limit the use of unauthorized copies of some commercially-produced film and videos and their soundtracks. When a prohibited use of an unauthorized copy is detected, a message will be displayed and playback or copying will be interrupted.

More information about Cinavia technology is provided at the Cinavia Online Consumer Information Center at <http://www.cinavia.com>. To request additional information about Cinavia by mail, send a postcard with your mailing address to:

Cinavia Consumer Information Center, P.O. Box 86851, San Diego, CA, 92138, USA.

AC Mains Lead

(For the AC mains plug of three pins)

How to replace the fuse

The location of the fuse differ according to the type of AC mains plug (figures A and B). Confirm the AC mains plug fitted and follow the instructions below.

Illustrations may differ from actual AC mains plug.

- 1 Open the fuse cover with a screwdriver.

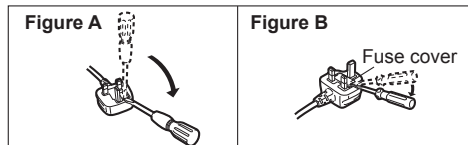

- 2 Replace the fuse and close or attach the fuse cover.

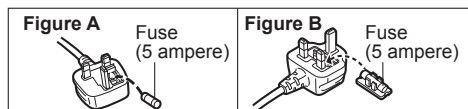

Table of contents

Precautions	2
-------------------	---

Getting started

Package contents and accessories	5
Unit and media care	6
Playable media	7
Control reference guide	9
STEP 1: Positioning	12
STEP 2: Preparing the speakers	13
STEP 3: Connections	15
STEP 4: Connecting the AC mains lead	19
STEP 5: BTT880 Preparing the wireless system	19
STEP 6: Settings	20
Inserting or removing media	22
Enjoying TV with unit's speakers	22
HOME menu	23
Multi User Mode	24

Playback

Playback	25
BTT880 BTT480 BTT460 BTT400	
Using the iPod/iPhone	27

TV & Radio

VIERA Link "HDMI Control™"	29
•Enjoying TV and STB with unit's speakers	30
Listening to the Radio	31

Advanced operations

BTT880 BTT480 BTT460 BTT400	
VIERA Connect	
(Enjoying Internet Service)	32
Home Network feature	33
Option menu	34
Setup menu	37
•Speaker settings	43
Changing the sound settings	44
Speaker installation option	44

Reference

Troubleshooting guide	46
Messages	50
Specifications	51
Limited Warranty	
(ONLY FOR AUSTRALIA)	Back cover

Package contents and accessories

Check the package contents and supplied accessories before using this unit.

Package contents

<div><div>BTT880 Main unit (SA-BTT880)</div><div><div>FRONT (SB-HF4800)</div><div>SURROUND (SB-HS8800)</div></div><div>(Speakers)</div><div>(Stands)</div><div>(Bases)</div><div>(Screws)</div><div>CENTER (SB-HC4000)</div><div>SUBWOOFER (SB-HW185)</div></div> <div>(Speaker cables)</div> <div>Wireless system (SH-FX71)</div>

Getting started

Playback

TV & Radio

Advanced operations

Reference

Accessories

- ☐ **1 Remote control**
BTT880 BTT480 BTT460 BTT400
 (N2QAYB000729)
BTT300
 (N2QAYB000851)



- ☐ **2 Batteries for remote control**



- ☐ **AC mains leads***



* See page 19 for more information.

- ☐ **1 HDMI cable**



- ☐ **1 FM indoor antenna**



- ☐ **BTT880**
1 Digital transmitter



- ☐ **BTT880 BTT480 BTT460 BTT400**
1 Sheet of speaker cable sticker
BTT300
2 Sheets of speaker cable sticker



Unit and media care

■ Clean this unit with a soft, dry cloth

- Never use alcohol, paint thinner or benzene to clean this unit.
- Before using chemically treated cloth, carefully read the instructions that came with the cloth.

■ This unit's lens

Lens cleaner: RP-CL720AE

- This lens cleaner may not be for sale depending on the region.
- This lens cleaner is sold as specific for DIGA, but can be used on this unit as well.

■ Clean discs

DO

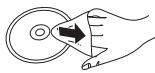

DO NOT



Wipe with a damp cloth and then wipe dry.







■ Disc and card handling precautions

- Handle discs by the edges to avoid inadvertent scratches or fingerprints on the disc.
- Do not attach labels or stickers to discs.
- Do not use disc cleaning sprays, benzene, thinner, static electricity prevention liquids or any other solvent.
- Clean any dust, water, or foreign matter from the terminals on the rear side of the card.
- Do not use the following discs:
 - Discs with exposed adhesive from removed stickers or labels (rented discs etc.).
 - Discs that are badly warped or cracked.
 - Irregularly shaped discs, such as heart shapes.



- Product numbers provided in these operating instructions correct as of December 2012. These may be subject to change.
- Do not use AC mains lead with other equipment.
- Please note that the actual controls and components, menu items, etc. may look somewhat different from those shown in the illustrations in these Operating Instructions.

Playable media

Device	Disc markings	Device types	Contents format
BD		BD-Video	Video
		BD-RE	Video, JPEG, MPO
		BD-R	Video, MKV
DVD		DVD-Video	Video
		DVD-R	Video, AVCHD, MKV, JPEG, MPO, FLAC, MP3, WAV
		DVD-R DL	
		DVD-RW	Video, AVCHD
	—	+R/+RW/+R DL	
CD		Music CD	Music [CD-DA]
	—	CD-R CD-RW	MKV, JPEG, MPO, FLAC, MP3, Music [CD-DA], WAV
SD		SD Memory Card (from 8 MB to 2 GB) SDHC Memory Card (from 4 GB to 32 GB) SDXC Memory Card (48 GB, 64 GB) (Compatible with both mini and micro types)	AVCHD, AVCHD 3D, MP4, MPEG2, JPEG, MPO
USB	—	USB devices (up to 2 TB)	MKV, MP4, MPEG2, JPEG, MPO, FLAC, MP3, WAV

● See pages 8 and 53 for more information on the types of content that can be played.

■ Discs that cannot be played by this unit

- DVD-RAM
- Super Audio CD
- Photo CD
- DVD-Audio
- WMA discs
- DivX discs
- HD DVD
- Video CD and Super Video CD

■ Region management information

BD-Video

For South East Asia

This unit can play BD-Video discs supporting the region code "A".

Example:



For Australia and New Zealand For the Middle East

This unit can play BD-Video discs supporting the region code "B".

Example:



DVD-Video

For the Middle East

This unit can play DVD-Video discs supporting the region number "2" or "ALL".

Example:



For South East Asia

This unit can play DVD-Video discs supporting the region number "3" or "ALL".

Example:



For Australia and New Zealand

This unit can play DVD-Video discs supporting the region number "4" or "ALL".

Example:



■ Finalize

DVD-R/RW/R DL, +R/+RW/+R DL and CD-R/RW recorded by a recorder, etc. needs to be finalized by the recorder to play on this unit. Please refer to the recorder's instructions.

■ BD-Video

This unit supports high bit rate audio (Dolby® Digital Plus, Dolby® TrueHD, DTS-HD High Resolution Audio and DTS-HD Master Audio) adopted in BD-Video.

■ 3D

- 3D videos and 3D still pictures can be played back when this unit is connected to a 3D compatible TV using a High Speed HDMI Cable.
- 2D video can be enjoyed as 3D virtually. (⇒ 37)

■ Music CD

Operation and sound quality of CDs that do not conform to CD-DA specifications (copy control CDs, etc.) cannot be guaranteed.

■ SD card

- miniSD Cards, microSD Cards, microSDHC Cards and microSDXC Cards can be used, but must be used with an adaptor card. These are usually supplied with such cards, or otherwise customer provided.
- To protect the card's contents, move the record prevention tab (on the SD card) to "LOCK".
- This unit is compatible with SD Memory Cards that meet SD Card Specifications FAT12 and FAT16 formats, as well as SDHC Memory Cards in FAT32 format and SDXC Memory Cards in exFAT.
- If the SD card is used with incompatible computers or devices, recorded contents may be erased due to the card being formatted etc.
- Usable memory may be slightly less than the card capacity.



■ USB device

- This unit does not guarantee connection with all USB devices.
- This unit does not support USB device charging.
- FAT12, FAT16, FAT32, and NTFS file systems are supported.
- This unit supports USB2.0 High Speed.
- This unit can support an HDD formatted to FAT32 and NTFS. Some types of HDD may require the use of its external power supply unit.

■ BD-RE, BD-R

Discs recorded in DR mode using Panasonic Blu-ray Disc recorders may not play back the audio etc., correctly.



- It may not be possible to play the above media in some cases due to the type of media, the condition of the recording, the recording method, and how the files were created.
- The producers of the disc can control how discs are played, so you may not always be able to control play as described in these operating instructions. Read the disc's instructions carefully.

Control reference guide

Remote control

e.g., **BTT880** **BTT480** **BTT460** **BTT400**

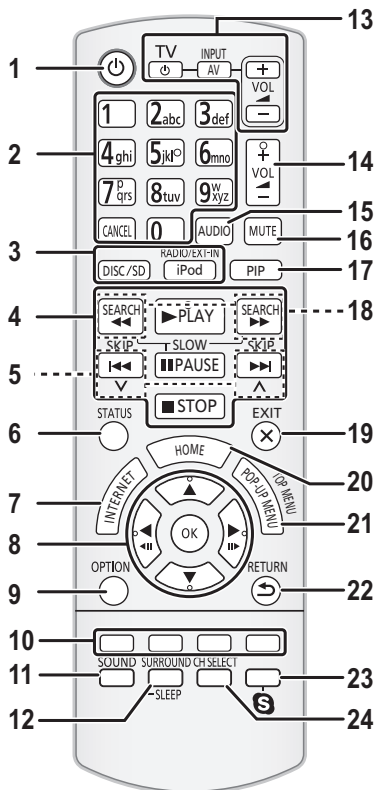

Using the remote control

Insert so the poles (+ and -) match those in the remote control.

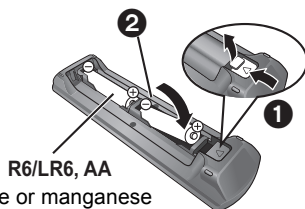

Point it at the remote control signal sensor on this unit. (⇒ 10)

- Turn the unit on and off
- Select title numbers, etc./
BTT880 **BTT480** **BTT460** **BTT400**
Enter numbers or characters
BTT300 Enter numbers
[CANCEL]: Cancel
- Select the source
- Basic playback control buttons (⇒ 25)
- Select preset radio stations (⇒ 31)
- Show status messages (⇒ 26)
- BTT880** **BTT480** **BTT460** **BTT400** Show the Home screen of the VIERA Connect (⇒ 32)
BTT300 Show Top Menu (⇒ 26)
- [▲, ▼, ◀, ▶]: Move the highlight for selection
[OK]: Confirm the selection
(◀▶)(◀▶): Frame-by-frame (⇒ 25)
- Show OPTION menu (⇒ 34)
- Coloured buttons (red, green, yellow, blue)
Used for various purposes depending on the display
- Set the sound mode (⇒ 44)
- Select surround sound effects (⇒ 44)/Set the sleep timer
 - Press and hold [-SLEEP].
 - While "SLEEP * *" is displayed, press [-SLEEP] several times to select the time (in minutes).
 - Timer selection is up to 120 minutes.
 - Select "OFF" when cancelling the setting.
 - To confirm the remaining time
Press and hold the button again.
- TV operation buttons**
[TV]: Turn the television on and off
[AV, INPUT]: Switch the input select
[+ - VOL]: Adjust the volume
- Adjust the volume of the main unit
- Select audio (⇒ 25)
- Mute the sound
 - "MUTE" flashes on the unit's display, while the function is on.
 - To cancel, press the button again or adjust the volume.
 - Muting is cancelled if the unit is turned off.
- Switch on/off Secondary Video
(Picture-in-picture)
- Select radio stations manually (⇒ 31)
- Exit the menu screen
- Show HOME menu (⇒ 23)
- BTT880** **BTT480** **BTT460** **BTT400**
Show Pop-up Menu/Top Menu (⇒ 26)
BTT300 Show Pop-up Menu (⇒ 26)
- Return to previous screen
- BTT880** **BTT480** **BTT460** **BTT400**
Start up a video communication (⇒ 32)
- Select speaker channel (⇒ 44)

Main unit (Front)

BTT880

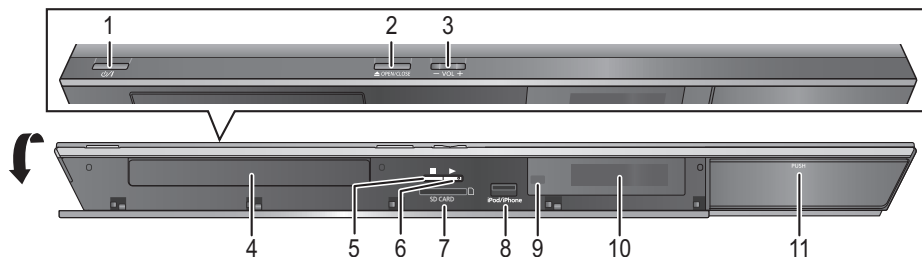

e.g., **BTT480** **BTT460** **BTT400**

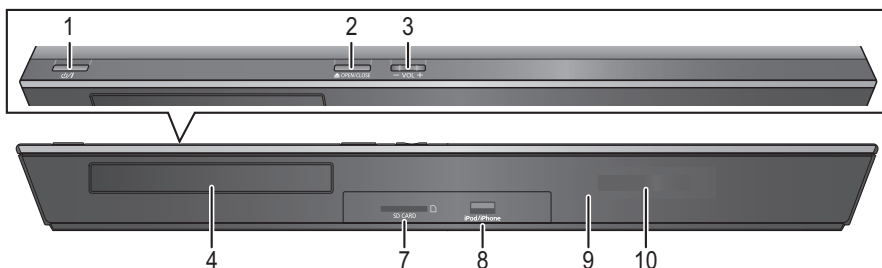

- | | |
|---|---|
| <p>1 Standby/on switch (⏻/⏻) (⇒ 20)
Press to switch the unit from on to standby mode or vice versa. In standby mode, the unit is still consuming a small amount of power.</p> <p>2 Open or close the disc tray (⇒ 22)</p> <p>3 Adjust the volume of the main unit</p> <p>4 Disc tray</p> <p>5 BTT880
Stop (⇒ 25)</p> <p>6 BTT880
Start play (⇒ 25)</p> | <p>7 SD card slot (⇒ 22)</p> <p>8 USB port
BTT880 BTT480 BTT460 BTT400 (⇒ 22, 28)
BTT300 (⇒ 18, 22)</p> <p>9 Remote control signal sensor
Distance: within approx. 7 m.
Angle: Approx. 20° up and down, 30° left and right</p> <p>10 Display</p> <p>11 BTT880
Dock for iPod/iPhone (⇒ 28)</p> |
|---|---|

Main unit (Rear)

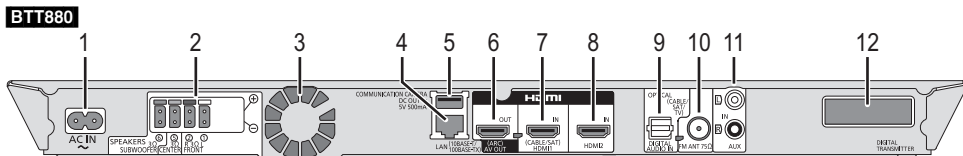

e.g., **BTT480** **BTT460** **BTT400**

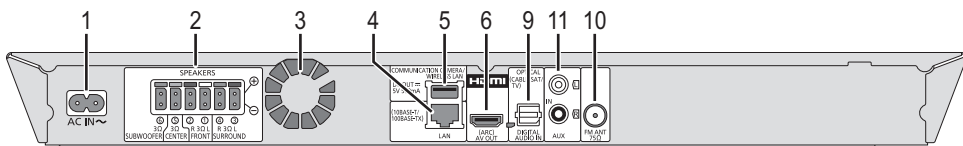

- | | | | |
|---|---|----|--|
| 1 | AC IN terminal (⇒ 19) | 7 | BTT880 |
| 2 | Speaker terminals (⇒ 15) | | HDMI1 IN (CABLE/SAT) terminal (⇒ 17) |
| 3 | Cooling fan | 8 | BTT880 |
| 4 | LAN port (⇒ 18) | | HDMI2 IN terminal (⇒ 17) |
| 5 | BTT880 BTT480 BTT460 BTT400 | 9 | DIGITAL AUDIO IN terminal (⇒ 16, 17) |
| | USB port (⇒ 18, 32) | 10 | FM radio antenna terminal (⇒ 16) |
| 6 | HDMI AV OUT (ARC) terminal (⇒ 16, 17) | 11 | AUX terminal (⇒ 16) |
| | | 12 | BTT880 |
| | | | Digital transmitter dock for wireless system |

STEP 1: Positioning

For optimum position

Place the front, centre and surround speakers at approximately the same distance from the seating position.

- Adjust the volume using the Delay time function if the distance between each speaker and the seating position is not equal. (⇒ 43)

e.g., **BTT880**

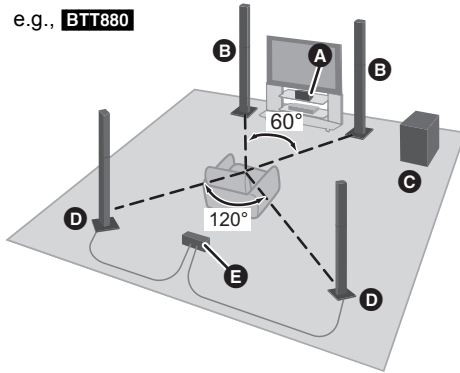

- A** Centre speaker
 - Put on a rack or shelf not to interfere with the TV's various sensors (ambient light, etc.). Vibration caused by the speaker can disrupt the picture if it is placed directly on the TV.
- B** Front speakers
- C** Subwoofer
- D** Surround speakers
 - Place the speakers at the same height or higher than ear level.
- E** **BTT880** Wireless system
 - To avoid interference, separate the wireless system from the other electronic devices that use the same radio frequency (2.4 GHz band).



- Place the wireless system within approximately 10 m from the main unit.
- To allow for proper ventilation and to maintain good airflow around the wireless system, position it with at least 5 cm of space on all sides.
- Do not use the wireless system or the digital transmitter in a metal cabinet or bookshelf.
- Keep your speakers at least 10 mm away from the system to avoid noise generated by resonance.
- Placing speakers too close to floors, walls, and corners can result in excessive bass. Cover walls and windows with thick curtains.
- For optional wall mount, refer to page 44.

■ **BTT880** Upgrade to 7.1-channel system

The main unit is designed to enjoy the 7.1ch surround sound. A more theatre-like effect is possible with a wireless connection.

Necessary equipment:

- Wireless system (SH-FX71)
 - 1 optional system
- 2 additional speakers [Impedance: 3 Ω to 6 Ω, Speaker input power: 100 W (Min)]



- For more details, refer to the operating instructions for SH-FX71.
- The WIRELESS LINK indicator lights green when this unit and SH-FX71 are connected wirelessly. You can also check the link status if you press and hold the [SOUND] of this unit. When WIRELESS LINK is turned on, the main unit's display shows the message, "WIRELESS SPEAKERS LINKED".

STEP 2: Preparing the speakers

Assembling the speakers

BTT880 BTT480 Front speakers, Surround speakers **BTT460** Front speakers

1 Attach the stand to the base.

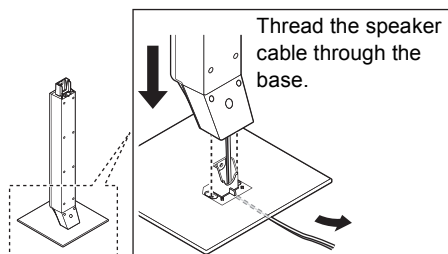

4 Attach the speaker.

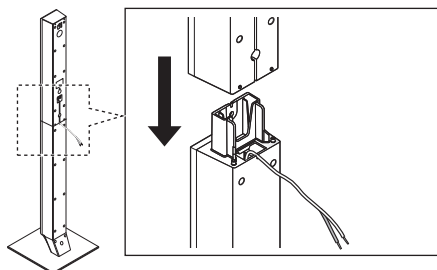

2 Tighten the 3 screws (supplied) securely.

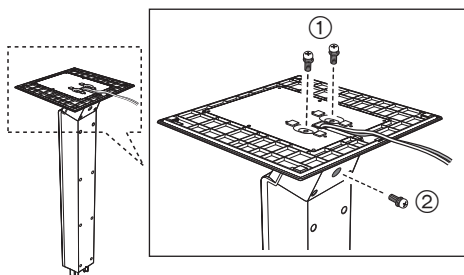

5 Tighten the screw (supplied) securely.

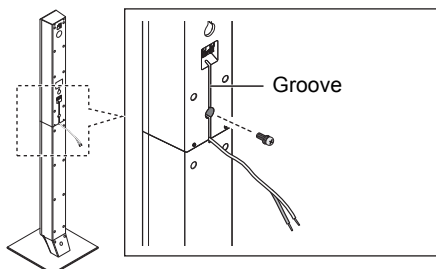

3 Slide the speaker cable into the groove.

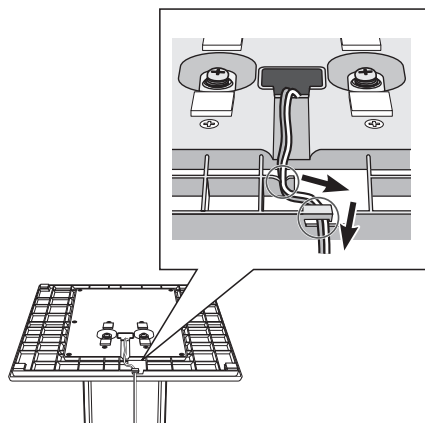

- After connecting the speaker cable (⇒ 14), press the cable into the groove.



- To prevent damage or scratches, lay down a soft cloth and perform assembly on it.

Connecting the speaker cables

Attach the speaker cable sticker (supplied) and connect the speaker cables to the speakers.

BTT880 **BTT480** **BTT460** **BTT400**

e.g., **BTT460** **BTT400** Surround speaker

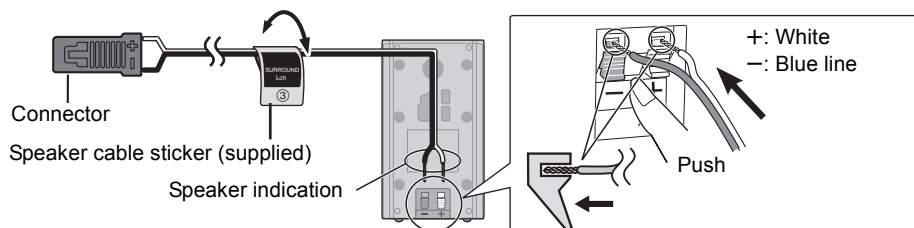

Speaker cable sticker	Connector
① FRONT Lch ①	White
② FRONT Rch ②	Red
③ SURROUND Lch ③	Blue
④ SURROUND Rch ④	Grey
⑤ CENTER ⑤	Green
⑥ SUBWOOFER ⑥	Purple

BTT300

e.g., Surround speaker

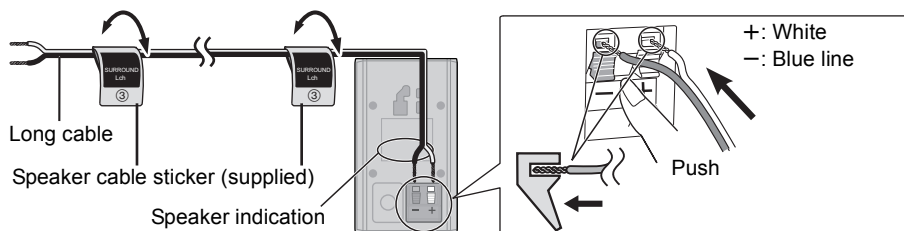

Speaker cable sticker	Cable type
① FRONT Lch ①	Short
② FRONT Rch ②	Short
③ SURROUND Lch ③	Long
④ SURROUND Rch ④	Long
⑤ CENTER ⑤	Short
⑥ SUBWOOFER ⑥	(Attached to subwoofer)

STEP 3: Connections

Turn off all equipment before connection and read the appropriate operating instructions.
Do not connect the AC mains lead until all other connections are complete.

Speaker connection

BTT880

Connect the speaker cables to the terminals of the same colour.

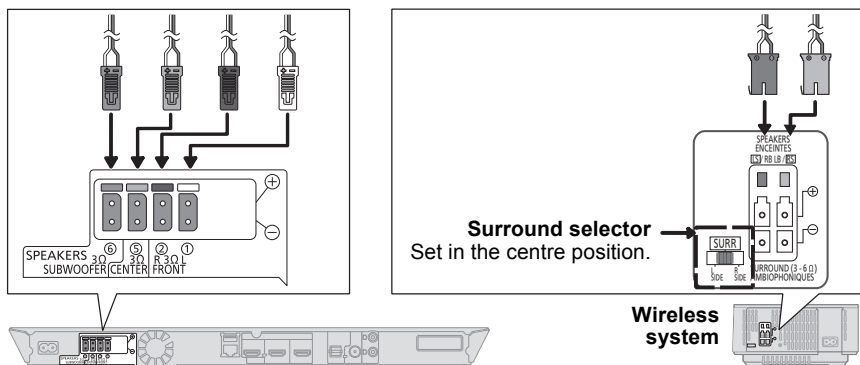

BTT480 BTT460 BTT400

Connect the speaker cables to the terminals of the same colour.

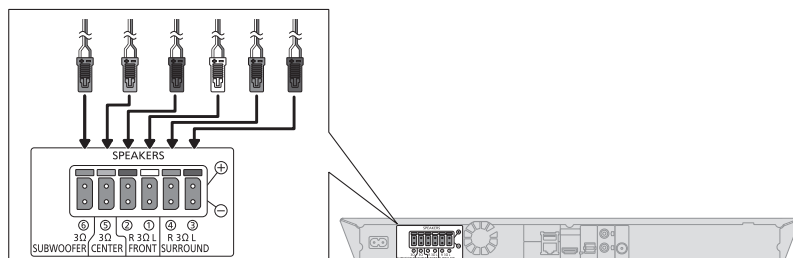

BTT300

Connect the speaker cables to the terminals by referring to the attached speaker cable sticker.

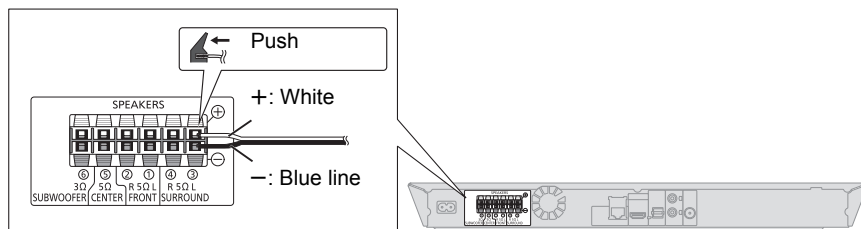

Connecting to a TV

HDMI

- Use the ARC compatible High Speed HDMI cables. Non-HDMI-compliant cables cannot be utilized. The HDMI-compliant cable is supplied with this unit. It is recommended that you use Panasonic's HDMI cable. When outputting 1080p signal, please use HDMI cables 5.0 meters or less.
- Audio will be output through the system's speakers when "Off" is selected in "HDMI Audio Output". (⇒ 39)

TV Audio

- To output TV audio from this unit's speakers, you need to switch the selector. (⇒ 22)

OPTICAL IN

- After making the digital audio connection, make settings to suit the type of audio from your digital equipment. (⇒ 39)

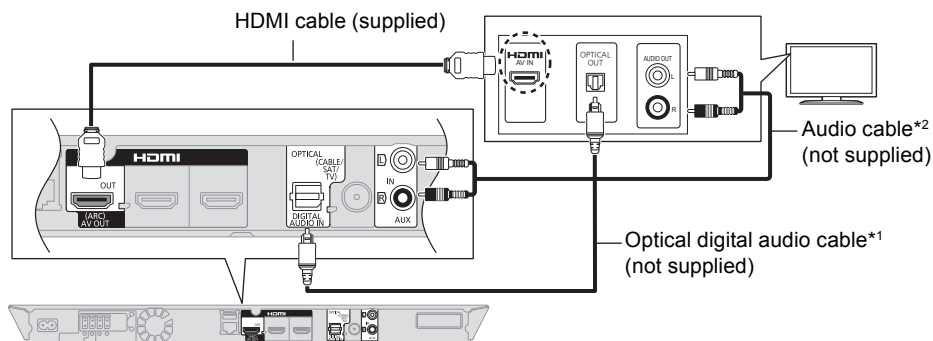

*1 If the HDMI terminal on the TV is labelled "HDMI (ARC)", the connection of the optical digital audio cable is not required.

*2 It is also possible to use an audio cable instead of the optical digital audio cable. In this case, connect the AUX terminal on the main unit with the audio output terminal on the TV.

What is ARC?

ARC is an abbreviation of Audio Return Channel, also known as HDMI ARC. This feature allows a home theatre system to receive and play audio from the TV through a single HDMI cable without additional wiring.

FM antenna connection

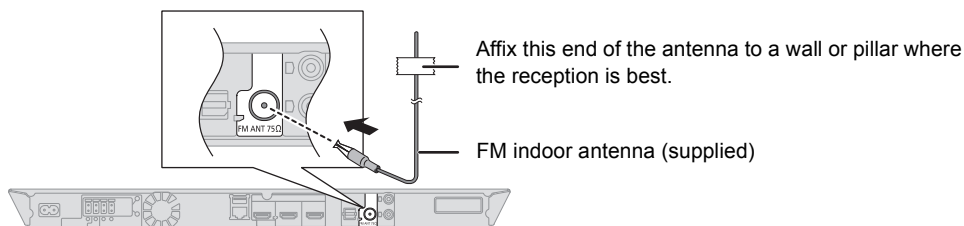

- Use an FM outdoor antenna if radio reception is poor.

Other device connection

BTT880 When the connecting devices have an HDMI terminal

e.g.,

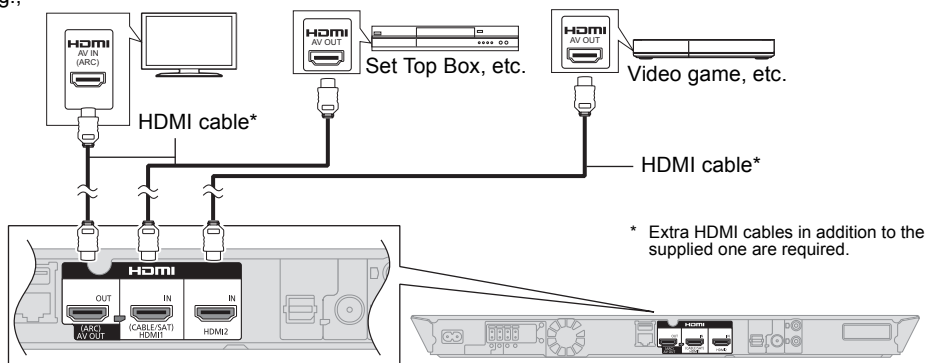

HDMI standby pass-through

Even if this system is in standby mode, the audio and/or video signal from the device connected to the HDMI1 IN (CABLE/SAT) or HDMI2 IN terminal will be sent to the TV connected to the HDMI AV OUT terminal (the sound will not be output from this system). Even while the unit is in the standby mode, you can change the input signal HDMI1 IN (CABLE/SAT) or HDMI2 IN by pressing [EXT-IN] on the remote control.

When the connecting devices do not have an HDMI terminal

e.g.,

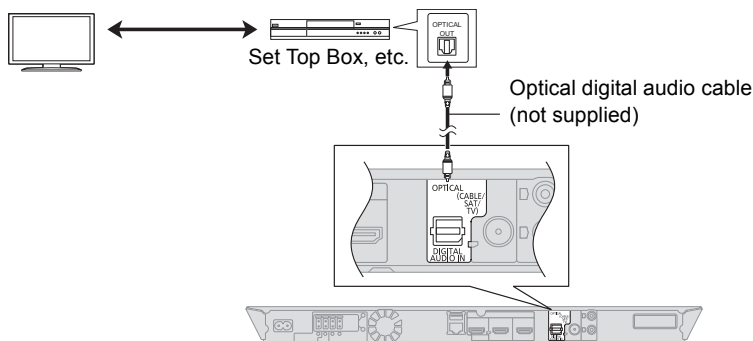

BTT880 Digital transmitter connection

Do not insert or remove while the home theatre unit is on.

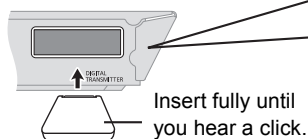

DO

DO NOT

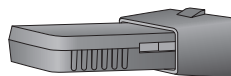
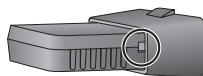

Make sure that the digital transmitter is fully inserted. If the digital transmitter is not fully inserted, the sound may not be available from the surround speakers.

Connecting to the network

The following services can be used when this unit is connected to broadband.

- Firmware can be updated (⇒ 21)
- You can enjoy BD-Live (⇒ 26)
- You can enjoy VIERA Connect (⇒ 32)
- You can access other devices (Home Network) (⇒ 33)
- **BTT880**
This unit supports Wi-Fi Direct™ and can make a wireless connection to wireless devices without router. You can use this function when enjoying Home Network feature, etc. Internet access is not available while connected via Wi-Fi Direct™. (⇒ 33, 40)

For details about connection method, refer to the instructions supplied with the connected equipment.

Wireless LAN connection

BTT880

This unit has built in Wi-Fi® and can be connected to a wireless router.



BTT480 BTT460 BTT400 BTT300

For wireless capability, connect the Wireless LAN Adaptor DY-WL5 (optional). Only DY-WL5 can be used. Read the operating instructions for DY-WL5 thoroughly when using it.

e.g., **BTT480 BTT460 BTT400**

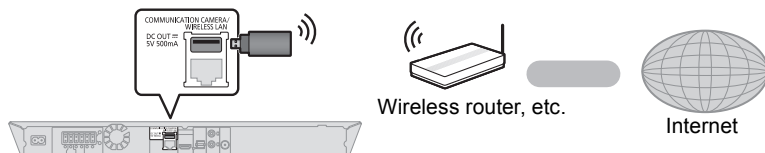

- **BTT300** Connect DY-WL5 to the front USB port.
- A wireless LAN connection can be used only in those countries where the wireless function is authorized for use. Use of a wireless LAN connection is prohibited in the regions where DY-WL5 is not sold.
- For up-to-date compatibility information on your wireless router, refer to <http://panasonic.jp/support/global/cs/> (This site is in English only.)
- The unit is not compatible with public wireless LAN services provided in airports, stations, cafes, etc.
- See page 2 for the precautions of wireless LAN connection.

LAN cable connection

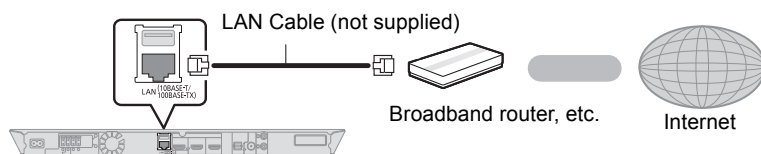

- Use category 5 or above straight LAN cables (STP) when connecting to peripheral devices.
- Inserting any cable other than a LAN cable in the LAN terminal can damage the unit.

STEP 4: Connecting the AC mains lead

Connect only after all other connections are complete.

For the Middle East and South East Asia

2 AC mains leads are supplied.

Use the AC mains lead that matches the socket for the area you live in.

- In Saudi Arabia, always use the 3-pin AC mains lead.
- AC mains lead with a label is for Thailand. AC mains lead without a label is for areas other than Thailand.

BTT880

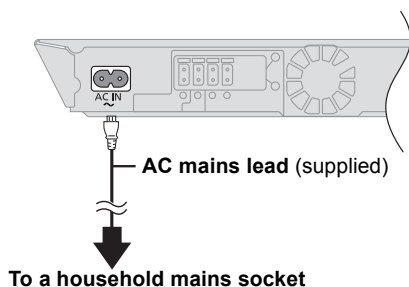

Wireless system

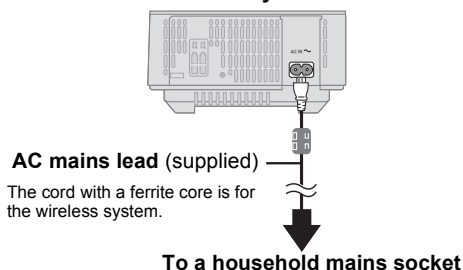

BTT480 BTT460 BTT400 BTT300

e.g.,

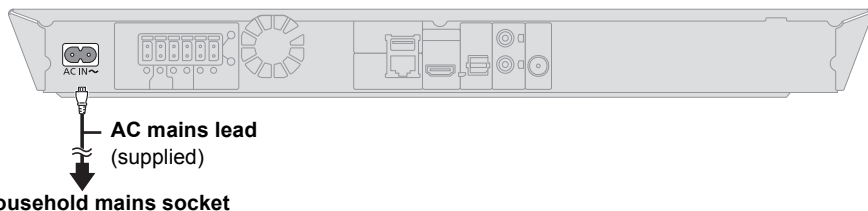

- The wireless system (**BTT880**) and the main unit consume a small amount of AC power (⇒ 51, 53) even when turned off. For the purpose of power conservation, the unit can be disconnected if you will not be using it for extended period of time.

STEP 5: **BTT880** Preparing the wireless system

Turn on the wireless system after all connections are complete.

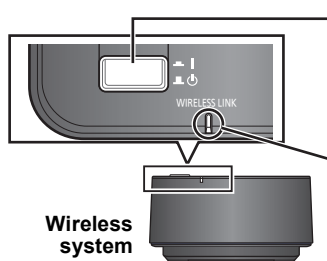

Press [**I**, **⏻**] on the wireless system.

I: The wireless system is on.

⏻: The wireless system is off.

The wireless system consumes a small amount of power, even when it is off.

WIRELESS LINK indicator

Red: The wireless system is on and the wireless link is deactivated.

Green: The wireless system is on and the wireless link is activated.

STEP 6: Settings

Easy Setting

After connecting your new home theatre for the first time and pressing [⏻], a screen for the basic settings will appear.

Preparation

Turn on the television and select the appropriate video input on the television.

BTT880

- Confirm the digital transmitter connection. (⇒ 17)

1 Press [⏻].

Setup screen appears.

2 Follow the on-screen instructions and apply the settings.



- You can perform this setup anytime by selecting "Easy Setting" in the Setup menu. (⇒ 41)
- If this unit is connected to a Panasonic TV (VIERA) supporting HDAVI Control 2 or later via an HDMI cable, then the setting information on the TV is acquired by this unit.

Easy Network Setting

After completing "Easy Setting", you can perform "Easy Network Setting".

Select "Wired" or "Wireless" and press [OK].

e.g., **BTT880**

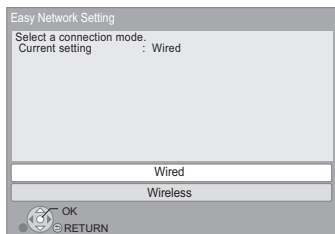

■ "Wired" connection

Follow the on-screen instructions to apply your connection settings.

■ "Wireless" connection

Before beginning wireless connection setup

- Obtain your network name (SSID*1).
- If your wireless connection is encrypted, please be sure that you know your encryption key.

BTT480 BTT460 BTT400 BTT300

If "Wireless LAN Adaptor is not connected." is displayed, check that the Wireless LAN Adaptor is fully inserted. Alternatively, disconnect and reconnect it. If there is still no change in the display, consult your dealer for advice.

Select "Search for wireless network" or "WPS (PUSH button)" and press [OK], then follow the on-screen instructions and apply the settings.

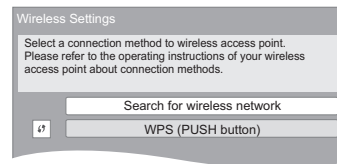

WPS (PUSH button):

If your wireless router supports WPS (PUSH button), you can easily perform the settings by pressing WPS button on it.

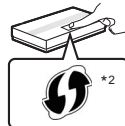

WPS (Wi-Fi Protected Setup™) is a standard that facilitates settings relating to the connection and security of wireless LAN devices.

- ① Press WPS button or corresponding button of the wireless router until the lamp starts flashing.
 - For details, refer to the operating instruction of the wireless router.
- ② Press [OK].

Search for wireless network:

- When you select "Search for wireless network", the available wireless networks will be displayed. Select your network name and press [OK].
 - If your network name is not displayed, search again by pressing the red button on the remote control.
 - Stealth SSID will not be displayed when you select "Search for wireless network". Enter manually by using "Manual setting".
- Press [HOME]
- ⇒ select "Others" and press [OK]
 - ⇒ select "Setup" and press [OK]
 - ⇒ select "Network" and press [OK]
 - ⇒ select "Network Settings" and press [OK]
 - ⇒ select "Wireless Settings" and press [OK]
 - ⇒ select "Connection Setting" and press [OK]
 - ⇒ select "Manual setting" and press [OK]
- If your wireless network is encrypted, Encryption Key input screen will be displayed. Input the encryption key of your network.



- Refer to the operating instructions of the hub or router.
- You can perform this setup anytime by selecting "Easy Network Setting" in the Setup menu. (⇒ 40)
- You can redo these settings individually using "Network Settings". (⇒ 40)
- Do not use this unit to connect to any wireless network for which you do not have usage rights.
During automatic searches in a wireless network environment, wireless networks (SSID) for which you do not have usage rights may be displayed; however, using these networks may be regarded as illegal access.
- After performing network settings on this unit, the settings (encryption level, etc.) of the wireless router might change. When you have trouble getting online on your PC, perform the network settings on your PC in accordance with the settings of the wireless router.
- Please be aware that connecting to a network without encryption may result in the content of the communication being illegitimately viewed by a third party, or the leaking of data such as personal or secret information.

*1 SSID:

An SSID (Service Set IDentification) is a name used by wireless LAN to identify a particular network. Transmission is possible if the SSID matches for both devices.

*2 The wireless router compatible with Wi-Fi Protected Setup™ may have the mark.

Reprogramming the remote control

If you have more than one Panasonic products and the remote control operates both products at once, you will need to change the remote control code to prevent this occurrence. (⇒ 42, "Remote Control")

Firmware updates

Occasionally, Panasonic may release updated firmware for this unit that may add or improve the way a feature operates. These updates are available free of charge.

This unit is capable of checking the firmware automatically when connected to the Internet via a broadband connection.

When a new firmware version is available, the following message is displayed.

New firmware is available.
Please update firmware in Setup.

To update the firmware

Press [HOME]

⇒ **select "Others" and press [OK]**

⇒ **select "Setup" and press [OK]**

⇒ **select "System" and press [OK]**

⇒ **select "Firmware Update" and press [OK]**

⇒ **select "Update Now" and press [OK]**

DO NOT DISCONNECT the unit from the AC power or perform any operation while the update takes place.

After the firmware is installed, "FINISH" will be displayed on the unit's display. Unit will restart and the following screen will be displayed.

The firmware has been updated.
Current Version: x.xx



- If downloading on this unit fails or this unit is not connected to the Internet, then you can download the latest firmware from the following website and burn it to a CD-R to update the firmware.
<http://panasonic.jp/support/global/cs/>
(This site is in English only.)

To show the firmware version on this unit. (⇒ 42, "Firmware Version Information")

- Downloading will require several minutes. It may take longer or may not work properly depending on the connection environment.
- If you do not want to check for the latest firmware version, set "Automatic Update Check" to "Off". (⇒ 42)

Inserting or removing media

e.g., **BTT880**

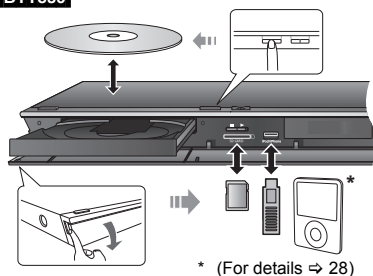

- When inserting a media item, ensure that it is facing the right way up.
- When removing the SD card, press the centre of the card and pull it straight out.
- If you connect a Panasonic product with a USB connection cable, the setup screen may be displayed on the connected equipment. For details, refer to the instructions for the connected equipment.

- **BTT880 BTT480 BTT460 BTT400**

Use the front USB port when you connect a iPod/iPhone, USB memory or a USB HDD. The USB port on the rear panel is only for the following devices:

- Communication Camera
- **BTT480 BTT460 BTT400**
Wireless LAN Adaptor

Enjoying TV with unit's speakers

- 1 Connect the TV and the main unit. (⇨ 16)
- 2 Press **[EXT-IN]** several times to select the appropriate external input mode. (⇨ 23)
 - Reduce the volume on the TV to its minimum, and then adjust the volume of the main unit.

Selecting the type of audio

Press **[AUDIO]** several times to select the audio. (**M1, M2**)

- Set "PCM-Fix" (⇨ 39) to "Off".
- Only works with Dolby Dual Mono.



- You cannot change the audio type when the TV is connected to this unit via the AUX terminal.

HOME menu

Major functions of this unit can be operated from the HOME menu.

Preparation

Turn on the television and select the appropriate video input on the television.

- 1 Press **[ON]** to turn on the unit.
- 2 Press **[▲, ▼, ◀, ▶]** to select the item and press **[OK]**.
 - If there are any other items, repeat this step.

e.g., **BTT880 BTT480 BTT460 BTT400**



EXT IN

When you want to output audio of an external device from this unit, select the name of the terminal to which you have connected the device.

AUX	AUX terminal
ARC	HDMI AV OUT (ARC) terminal
DIGITAL IN	DIGITAL AUDIO IN terminal
BTT880 HDMI IN1 HDMI IN2	HDMI1 IN (CABLE/SAT) and/or HDMI2 IN terminal (⇒ 17)

If audio output from a TV or STB is selected, "(TV)" or "(CABLE/SATELLITE)" is displayed. (⇒ 39)

BTT880 BTT480 BTT460 BTT400

Network

Network Service	Displays the Home screen of VIERA Connect. (⇒ 32)
Home Network	DLNA Client (⇒ 33)
	Media Renderer (⇒ 33)

BTT300

Media Renderer

(⇒ 33)

FM Radio

(⇒ 31)

Videos/Photos/Music

Disc	Play back the contents. (⇒ 25)
SD Card	<ul style="list-style-type: none"> • When multiple contents are recorded, select the types of contents or the title.
USB	

Sound

Select sound quality (equalizer). (⇒ 36)

BTT880 BTT480 BTT460 BTT400

iPod

(⇒ 28)

BTT300

DLNA Client

(⇒ 33)

Others

Setup	(⇒ 37)
SD Card Management	(⇒ 26)
Wallpaper	Changes the background of HOME menu.

To show the HOME menu

Press **[HOME]**.



- Items to be displayed may vary with the media.
- When the selector is switched, it may take time to play back the selected video and/or audio.
- To save on electricity, the unit is turned off automatically if there is no button operation for about 30 minutes when not playing back (such as when paused, displaying the menu, displaying still pictures, etc.).

Multi User Mode

Multi User Mode is a function that enables switching of multiple settings easily.
Up to 4 people can use the unit with their own settings.

The following settings can be personalized.

- The user icon
- The wallpaper of HOME menu
- The audio and picture settings (⇒ 34, 37)

e.g., **BTT880** **BTT480** **BTT460** **BTT400**

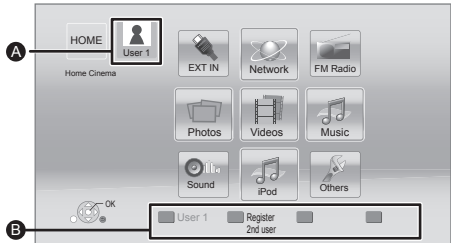

- A** The user name and icon currently selected
- B** Personalize a new user and switch the users with coloured buttons.

Personalizing a new user

- 1 Press [HOME].**
- 2 Press a coloured button that indicates new user personalization.**
- 3 Select an item and change the settings according to the indications.**
The following items can be set.

Input Nickname	Personalize a user name.
Select Icon	Personalize a user icon. Select from Illustrations The image can be selected from prepared illustrations. Create from Photos If the Communication Camera is connected, you can shoot and personalize your photo. <ul style="list-style-type: none">• You can also select a photo in recording media as an icon. (⇒ 34, "Icon Registration")
Select Wallpaper	Personalize a background of the HOME menu. <ul style="list-style-type: none">• Other than prepared wallpapers, you can also select a photo in recording media as a wallpaper. (⇒ 34, "Wallpaper")

Register Smartphone	Smartphone used as a remote control can be registered with respect to each user. <ul style="list-style-type: none">• Multiple users cannot be registered for one smartphone.
----------------------------	--

- 4 Select "Confirm" and press [OK].**
To change the personalized user information
Select "Edit User Information" from Setup menu. (⇒ 42)

Switching the user

There are three ways to switch the user as follows.

- Using coloured buttons**
Press the coloured buttons in the HOME menu to switch to the user corresponding to the button.
- Using facial recognition**
(Only when connected to Communication Camera ⇒ 32)

This is a function for fun using the Communication Camera and enables user switching by facial recognition. Perform "Create from Photos" (⇒ left) to personalize your facial photo before using this function.

- 1 Press [OPTION] in the HOME menu, select "Facial Recognition" and press [OK].**
- 2 Turn the face to Communication Camera.**
The camera captures your face and determines the closest face from the personalized user photos, and then displays the results.
 - Accuracy of the recognition may be reduced depending on the captured image.
- 3 Follow the indications on the screen.**
 - To redo the facial recognition, press [RETURN].

- Using registered smartphones**
When the unit is turned on using the registered smartphone, the user who registered the smartphone will automatically be selected.
 - Perform the "Remote Device Settings". (⇒ 41)

- To use smartphones as a remote control, installation of dedicated software is required. For more details, refer to the following website.
<http://panasonic.jp/support/global/cs/>
(This site is in English only.)

Playback

1 Insert the media.

Playback starts depending on the media.

2 Select the item to play and press [OK].

Repeat this procedure if necessary.



- DISCS CONTINUE TO ROTATE WHILE MENUS ARE DISPLAYED. Press [■STOP] when you have finished playback to protect the unit's motor, your television screen and so on.
- MKV: Successive play is not possible.
- It is not possible to play back AVCHD and MPEG2 video which have been dragged and dropped, copied and pasted to the media.

Operations during playback

Following functions may not work depending on the media and contents.

Stop

Press [■STOP].

The stopped position is memorized.

Resume play function

Press [▶PLAY] to restart from this position.

- The position is cleared if the tray is opened.
- On BD-Video discs including BD-J, the resume play function does not work.

Pause

Press [⏸PAUSE].

- Press [⏸PAUSE] again or [▶PLAY] to restart play.

Search/Slow motion

Search

While playing, press [SEARCH◀◀] or [SEARCH▶▶].

- Music and MP3: The speed is fixed to a single step.

Slow motion

While paused, press [SEARCH◀◀] or [SEARCH▶▶].

- BD-Video and AVCHD: [SEARCH▶▶] only.

The speed increases up to 5 steps.

- Press [▶PLAY] to revert to normal playback speed.

Skip

While playing or paused, press [⏮] or [⏭].

Skip to the title, chapter or track.

Frame-by-frame

While paused, press [◀] (◀◀) or [▶] (▶▶).

- Press and hold to change in succession forward or backward.
- Press [▶PLAY] to revert to normal playback speed.
- BD-Video and AVCHD: [▶] (▶▶) only.

Changing audio

Press [AUDIO].

You can change the audio channel number or soundtrack language, etc.

Displaying menus and playback information

Show top menu/pop-up menu

BTT880 BTT480 BTT460 BTT400

Press **[POP-UP MENU/TOP MENU]**.

BTT300

Press **[TOP MENU]** or **[POP-UP MENU]**.

Select the item and press **[OK]**.

Show the status messages

While playing, press [STATUS].

The status messages give you information about what is currently being played. Each time you press **[STATUS]**, the display information may change or will disappear from the screen.

- Depending on media and contents, the display may change or may not appear.

e.g., BD-Video



A T: Title, C: Chapter, PL: Playlist

B Elapsed time in the title

C Current position

D Total time

e.g., JPEG

Date	11.12.2007	1 / 26
Size	500 x 375	
Manufacturer		
Equipment		

Enjoying 3D video and photos

Preparation

Connect 3D compatible TV to an HDMI AV OUT terminal of this unit using a High Speed HDMI Cable. (⇒ 16, 17)

- Perform the necessary preparations for the TV.
- Play back following the instructions displayed on the screen.
- 3D Settings (⇒ 37, 39)



- Please refrain from viewing 3D images if you do not feel well or are experiencing visual fatigue. In the event that you experience dizziness, nausea, or other discomfort while viewing 3D images, discontinue use and rest your eyes.
- 3D video might not output the way it is set in "HDMI Video Format" or "24p Output" (⇒ 38).
- When playing back 3D photos from "Photos" screen, select from the "3D" list. (Still pictures in "2D" are played back in 2D.) If "2D" and "3D" indications are not displayed, press the red button to switch the view of playback contents.

Enjoying BD-Live

With "BD-Live" discs, you can enjoy bonus contents that use Internet access.

For this BD-Live function, insertion of an SD card is necessary along with Internet connection.

1 Perform network connection and settings.
(⇒ 18, 20)

2 Insert an SD card with 1 GB or more free space.

- The SD card is used as the local storage.

3 Insert the disc.

Deleting data/Formatting SD cards

Select "SD Card Management" in the **HOME** menu (⇒ 23), then select "BD-Video Data Erase" or "Format SD Card" and press **[OK]**.



- The usable functions and the operating method may vary with each disc, please refer to the instructions on the disc and/or visit their website.
- "BD-Live Internet Access" may need to be changed for certain discs (⇒ 41).

Play a slideshow of photos and make various settings during the playback.

- 1 **Insert the media.**
- 2 **Select "Photos".**
- 3 **Select an item and press the green button.**

The following items can be set.

Start Slideshow	Start the slideshow. You can display still pictures in the selected folder one by one at a constant interval.
Interval	Change the display interval.
Transition Effect	Select the effect when sliding pictures.
Repeat Play	Set whether to repeat the slideshow.
Soundtrack	Set whether to play background music. <ul style="list-style-type: none"> You can select the soundtrack from USB device, Music CD and iPod/iPhone. Some media cannot be selected as the source depending on the case.
Soundtrack Folder	Select the folder from which the music files are played.
Random Soundtrack	Background music is played in random order.



- Still pictures displayed as "  " cannot be played back with this unit.
- When a music CD, a USB device with recorded music, and an iPod/iPhone are inserted/connected to this unit, iPod/iPhone has priority to be played back as background music.

BTT880 **BTT480** **BTT460** **BTT400**

Using the iPod/iPhone

Compatible iPod/iPhone (as of December 2012)

- Update your iPod/iPhone with the latest software before using this unit.
- Compatibility depends on the software version of your iPod/iPhone.
- iPod/iPhone compatibility assures music playback and battery charge functions of this unit as a home theatre system.

iPod touch:

1st, 2nd, 3rd, 4th and 5th generation

iPod nano:

1st, 2nd, 3rd, 4th, 5th, 6th and 7th generation

iPod classic

iPod: 5th generation

iPhone 5 / iPhone 4S / iPhone 4 / iPhone 3GS / iPhone 3G / iPhone

BTT880 Underlined models can also be connected to the Dock for iPod/iPhone.



- In some locations, reception status of an iPhone may be poor when it is loaded on this unit.
- When the iPhone receives a call while connected to this unit, playback, etc. of the iPhone may stop. To prioritize the operation with the iPhone connected to this unit, make the setting so that the iPhone does not receive calls.
- Avoid using Wi-Fi mode on your iPhone in the following case.
 - When the network functions on this unit are in use wirelessly.
 - BTT880** When the surround speakers on this unit are in use wirelessly.

About recharging the battery

- iPod/iPhone will not be recharged after the battery charge completion.
- When connecting with a dedicated USB cable
 - iPod/iPhone will start recharging when this unit is on.
- BTT880** "IPOD CHARGING" will be shown on the main unit's display during iPod/iPhone charging in main unit standby mode.
- When connecting to the Dock
 - iPod/iPhone will start recharging regardless of whether this unit is on or off.

iPod/iPhone Connection

Connect the iPod/iPhone to either of the USB port or the Dock (**BTT880** only).

- **BTT880** Only underlined iPod/iPhone on page 27 can be connected to the Dock.

Preparation

- Turn the main unit off or reduce the volume of the main unit to its minimum.

Connecting with a dedicated USB cable

1 Connect the iPod/iPhone.

To purchase a dedicated USB cable, consult your iPod/iPhone dealer.

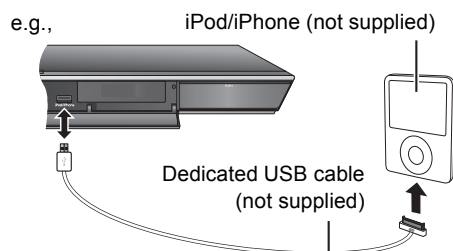

BTT880 Connecting to the Dock

- 1 Push the centre of drawer (**A**), and pull out fully until it clicks to open the dock.

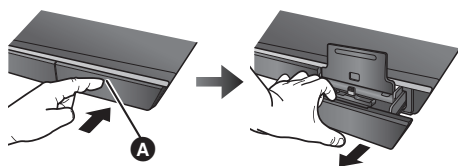

2 Connect the iPod/iPhone firmly.

- Check that the connector (**B**) has no dust or foreign materials before connecting.
- To connect the iPod/iPhone firmly, remove it from the case, etc. before inserting.
- Insert the iPod/iPhone along the backrest (**C**) with the iPod/iPhone display facing out.
- Carefully insert and remove the iPod/iPhone to ensure long lasting product enjoyment.

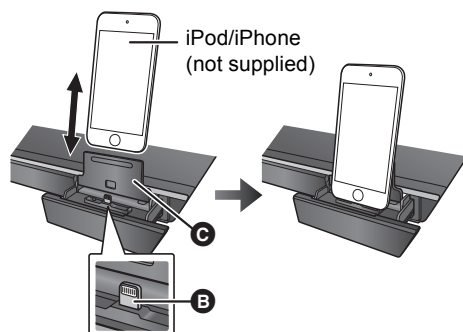

iPod/iPhone Playback

- 1 Press [HOME].
- 2 Select "iPod" and press [OK].
- 3 Select the item to play.
 - Repeat this procedure if necessary.

Album artwork

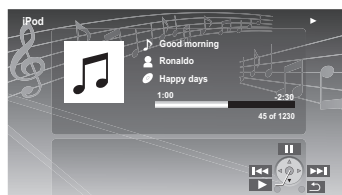

- If album artwork is not contained in the data, "♪" will appear on TV.
- Depending on the software version of your iPod/iPhone, the album artwork may not appear properly.
- Some operations may not work while reading the album artwork.

- The setting of the playback mode will be kept until changes are made on the same iPod/iPhone.
- Surround sound effect and sound mode are available.

VIERA Link “HDAVI Control™”

What is VIERA Link “HDAVI Control”?

VIERA Link “HDAVI Control” is a convenient function which will link the operations of this unit and a Panasonic TV (VIERA) under “HDAVI Control”. You can use this function by connecting the equipment with an HDMI cable. See the operating instructions for connected equipment for operational details.

Preparation

- ① Set “VIERA Link” to “On” (⇒ 42).
(The default setting is “On”.)
- ② Set the “HDAVI Control” operations on the connected equipment (e.g., TV).
- ③ Turn on all “HDAVI Control” compatible equipment and select this unit’s input channel on the connected TV so that the “HDAVI Control” function works properly.

Also, when the connection or settings are changed, repeat this procedure.

Automatic input switching Power on link

When the following operations are performed, the input channel of the television will be automatically switched and the screen of this unit will be displayed.

When the television is off, the television will automatically turn on.

- When play starts on the unit
- When an action that uses the display screen is performed
(e.g., HOME menu)
- This function does not work when the iPod/iPhone selector is chosen. (⇒ 28)

Power Off Link

All connected equipment compatible with “HDAVI Control”, including this unit, automatically turns off when you switch the television off.

Playing music continuously even after turning off the television

When the unit is connected to a Panasonic TV (VIERA) that supports HDAVI Control 2 or later.

Select “Video” in “Power Off Link” (⇒ 42)

Easy control only with VIERA remote control

Only when TV supports “HDAVI Control 2” or later

By using the TV remote control, you can perform various playback operations and settings. See the operating instructions of the TV for more details.



- The buttons that you can use for this unit vary depending on the TV. For details, refer to the operating instructions of the TV.
- The operation of this unit may be interrupted when you press certain buttons on the TV remote control.
- This unit supports “HDAVI Control 5” function. “HDAVI Control 5” is the standard for Panasonic’s HDAVI Control compatible equipment. This standard is compatible with Panasonic’s conventional HDAVI equipment.
- VIERA Link “HDAVI Control”, based on the control functions provided by HDMI which is an industry standard known as HDMI CEC (Consumer Electronics Control), is a unique function that we have developed and added. As such, its operation with other manufacturers’ equipment that supports HDMI CEC cannot be guaranteed.
- Please refer to individual manuals for other manufacturers’ equipment supporting VIERA Link function.

Enjoying TV and STB with unit's speakers

You can select whether audio is output from the unit's speakers or the TV speakers by using the TV menu settings. Switch the audio output setting of the TV to this unit's speakers.

Select the TV audio

When the TV is turned on, this unit will also automatically turn on.

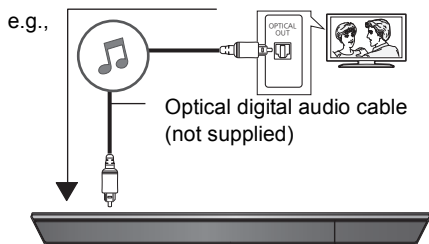

- ① Press [HOME].
- ② Press [▲, ▼, ◀, ▶] to select "Others" and press [OK].
- ③ Press [◀, ▶] to select "Setup" and press [OK].
- ④ Press [▲, ▼] to select "Sound" and press [OK].
- ⑤ Press [▲, ▼] to select "TV Audio Input". and press [OK].
- ⑥ Press [▲, ▼] to switch "AUX", "ARC" or "DIGITAL IN" and press [OK].
 - Select an audio input terminal connected to the unit.



● For details, refer to the operating instructions of the TV.

Select the STB audio

When the STB power is turned on, this unit and the TV will automatically turn on. The video is output from the TV, and the audio is output from the speakers of this unit.

● BTT880

When "HDMI Standby Pass-Through" is set to "Yes" (⇒ 38) this unit will not turn on.

BTT880

Connecting the HDMI cable

- The setting for audio output is not necessary when the unit is connected to the STB with an HDMI cable.

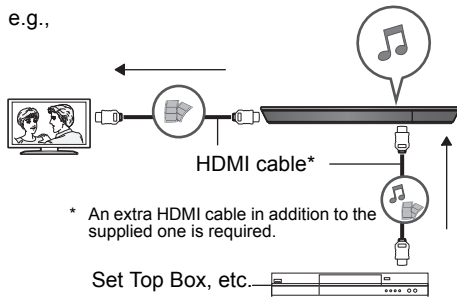

Connecting the optical digital audio cable

- When this unit and the STB are connected by an optical digital audio cable, the settings below are required to enable output of audio from the speakers of this unit.

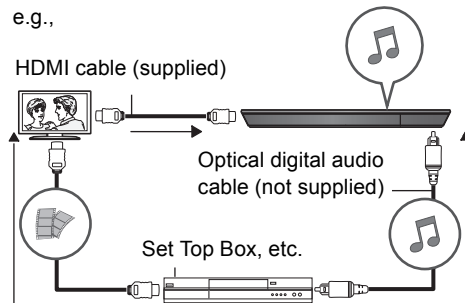

- ① Press [EXT-IN] to select "D-IN".
- ② Press [STATUS] to select "CABLE/ SATELLITE AUDIO ON".

Set to "CABLE/SATELLITE AUDIO OFF" when this unit and the STB are not connected by an optical digital audio cable.

Listening to the Radio

You can preset up to 30 channels.

Preparation

Make sure that the FM antenna is connected. (⇒ 16)

Presetting stations automatically

1 Press [RADIO] to select "FM".

2 Press and hold [STATUS] to select "LOWEST" or "CURRENT".

LOWEST

To begin auto preset with the lowest frequency (FM87.50).

CURRENT

To begin auto preset with the current frequency.*

* To change the frequency, refer to "Manual tuning and presetting".

3 Press and hold [OK].

Release the button when "AUTO" is displayed.

The tuner starts to preset all the stations it can receive into the channels in ascending order.

Listening to a preset channel

1 Press [RADIO] to select "FM".

2 Press the number buttons to select the channel.

To select a 1-digit number

e.g., 1: [1] ⇒ [OK].

To select a 2-digit number

e.g., 12: [1] ⇒ [2].

Alternatively, press [^, v] or [▲, ▼].

Manual tuning and presetting

Select a radio broadcast.

① Press [RADIO] to select "FM".

② Press [SEARCH◀◀] or [SEARCH▶▶] to select the frequency.

- To start automatic tuning, press and hold [SEARCH◀◀], [SEARCH▶▶] until the frequency starts scrolling. Tuning stops when a station is found.

To preset the channel

③ While listening to the radio broadcast Press [OK].

④ While "P" is flashing on the display Press the number buttons to select the channel.



- A station previously stored is overwritten when another station is stored in the same channel preset.
- The radio settings will be shown on the unit's display. (Some settings are also indicated on the TV screen.)

VIERA Connect (Enjoying Internet Service)

VIERA Connect allows you to access some specific websites supported by Panasonic, and enjoy Internet contents such as photos, videos, etc. from VIERA Connect Home screen. This unit has no full browser function and all features of websites may not be available.

VIERA Connect provides a variety of selected Internet services such as the following.

- Online movie rental service
- Video communication service
- Video browsing service

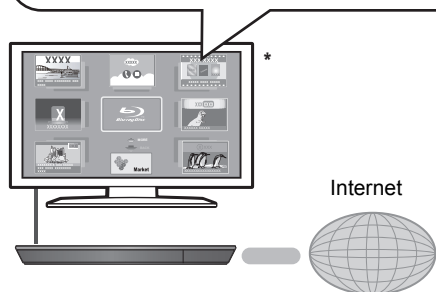

* Images are for illustration purposes, contents may change without notice.

Preparation

- Network connection (⇒ 18)
- Network setting (⇒ 20)

To enjoy video communication (e.g. Skype™):

- Connect this unit with optional Communication Camera (TY-CC20W or TY-CC10W). Depending on your location, this optional camera may not be available. Please consult your local Panasonic dealer for advice.

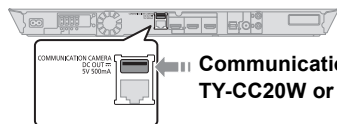

**Communication Camera
TY-CC20W or TY-CC10W.**

- **BTT480 BTT460 BTT400**

When this unit is connected by wireless LAN connection, connect the Communication Camera via the USB port on the front of this unit.

- For operating method refer to the following website.

<http://panasonic.jp/support/global/cs/>
(This site is in English only.)

1 Press [INTERNET].

- The video communication service can be accessed directly by pressing [S] button.

2 Select the item and press [OK].

To exit from VIERA Connect

Press [HOME].



- When playing content in the media, VIERA Connect cannot be accessed by pressing [INTERNET].
- In the following cases, settings are possible using the Setup menu items.
 - When restricting the use of VIERA Connect (⇒ 41, "Network Service Lock")
 - When the audio is distorted (⇒ 40, "Audio Auto Gain Control")
 - When wrong time is displayed (⇒ 40, "Time Zone", "Summer Time")
- If using slow Internet connection, the video may not be displayed correctly. A high speed Internet service with a speed of at least 6 Mbps is recommended.
- Be sure to update the firmware when a firmware update notice is displayed on the screen. If the firmware is not updated, you will not be able to use the VIERA Connect function. (⇒ 21)
- VIERA Connect Home screen is subject to change without notice.
- The services through VIERA Connect are operated by their respective service providers, and service may be discontinued either temporarily or permanently without notice. Therefore, Panasonic will make no warranty for the content or the continuity of the services.
- All features of websites or content of the service may not be available.
- Some content may be inappropriate for some viewers.
- Some content may only be available for specific countries and may be presented in specific languages.

Home Network feature

Playing back contents on the DLNA server

You can share photos, videos and music stored in the DLNA Certified media server (PC with Windows 7 installed, smartphone, etc.) connected to your home network, and enjoy the contents with this home theatre. You can also enjoy viewing the video and photos recorded in Panasonic DLNA compatible recorders (DIGA). Refer to our website about the sales area, etc. (⇒ right)

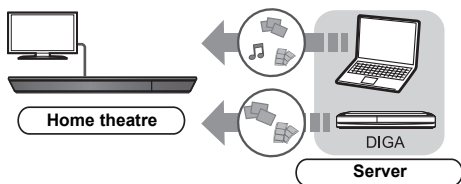

Preparation

- ① Perform network connection (⇒ 18) and network settings (⇒ 20) of this unit.
- ② Perform Home Network settings of the connected equipment.

When connected to other than DIGA,

- ③ Add the contents and folder to the libraries of the Windows Media® Player or the smartphone, etc.
 - Playlist of Windows Media® Player can play back only the contents that are stored in the libraries.

When connected to DIGA,

- ③ Register this unit to your DIGA.

1 Press [HOME].

2 **BTT880 BTT480 BTT460 BTT400**

Select “Network”.

3 **BTT880 BTT480 BTT460 BTT400**

Select “Home Network”.

4 Select “DLNA Client”.

- The list can be updated by pressing the red button on the remote control.
- **BTT880** The connection method can be switched to Wi-Fi Direct by pressing the green button on the remote control.

5 Select the equipment and press [OK].

6 Select the item to play and press [OK].

- You may be able to use convenient functions depending on the content by pressing [OPTION].
- Control Panel (⇒ 35) is displayed once the playback starts. Press [OK] if the Control Panel is not displayed, and press [RETURN] to hide the Control Panel.
- About support format of DLNA client (⇒ 53).

To exit from Home Network

Press [HOME].

Using the Digital Media Controller

You can use the smartphone, etc. as the Digital Media Controller (DMC) to play back contents from DLNA server on the Renderer (this unit).

Possible applications:

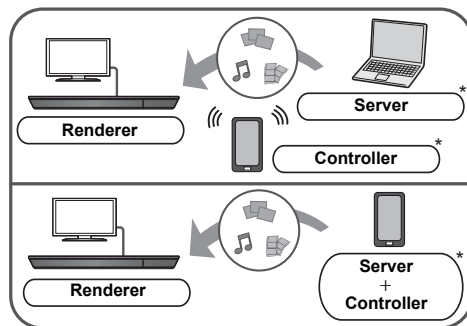

* DMC compatible software should be installed.

Preparation

Perform steps ① and ②. (⇒ left)

- ③ Add the contents and folder to the libraries of the Windows Media® Player or the smartphone, etc.
 - Playlist of Windows Media® Player can play back only the contents that are stored in the libraries.
- ④ Perform the “Remote Device Settings”. (⇒ 41)
 - You can register up to 16 devices.

1 Press [HOME].

2 **BTT880 BTT480 BTT460 BTT400**

Select “Network”.

3 **BTT880 BTT480 BTT460 BTT400**

Select “Home Network”.

4 Select “Media Renderer”.

5 **BTT880**

Select “Home Network” or “Wi-Fi Direct” and press [OK], then follow the indications on the screen.

6 Operate the DMC compatible devices.

To exit from Media Renderer screen

Press [HOME].



For more details, refer to the following website and the operating instructions for each of the equipment.
<http://panasonic.jp/support/global/cs/>
 (This site is in English only.)

- **BTT880** Wi-Fi Direct connection while using Home Network feature is only temporary, and the network connection method returns to the original setting when exiting.
- Depending on the contents and the connected equipment, playback may not be possible.
- Items displayed in grey on the display cannot be played back by this unit.
- This unit can be played back via connected equipment only when controlled using DMC.

Option menu

A variety of playback operations and settings can be performed from this menu.
Available options differ depending on the playing contents and the condition of the unit.

About Multi User Mode

 : Settings of the items with this indication are saved by the respective users registered in the HOME menu.
Please refer to page 24 for details about user registration and switching.

1 Press [OPTION].

e.g., BD-Video

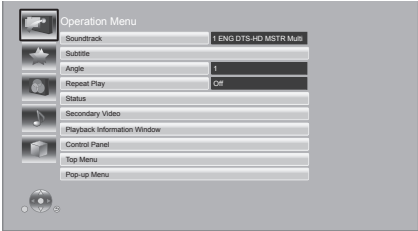

2 Select an item and change the settings.

To exit the screen
Press [OPTION].

Regarding Language: (⇒ 54)

Operation Menu

- Soundtrack

Show or change the soundtrack.
- Audio channel

Select the audio channel number.
- Subtitle

Change the subtitle settings.
- Angle

Select the number of the angle.

- Repeat Play

(Only when the elapsed time is being displayed on the unit's display.)
Select the item that you want to repeat.
 - The items displayed differ depending on the type of media.
 - Select "Off" to cancel.

- Random

Select whether or not to play random.

- Start Slideshow

Start the slideshow.

- Status

Show the status messages.

- Rotate RIGHT

■ Rotate LEFT

Rotate the still picture.

- Wallpaper

Set the still picture to the wallpaper of HOME menu. (⇒ 23)

- Icon Registration

Set the still picture as your user icon. (⇒ 24)



- Video

The recording method of original video appears.

■ Secondary Video	
Video	Select on/off of images. The recording method of original video appears. <ul style="list-style-type: none">• During search/slow motion or frame-by-frame, only the primary video is displayed.
Soundtrack	Select on/off of audio and the language.

■ Playback Information Window

Displays the following.

	Audio/video attribute information of disc.
	Settings status of "Digital Audio Output" (⇒ 38).
	HDMI output information.

Press [RETURN] to exit.

■ Control Panel

Display the Control Panel.

Playing back while using VIERA Link, etc.

e.g.,

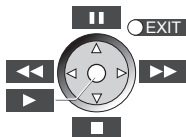

Press [RETURN] to hide the Control Panel.

■ Top Menu

Display Top Menu.

■ Pop-up Menu

Display Pop-up Menu.

■ Menu

Display Menu.

Personal Taste

You can access settings to enjoy special features of this unit from this category.

Refer to "Picture Settings" and "Sound Settings" (⇒ 36) for more details on each setting item.

Picture Settings

■ Picture Mode

Select the picture quality mode during play.

- If you select "User", you can change settings in "Picture Adjustment".

■ Picture Adjustment

Specific picture quality settings can be performed.

● 3D NR:

Reduces the rough noise in the background to give a greater feeling of depth.

When "24p Output" is set to "On", this function may not operate. (⇒ 38)

● Integrated NR:

Smooths block noise and reduces the smudging that appears around contrasting sections of the picture.

■ Chroma Process

The high-resolution processing of HDMI chroma signals produces a high resolution picture with rich picture quality.

■ Detail Clarity

The picture is sharp and detailed.

■ Super Resolution

Pictures of normal image quality are corrected to sharp and detailed images when output as 1080i/1080p from HDMI AV OUT.

■ Progressive

Select the method of conversion for progressive output to suit the type of material being played.

- If the video is disrupted when "Auto" is selected, select either "Video" or "Film" depending on the material to be played back.

■ 24p

Movies and other material recorded on DVD-Video at 24p are output at 24p.

- Only when you have selected "On" in "24p Output" (⇒ 38) and play discs recorded at a rate of 60 fields per second.
- This may not work with the PAL contents.

■ Screen Aspect

Switch the screen mode.

■ Reset to Default Picture Settings

Return picture settings to the factory preset.

Sound Settings

"Surround Effects" and "Sound Effects" can also be set by using the [SURROUND] and [SOUND] on the remote control. (⇒ 44)

■ Surround Effects

➤ BD/DVD (Multi-ch Source):

3D Cinema Surround	Expand the sound field forward, backward, upward, right and leftward providing a sound with depth and force that better matches 3D images.
7.1ch Virtual Surround	You can enjoy 6.1/7.1-channel surround-like effect using 5.1-channel speakers.
2ch Stereo	You can play any source in stereo. Sound will be output to the front speakers and the subwoofer only.

➤ **BTT880 BTT480 BTT460 BTT400**

TV/CD/iPod (2ch Source):

➤ **BTT300**

TV/CD (2ch Source):

Multi Channel Out	You can enjoy sound from the front speakers, as well as the surround speakers even when playing stereo sources.
Super Surround	You can enjoy sound from all speakers with stereo sources.
Dolby Pro Logic II Movie	Suitable for movie software, or the one recorded in Dolby Surround.
Dolby Pro Logic II Music	Adds 5.1-channel effects to stereo sources.

■ Sound Effects*1, 2, 3

➤ **BTT880 BTT480 BTT460 BTT400**

TV/CD/iPod (2ch Source):

➤ **BTT300**

TV/CD (2ch Source):

Re-master:

This feature gives you brighter sound by increasing the high frequency portion of the audio. (Discs recorded at 48 kHz or less)

Recommended setting:

Re-master 1	Pop and rock
Re-master 2	Jazz
Re-master 3	Classical

Digital Tube Sound:

This feature gives you warm sound, like that produced by a vacuum tube amplifier.

Recommended setting:

Digital Tube Sound 1	A crisp, delicate sound
Digital Tube Sound 2	A tight, hi-fi sound
Digital Tube Sound 3	A soft, rich sound
Digital Tube Sound 4	A clear, powerful sound
Digital Tube Sound 5	A distinctive mid-range sound
Digital Tube Sound 6	A soft, enveloping sound

➤ All:

Equalizer	You can select sound quality settings. Flat/Heavy/Clear/Soft
Subwoofer	You can adjust the amount of bass. Level 1 (Weakest effect) to Level 4 (Strongest effect) • Levels can be set by source.
H.Bass	You can enhance low-frequency sound so that heavy bass sound can be heard clearly, even if the acoustics of your room are not optimal.
Whisper-Mode Surround	You can enhance the surround effect for low volume sound. (Convenient for late night viewing.)
Centre Focus	You can make the Centre channel sound seem like it is coming from within the TV.

■ High Clarity Sound Plus

When playing back music contents, it improves the sound quality by stopping the video output.

*1 Not every function can be set individually.

*2 When audio is output from the HDMI AV OUT terminal this function is effective only when "Dolby D/Dolby D +/Dolby TrueHD" or "DTS/DTS-HD" is set to "PCM". (⇒ 38)

*3 This function has no effect when the type of audio is Dolby Pro Logic II.

3D Settings

■ Signal Format

Original	Keep original picture format.
Side by side	3D picture format comprising of left and right screens.
2D to 3D	Converts 2D pictures to 3D effect.

■ 3D Picture Mode

Normal	Play back pictures with normal 3D effects.
Soft	You can enjoy 3D pictures with a feeling of broadness, holding back the depth perception.
Manual	Play back 3D pictures with settings of "Manual Settings".

■ Manual Settings

Distance	Set the amount of depth perception.
Screen Type	Selects how the screen appears during 3D playback (flat or round).
Frame Width	Set the amount of feathering at the edge of screen.
Frame Colour	Set the colour of feathering at the edge of screen.

■ Graphic Display Level

(Only when "Full HD" is selected in "3D Type" (⇒ 39).)

3D position for the Option menu or message screen, etc. can be adjusted during 3D playback.

Setup menu

Change the unit's settings if necessary. The settings remain intact even if you switch the unit to standby.

Some items in the Setup menu are common to the Option menu. You can get the same effect with both menus.

About Multi User Mode

 : Settings of the items with this indication are saved by the respective users registered in the HOME menu.

Please refer to page 24 for details about user registration and switching.

- 1 Press [HOME].
- 2 Press [▲, ▼, ◀, ▶] to select "Others" and press [OK].
- 3 Press [◀, ▶] to select "Setup" and press [OK].

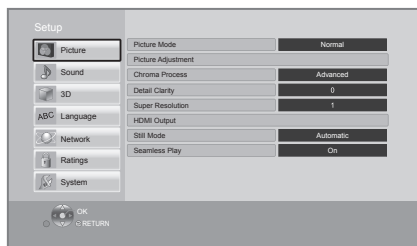

- 4 Select an item and change the settings.

To exit the screen

Press [HOME].

Picture

■ Picture Mode  (⇒ 35)

■ Picture Adjustment  (⇒ 35)

■ Chroma Process  (⇒ 35)

■ Detail Clarity  (⇒ 35)

■ Super Resolution  (⇒ 35)

■ HDMI Output

Press [OK] to show the following settings:

➤ HDMI Video Format

The items supported by the connected devices are indicated on the screen as “*”. When any item without “*” is selected, the images may be distorted.

- If “Automatic” is selected, the best suited output resolution to the connected television is automatically selected.
- To enjoy high-definition video up-converted to 1080p, you need to connect the unit directly to 1080p compatible HDTV (High Definition Television). If this unit is connected to an HDTV through other equipment, the other equipment must also be 1080p compatible.

➤ 24p Output

When this unit is connected to a TV supporting 1080/24p output using an HDMI cable, movies and other material recorded at 24p are output at 24p.

- When playing DVD-Video, set to “On” and then set “24p” in “Picture Settings” (⇒ 35) to “On”.
- When BD-Video images other than 24p are played, images are output at 60p.
- 24p: A progressive image recorded at a rate of 24 frames per second (motion-picture film). Many BD-Video movie contents are recorded in 24 frames/second in accordance with the film materials.

➤ HDMI Colour Mode

This setting is for selecting colour-space conversion of the image signal when the unit is connected using an HDMI cable.

➤ Deep Colour Output

This setting is for selecting whether to use Deep Colour output when a television that supports Deep Colour is connected.

➤ Contents Type Flag

Depending on the playback content, the TV will output adjusting to the optimal method when a TV that supports this function is connected.

➤ **BTT880** HDMI Standby Pass-Through

Even if this unit is in standby mode, a device connected with this unit can output videos and sound to the TV.

Moreover, you can switch the HDMI input terminal by pressing [EXT-IN] on the remote control.

- Sound will not be output from this unit's speakers.

■ Still Mode

Select the type of picture shown when you pause playback.

Automatic	Automatically selects the type of picture shown.
Field	Select if jittering occurs when “Automatic” is selected.
Frame	Select if small text or fine patterns cannot be seen clearly when “Automatic” is selected.

■ Seamless Play

The chapter segments in playlists are played seamlessly.

- Select “On” when the picture freezes for a moment at the chapters segment in playlists.

Sound

■ Surround Effects (⇒ 36)

■ Sound Effects (⇒ 36)

■ Dynamic Range Compression

You can listen at low volumes but still hear dialogue clearly.

(Dolby Digital, Dolby Digital Plus and Dolby TrueHD only)

- “Automatic” is effective only when playing Dolby TrueHD.

■ Digital Audio Output

Press [OK] to show the following settings:

➤ Dolby D/Dolby D +/Dolby TrueHD

➤ DTS/DTS-HD

➤ MPEG Audio

Select the audio signal to output.

- Select “PCM”, when the connected equipment cannot decode the respective audio format. This unit decodes the audio format and transmits to the connected equipment.
- Not making the proper settings may result in noise.

➤ **BD-Video Secondary Audio**

Select whether or not to mix the primary and secondary audio (including the button click sound).

If "Off" is selected, the unit outputs the primary audio only.

➤ **HDMI Audio Output**

This setting selects whether or not to output audio from HDMI.

- Audio will be output through the system's speakers when "Off" is selected.

■ **Digital Audio Input**

Press [OK] to show the following settings:

➤ **PCM-Fix**

Selects the audio output from the devices connected to this unit.

- "On": PCM is available.
- "Off": DTS, PCM and Dolby Digital are available.

Select "On" if the sound is cut off intermittently.

■ **TV Audio Input**

Select the TV audio input to work with the VIERA Link operations.

■ **Downmix**

Select the downmix system of multi-channel to 2-channel sound.

- Select "Surround encoded" to enjoy the surround sound.
- There is no downmix effect on the bitstream audio signal.
- The audio will be output in "Stereo" in the following cases:
 - AVCHD playback
 - Dolby TrueHD playback
 - Playback of secondary audio (including the button click sound).

■ **Audio Delay**

Synchronization between picture and sound is corrected by adjusting the delay time of the audio output.

■ **Speaker**

Refer to page 43.

3D

■ **3D BD-Video Playback**

Select the playback method of 3D compatible video software.

■ **3D AVCHD Output**

Select the output method of 3D AVCHD videos.

■ **3D Type**

Select the format of the connected TV.

- Change the settings for 3D on the TV also when "Side by side" is selected.

■ **3D Playback Message**

Set to display or hide the 3D viewing warning screen when playing back the 3D compatible video software.

■ **Manual Settings** (⇒ 37)

■ **Graphic Display Level** (⇒ 37)

Language

■ Soundtrack Preference

Choose the language for audio.

- If "Original" is selected, the original language of each disc will be selected.
- Enter a code (⇒ 54) when you select "Other ****".

■ Subtitle Preference

Choose the language for the subtitle.

- If "Automatic" is selected and the language selected for "Soundtrack Preference" is not available, subtitles of that language will automatically appear if available on that disc.
- Enter a code (⇒ 54) when you select "Other ****".

■ Menu Preference

Choose the language for the disc menus.

- Enter a code (⇒ 54) when you select "Other ****".

Except South East Asia

■ Subtitle Text

Select a suitable item according to the language used for MKV subtitles text.

- This item is displayed only after playing back a file.

For South East Asia

■ On-Screen Language

Choose the language for menus and on-screen messages.

Network

■ Easy Network Setting (⇒ 20)

■ Network Settings

Perform network-related settings individually.
Press [OK] to show the following settings:

➤ LAN Connection Mode

Select the LAN connection method.

● **BTT880**

Select "Wireless Master" when you make a direct wireless connection between this unit and a Home Network device. Internet connection is not available when this item is selected.

➤ Wireless Settings

This allows the wireless router and connection settings to be set. Current connection settings and connection state can be checked.

Connection Setting

The wireless router connection wizard will be displayed.

Double Speed Mode Setting (2.4GHz)

Set the connection speed.

- If you connect using the "Double Speed Mode (40MHz)", 2 channels use the same frequency band, and there is consequently a greater risk of reception interference. This can cause the connection speed to drop or become unstable.

➤ IP Address / DNS Settings

This is for checking the state of the network connection and setting the IP address and DNS-related.

Press [OK] to show the respective setting.

➤ Proxy Server Settings

This is for checking the state of connection with the Proxy server and performing settings.
Press [OK] to show the respective setting.

➤ **BTT880 BTT480 BTT460 BTT400**

Network Service Settings (⇒ 32) (VIERA Connect)

Press [OK] to show the following settings:

Audio Auto Gain Control

Volume that is different depending on the contents is adjusted automatically to the standard volume while using the VIERA Connect.

- Depending on contents, this function effect will not work.
- Select "Off" when the audio is distorted.

Time Zone

By selecting the time zone, it is possible to set the unit's time to match your location.

- Some VIERA Connect contents require the time zone to be set. Set the time zone if necessary.

Summer Time

Select "On" when using Daylight Saving time.

Except South East Asia

➤ Network Drive Connection

It is possible to access the shared folder of equipment not compatible with DLNA, such as the Windows XP operating system, and play back video, still pictures, and music on this unit. For the setting and operation method of connected equipment, refer to the following website.

<http://panasonic.jp/support/global/cs/>
(This site is in English only.)

➤ Remote Device Settings (⇒ 33)

Press [OK] to show the following settings:

Remote Device Operation

Enable to operate by DMC.

- If "On" is selected, "Quick Start" is fixed to "On".

Device Name Entry

Set the name of this unit to be displayed on the connected equipment.

Registration Type

Automatic	Allow connection to all the equipment that is accessing this unit.
Manual	Set the permission of the connection individually for the equipment that is accessing this unit.

Remote Device List

Registering/deregistering of the displayed equipment can be performed when "Manual" in "Registration Type" is selected.

➤ BD-Live Internet Access (⇒ 26)

You can restrict Internet access when BD-Live functions are used.

- If "Limit" is selected, Internet access is permitted only for BD-Live contents which have content owner certificates.

Ratings

The following items use the same password. Don't forget your password.

■ DVD-Video Ratings

Set a ratings level to limit DVD-Video play.

■ BD-Video Ratings

Set an age limit of BD-Video play.

■ BTT880 BTT480 BTT460 BTT400

Network Service Lock

You can restrict the usage of VIERA Connect.

System

■ Easy Setting



You can execute basic settings.

■ TV Settings

Press [OK] to show the following settings:

➤ TV Aspect

Set to match the type of television connected. When connected to a 4:3 aspect television and playing 16:9 ratio image:

4:3	The sides are cut off so the picture fills the screen. When playing BD-Video, video is output as "4:3 Letterbox". 
4:3 Letterbox	Black bands appear at the top and bottom of the picture. 

When connected to a 16:9 widescreen television and playing 4:3 ratio image:

16:9	Video is displayed as a 4:3 ratio image in the centre of the screen.
-------------	--

➤ TV System

Perform the setup so it matches the TV System of the connected TV.

➤ Screen Saver Function

This is to prevent burn-in on the screen.

- When this is set to "On":
If a list of playback content is displayed and there is no operation for 10 minutes or more, the screen switches to HOME menu automatically.
- While playing and pausing, etc., this function is not available.

➤ On-Screen Messages

Choose whether to show status messages automatically.

➤ VIERA Link

Set to use "HDAVI Control" function when connected via HDMI cable to a device that supports "HDAVI Control".

- Select "Off" when you do not want to use "HDAVI Control".

➤ Power Off Link

Select the desired power off link setting of this unit for VIERA Link operation (⇒ 29). (This works depending on the settings of the connected VIERA Link "HDAVI Control" compatible equipment.)

Video/Audio

When the TV is turned off, this unit will turn off automatically.

Video

When playing back audio only content, the unit will not turn off automatically.

■ Unit Settings

Press [OK] to show the following settings:

➤ Front Panel Display

Changes the brightness of the unit's display.

- If "Automatic" is selected, the display is set to bright and only dimmed during playback.

➤ Edit User Information

Change the user information registered in the HOME menu.

■ Quick Start

Speed of startup from standby mode is increased.

- When set to "On", the internal control unit will be powered and the idle power consumption will increase so compared to when set to "Off".

■ Remote Control

Change the remote control code if other Panasonic products react to this remote control.

■ Firmware Update (⇒ 21)

Press [OK] to show the following settings:

➤ Automatic Update Check

When this equipment remains connected to the Internet, it will check for the latest firmware version when it is turned on and you can update it if necessary.

➤ Update Now

You can update the firmware manually if a firmware update is available.

■ System Information

Press [OK] to show the following settings:

➤ Software Licence

Information about the software used by this unit is displayed.

➤ Firmware Version Information

Display firmware version of this unit and wireless LAN module.

■ Default Settings

This returns all values in the Setup menu and the Option menu to the default settings, except for some settings of network, ratings, remote control code, language, etc.

Speaker settings

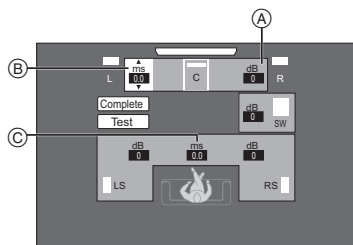

- (A) Volume (Channel balance)
- (B) Delay time for the Centre speaker
- (C) Delay time for the Surround and Surround back speakers*

* Surround back speakers: optional (⇒ 12)

Adjusting speaker level

(Effective when playing multi-channel audio)

1 Select "Test" and press [OK].

A test signal is output.

2 While listening to the test signal

Press [▲, ▼] to adjust the volume of each speaker ().

The volume can be adjusted between +6 dB to -6 dB.

- Set each speaker level according to the volume of the Front (L) and Front (R) speaker volume respectively.

3 Press [OK].

The test signal stops.

Delay time

For optimum listening with 5.1-channel sound, all the speakers, except for the subwoofer, should be the same distance from the seating position.

If either distance ① or ② is less than ③, measure the distance and adjust the time to make up for the difference (see the table below).

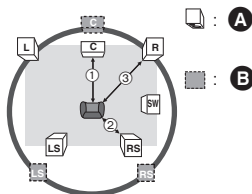

① ② ③: Primary listening distance

(A) Actual speaker position

(B) Ideal speaker position

1 Press [▲, ▼, ◀, ▶] to select the distance

box () and press [OK].

2 Press [▲, ▼] to select the setting and

press [OK].

Delay time for the Centre speaker

Subtract the distance ① from ③

Distance (Approx.)	Setting
34 cm	1.0 ms
68 cm	2.0 ms
102 cm	3.0 ms
136 cm	4.0 ms
170 cm	5.0 ms

Delay time for the Surround and Surround back speakers

Subtract the distance ② from ③

Distance (Approx.)	Setting
170 cm	5.0 ms
340 cm	10.0 ms
510 cm	15.0 ms

To finish the speaker setting

Press [▲, ▼, ◀, ▶] to select "Complete" and press [OK].

Changing the sound settings

For more details on each setting, refer to "Sound Settings" on the Option menu. (⇒ 36)

Surround Effects

- ① Press [SURROUND].
- ② Press [▲, ▼] to select "MULTI CH SOURCE" or "2CH SOURCE", and then press [OK].
e.g.,



- ③ While the mode is displayed
Press [▲, ▼] to select the desired setting.
(⇒ 36)

■ Adjusting speaker level during play

- ① Press [CH SELECT] to activate the speaker setting mode.
- ② Press [CH SELECT] several times to select the speaker.
 - Press [◀, ▶] to adjust the balance of the front speakers.
- ③ Press [▲] (increase) or [▼] (decrease) to adjust the speaker level for each speaker.
-6 dB to +6 dB

Sound Effects

- ① Press [SOUND].
- ② Press [▲, ▼] to select "2CH SOURCE" or "ALL SOURCE", and then press [OK].
e.g.,



- ③ While the mode is displayed
Press [▲, ▼] to select the desired setting and press [OK].
Repeat this procedure if necessary. (⇒ 36)



- The sound effects/modes may not be available or have no effect with some sources.
- You may experience a reduction in sound quality when these sound effects/modes are used with some sources. If this occurs, turn the sound effects/modes off.

Speaker installation option

Consult a qualified building contractor when attaching the speakers to a wall. Improper attachment may result in damage to the wall and speakers and personal injury.

Attaching to a wall

You can attach all of the speakers (except subwoofer) to a wall.

- The wall or pillar on which the speakers are to be attached should be capable of supporting 10 kg per screw.

1 Drive a screw (not supplied) into the wall.

- A** At least 30 mm
- B** Ø 4.0 mm
- C** Ø 7.0 mm to Ø 9.4 mm
- D** Wall or pillar
- E** 5.5 mm to 7.5 mm

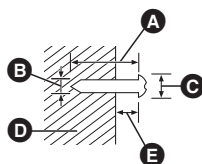

2 Fit the speaker securely onto the screw(s) with the hole(s).

e.g., **BTT880 BTT480 BTT460** Front speaker

DO NOT	DO
<ul style="list-style-type: none"> ● In this position, the speaker will likely fall if moved to the left or right. 	<ul style="list-style-type: none"> ● Move the speaker so that the screw is in this position.

Use the measurements indicated below to identify the screwing positions on the wall.

- Leave at least 20 mm of space above the speaker and 10 mm on each side to allow enough space for fitting the speaker.

BTT880 BTT480 BTT460 BTT400

Centre speaker

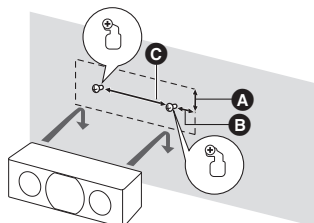

- A** 17 mm
- B** 52 mm
- C** 175 mm

BTT300 Centre speaker

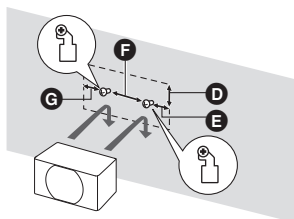

D 18 mm **E** 24 mm **F** 95.5 mm **G** 27 mm

BTT880 **BTT480**

Front speaker, Surround speaker

BTT460 Front speaker

Attach to a wall without the base and the stand.

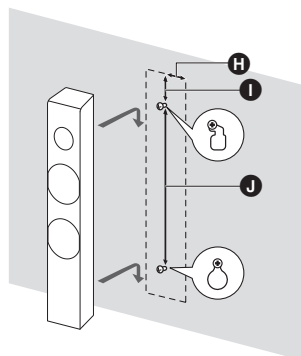

H 45 mm **I** 22 mm **J** 330 mm

- Reattaching the speaker cable to the stand

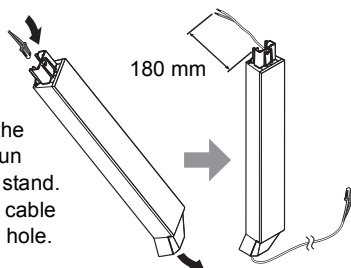

BTT460 Surround speaker

BTT400 Front speaker, Surround speaker

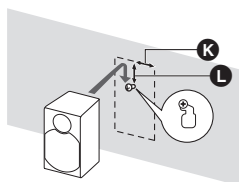

K 40 mm **L** 41 mm

BTT300 Front speaker, Surround speaker

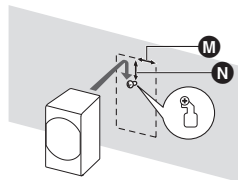

M 40 mm **N** 24 mm

To prevent tipping/falling of the speakers

Preventing tipping

BTT880 **BTT480** Front speaker, Surround speaker

BTT460 Front speaker

Preventing falling

Front speaker, Surround speaker, Centre speaker

1 Thread a string to the speaker.

- Use a string of less than \varnothing 2.0 mm, which is capable of supporting over 10 kg.

e.g., **BTT880** **BTT480** **BTT460** Front speaker

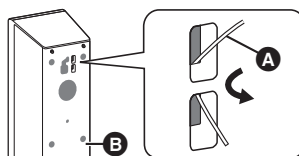

A String (not supplied)

B Rear of the speaker

2 Thread a string from the wall to the speaker and tie tightly.

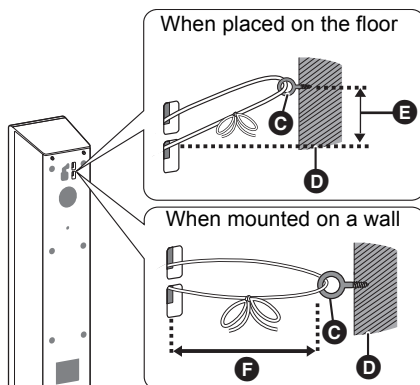

C Screw eye (not supplied)

D Wall or pillar

E Approx. 150 mm

F Approx. 120 mm

Troubleshooting guide

Before requesting service, please perform the following checks.

If the problem remains unresolved, consult your dealer for instructions.

Do you have the latest firmware installed?

Firmware updates may be released to correct operating irregularities that are discovered with certain movies. (⇒ 21)

The following do not indicate a problem with this unit:

- Regular disc rotating sounds.
- Image disturbance during search.
- Image disturbance when replacing 3D discs.

■ Unit does not respond to remote control or front panel buttons.

Press and hold [⏻/I] on the main unit for 3 seconds.

- If still unable to turn the unit off, disconnect the AC mains lead, wait 1 minute, then reconnect the AC mains lead.

■ Cannot eject disc.

The unit may have a problem.

- ① Turn the unit off.
- ② Press and hold [OK], the yellow button and the blue button on the remote control at the same time for more than 5 seconds.
 - “00 RET” is displayed on the unit's display.
- ③ Repeatedly press [▶] (right) on the remote control until “06 FTO” is displayed on the unit's display.
- ④ Press [OK].

General operation

To return to the factory preset.

- Select “Yes” in “Default Settings” in the Setup menu. (⇒ 42)

To return all settings to the factory preset.

- Reset the unit as follows:
 - ① Turn the unit off.
 - ② Press and hold [OK], the yellow button and the blue button on the remote control at the same time for more than 5 seconds.
 - “00 RET” is displayed on the unit's display.
 - ③ Repeatedly press [▶] (right) on the remote control until “08 FIN” is displayed on the unit's display.
 - ④ Press and hold [OK] for at least 3 seconds.

This unit is turned off when the input for the TV is switched.

- This is a normal phenomenon when using VIERA Link (HDAVI Control 4 or later). For details please read the operating instructions for the TV.

The remote control does not work properly.

- Change the batteries in the remote control. (⇒ 9)
- The remote control and main unit are using different codes. If “SET □” is displayed on the unit's display when a button is pressed on the remote control, change the code on the remote control. (⇒ 42, 50)

The TV tuner mode is not displayed when the TV is switched on.

- This phenomenon may occur, depending on the TV setting, when “Quick Start” is set to “On”.
- Depending on the TV, this phenomenon may be prevented by reconnecting the HDMI cable to a different HDMI input terminal or by changing the HDMI auto connection setting.

You have forgotten your ratings password. You want to cancel the ratings level.

- The ratings level returns to the factory preset.
 - ① Turn the unit on.
 - ② Press and hold [OK], the yellow button and the blue button on the remote control at the same time for more than 5 seconds.
 - “00 RET” is displayed on the unit's display.
 - ③ Repeatedly press [▶] (right) on the remote control until “03 VL” is displayed on the unit's display.
 - ④ Press [OK].

This unit does not recognize the USB connection correctly.

- Disconnect and reconnect the USB cable. If it still does not recognize the connection, turn this unit off and on again.
- USB devices may not be recognized by this unit when connected using the following :
 - a USB hub
 - a USB extension cable other than the supplied with the Wireless LAN Adaptor DY-WL5 (optional)
- If you connect USB HDD to this unit, use the USB cable that is supplied with the HDD.

The unit switches to standby mode.

- This unit will automatically turn to standby mode after 30 minutes if it is inactive. (⇒ 23)
- When the time set for the sleep timer has passed, the main unit will be turned off. (⇒ 9)
- One of the unit's safety devices is activated. Press [⏻/I] on the main unit to turn the unit on.

The unit does not turn off.

- ① Press and hold [⏻/I] on the main unit for 3 seconds. (If still unable to turn the unit off, disconnect the AC mains lead, wait 1 minute, then reconnect the AC mains lead.)
- ② Reset the unit as follows:
While the unit is off, press and hold [VOL +], [▲ OPEN/CLOSE] and [⏻/I] on the main unit at the same time for more than 5 seconds.

Picture

The images from this unit do not appear on the TV.

Picture is distorted. Jittering occurs.

- An incorrect resolution is selected in "HDMI Video Format". Reset the setting as follows:

- ① Turn the unit on.
- ② Press and hold [OK], the yellow button and the blue button on the remote control at the same time for more than 5 seconds.
– "00 RET" is displayed on the unit's display.
- ③ Repeatedly press [▶] (right) on the remote control until "04 PRG" is displayed on the unit's display.
- ④ Press and hold [OK] for at least 3 seconds. Set the item again. (⇒ 38)
– When Dolby Digital Plus, Dolby TrueHD, and DTS-HD audio are not output properly, select "Yes" in "Default Settings" and make proper settings. (⇒ 42)

- The unit and television are using different video systems.

- ① Turn the unit on.
- ② Press and hold [OK], the yellow button and the blue button on the remote control at the same time for more than 5 seconds.
– "00 RET" is displayed on the unit's display.
- ③ Repeatedly press [▶] (right) on the remote control until "05 P/N" is displayed on the unit's display.
- ④ Press and hold [OK] for at least 3 seconds. The system switches from PAL to NTSC or vice versa.

- The system used on the disc doesn't match your television.
 - PAL discs cannot be correctly viewed on an NTSC television.
- When "3D BD-Video Playback" in the Setup menu is set to "Automatic", images may not be output depending on the connection method. After removing the disc from this unit, select "Set before play" in the Setup menu, and select "2D Playback" in the setup screen displayed when playing 3D discs. (⇒ 39)
- If irregular colouring occurs on your TV, turn the TV off for about 30 minutes. If it persists, move the speakers further away from the TV.

Video is not output in high-definition.

- Confirm that "HDMI Video Format" in the Setup menu is set properly. (⇒ 38)

3D video is not output.

- Change the settings as required by the connected TV format. (⇒ 39, "3D Type")
- Are the settings on this unit and the TV correct? (⇒ 26)
- Depending on the connected TV, the video being played back might switch to 2D video due to changes in resolution etc. Check the 3D setting on the TV.
- Check that proper HDMI video input is selected on the TV.

3D video is not output correctly as 2D.

- Select "Set before play" in the Setup menu, and select "2D Playback" in the setup screen displayed when playing 3D discs. (⇒ 39, "3D BD-Video Playback")
- Discs that have recorded titles with Side by side (2 screen structure) and that can be enjoyed in 3D are played back in accordance with the settings of the TV.

A black band is displayed around the edge of the screen.

The aspect ratio of the screen is abnormal.

- Confirm the "TV Aspect" is set properly. (⇒ 41)
- Adjust the aspect setting on the television.

Sound

No sound.

Low volume.

Distorted sound.

Cannot hear the desired audio type.

- Check connections to speakers and other equipment. (⇒ 13–19)
- Ensure the speaker settings for your speakers are correct. (⇒ 43)
- To output audio from a device connected with an HDMI cable, set “HDMI Audio Output” to “On” in the Setup menu. (⇒ 39)
- When “BD-Video Secondary Audio” is set to “On”, Dolby TrueHD, Dolby Digital Plus, DTS-HD Master Audio and DTS-HD High Resolution Audio are output as Dolby Digital or DTS Digital Surround.
- Re-master will not work when the bitstream signal is output from the HDMI AV OUT terminal. (⇒ 36)
- Depending on the connected equipment, the sound may be distorted if this unit is connected with an HDMI cable.
- The multi-channel audio from a device connected to the TV is not output in its original multi-channel form.
 - If the device has an optical audio output terminal, connect the device to this unit’s DIGITAL AUDIO IN terminal. (⇒ 17)

No surround sound.

- Press [SURROUND] to select a surround effect. (⇒ 44)
- **BTT880**
Ensure that the surround selector switch of the wireless system is set in the centre position. Then, turn the wireless system off and then back on.
- **BTT880**
(When using the 7.1ch speaker system)
Audio is not available from the surround back speakers (optional) even though Dolby Pro Logic II turns on.

Cannot switch audio.

- When audio is output from the HDMI AV OUT terminal, set “Dolby D/Dolby D +/Dolby TrueHD”, “DTS/DTS-HD” or “MPEG Audio” to “PCM”. (⇒ 38)

No sound from the TV.

- Press [EXT-IN] to select the corresponding source. (⇒ 22)
- When connecting the unit to a TV using an HDMI cable, check whether the HDMI terminal on the TV is labelled “HDMI (ARC)”. If not labelled in this way, connect using the HDMI cable in combination with an optical digital audio cable. (⇒ 16)
- If there is no sound from the equipment connected to this unit’s DIGITAL AUDIO IN terminal, please make sure that the optical audio output of the equipment is set to PCM.

Playback

Disc cannot be played.

- The disc is dirty. (⇒ 6)
- The disc is not finalized. (⇒ 8)

Still pictures (JPEG) do not play back normally.

- The images that were edited on the PC, such as Progressive JPEG, etc., may not be played back.

I can’t play back BD-Live.

- The SD card is write-protected. (⇒ 8)
- Confirm that this unit is connected to the broadband Internet. (⇒ 18)
- Confirm the “BD-Live Internet Access” settings. (⇒ 41)
- Confirm an SD card is inserted into the SD card slot. (⇒ 22)

Alternative soundtrack and subtitles cannot be selected.

- The languages are not recorded on the disc.
- You may not be able to use the Option menu to change the soundtrack and subtitles on some discs. Use the disc’s menus to make changes. (⇒ 26)

iPod/iPhone operation

Cannot charge or operate.

- Check that the iPod/iPhone is connected firmly. (⇒ 28)
- **BTT880** When iPod/iPhone devices are connected to both the USB port and the Dock, disconnect both of them, and then connect only the one you want to play back.
- The battery of the iPod/iPhone is depleted. Charge the iPod/iPhone, and then operate again.
- When unexpected operation occurs while using the iPod/iPhone, connect the iPod/iPhone again or try to restart the iPod/iPhone.

Radio

Distorted sound or noise is heard.

- Adjust the position of the antenna.

A beat sound is heard.

- Try to keep a certain amount of distance between the antenna and the TV.

Noise is excessive.

- Change the audio to be output as monaural. Press [AUDIO] to select "MONO". The sound becomes monaural.
 - To cancel, press the button again or change the frequency.

In normal circumstances, select "AUTO STEREO".

BTT880 Wireless system (SH-FX71)

The wireless link indicator is flashing.

- There is no link between the main unit and the wireless system. Turn the wireless system off and then back on. Alternatively, turn the wireless system off, disconnect the AC mains lead and then reconnect it.

The wireless link indicator does not light.

- Check that the main unit is turned on, and the wireless system is turned on.
- Ensure that the digital transmitter is fully inserted into the slot of the main unit. (⇒ 17)

The wireless link indicator keeps flashing between red and green.

- There is a power supply problem. Consult the dealer.

Network

I can't connect to the network.

- Confirm the network connection and settings. (⇒ 18, 20, 40)
- There may be obstacles that prevent the unit from detecting your home network. Bring the unit and the wireless router closer to each other.
- Check the operating instructions for each device and connect accordingly.

When using wireless LAN connection, video from the DLNA Certified media server is not played back or video frames are dropped during playback.

- Higher transfer rate router such as 802.11n (2.4 GHz) wireless router may solve the problem. If you use 802.11n (2.4 GHz) wireless router, it is necessary to set the encryption type to "AES". Simultaneous use with a microwave, cordless telephone etc. at 2.4 GHz may result in connection interruptions or other problems.
- On the "Wireless Settings" screen (⇒ 40), the continuous lighting of at least 4 "Reception" indicators is the target for a stable connection. If 3 or fewer indicators are lit or the connection is being interrupted, change the position or angle of your wireless router and see if the connection state improves. If there is no improvement, connect to a wired network and perform the "Easy Network Setting" (⇒ 20) again.

Messages

The following messages or service numbers may appear on the TV or unit's display.

On the television

Cannot play.

- You inserted an incompatible disc.

Cannot play on this unit.

- You tried to play a non-compatible image.
- Confirm "SD" on the unit's display is not displayed and re-insert the card.

No disc inserted.

- The disc may be upside down.

⊘ This operation is not available.

- Some operations are unsupported by the unit. (For example, reverse slow-motion, etc.)

IP address is not set.

- The "IP Address" in "IP Address / DNS Settings" is "----. ---. ---. ---". Set the "IP Address", "Subnet Mask", and "Gateway Address". (Select the automatic address acquisition if necessary.)

The wireless access point currently has a low network security setting. It is recommended to change to a higher setting.

- Set a stronger network security level referring to the wireless router operating instructions.

On the unit's display

F99

- The unit fails to operate properly. Press [⏻/I] on the main unit for 3 seconds to switch the unit to standby, then switch back on.

NET

- While connecting to a network.

No PLAY

- There is a viewing restriction on a BD-Video or DVD-Video. (⇒ 41)

No READ

- The media is dirty or badly scratched. The unit cannot play.

PLEASE WAIT

- The unit is carrying out internal process. This is not a malfunction. You cannot operate the unit while "PLEASE WAIT" is displayed.

REMOVE

- The USB device is drawing too much power. Remove the USB device.

SET □

("□" stands for a number.)

- The remote control and main unit are using different codes. Change the code on the remote control.

Press and hold [OK] and the indicated number button at the same time for more than 5 seconds.



U59

- The unit is hot.
The unit switches to standby for safety reasons. Wait for about 30 minutes until the message disappears.
Select a position with good ventilation when installing the unit.

H□□ or F□□

("□" stands for a number.)

- Check and correct the speaker cable connections.
- There is something unusual.
- Check the unit using the troubleshooting guide. If the service number remains displayed, do the following.
 - ① Disconnect the plug from the household mains socket, wait a few seconds, then reconnect it.
 - ② Press [⏻/I] to turn the unit on.

If the service number remains displayed despite doing the above, request service from the dealer. Inform the dealer of the service number when requesting service.

IPOD OVER CURRENT ERROR

- The iPod/iPhone is drawing too much power. Remove the iPod/iPhone, and turn the unit off and on again.

START

- The system is being restarted during the firmware update. Please do not turn off the unit.

UPD□/□

("□" stands for a number.)

- The firmware is being updated. Please do not turn off the unit.

FINISH

- The firmware update is complete.

NOT CONDITIONAL

- The requested operation cannot be conducted.

SET OK

- The stations are set, and the radio tunes to the last preset station.

ERROR

- Automatic presetting is unsuccessful. Preset the stations manually.

TUNED/STEREO

- Stereo broadcasting or stereo sound is selected.

TUNED

- Monaural broadcasting or monaural sound is selected.

Specifications

GENERAL

Power consumption	BTT880 Approx. 89 W
	BTT480 BTT460 BTT400 Approx. 80 W
	BTT300 Approx. 60 W
Power consumption in standby mode	Approx. 0.1 W (BTT880 When the other connected devices are turned off)
Power supply	For Australia and New Zealand AC 220 V to 240 V, 50 Hz
	For the Middle East For South East Asia
	AC 220 V to 240 V, 50 Hz/60 Hz
BTT880 iPod/iPhone Connector	DC OUT 5 V 1.0 A MAX 1 system
Dimensions (W×H×D)	BTT880 460 mm × 38.7 mm × 279.3 mm
	BTT480 BTT460 BTT400 BTT300 460 mm × 47.7 mm × 265.4 mm
Mass	BTT880 Approx. 2.7 kg
	BTT480 BTT460 BTT400 BTT300 Approx. 2.4 kg
Operating temperature range	0 °C to 40 °C
Operating humidity range	35 % to 80 % RH (no condensation)
LASER Specification	Class 1 LASER Product Wave length: 790 nm (CDs)/ 660 nm (DVDs)/405 nm (BDs) Laser power: No hazardous radiation is emitted with the safety protection

SPEAKER SECTION

	Woofer CONE TYPE (cm)	Full range CONE TYPE (cm)	Super tweeter Piezo type
BTT880 BTT480			
Front	—	6.5	○
Centre	—	6.5	○
Surround	—	6.5	○
Subwoofer	20	—	—
BTT460			
Front	—	6.5	○
Centre	—	6.5	○
Surround	—	6.5	○
Subwoofer	20	—	—
BTT400			
Front	—	6.5	○
Centre	—	6.5	○
Surround	—	6.5	○
Subwoofer	16	—	—
BTT300			
Front	—	6.5	—
Centre	—	6.5	—
Surround	—	6.5	—
Subwoofer	16	—	—

	Dimensions (W (mm)×H (mm)×D (mm))	Mass (Approx. kg)
BTT880 BTT480		
Front	270 × 1185 × 270	2.45
Centre	280 × 86 × 78	0.67
Surround	270 × 1185 × 270	2.45
Subwoofer	232 × 406 × 316	5.7
BTT460		
Front	270 × 1185 × 270	2.45
Centre	280 × 86 × 78	0.67
Surround	80 × 143 × 75	0.48
Subwoofer	232 × 406 × 316	5.7
BTT400		
Front	80 × 143 × 75	0.48
Centre	280 × 86 × 78	0.67
Surround	80 × 143 × 75	0.48
Subwoofer	145 × 289.5 × 258	3.0
BTT300		
Front	80 × 139 × 70	0.37
Centre	146.5 × 84 × 78	0.5
Surround	80 × 139 × 70	0.37
Subwoofer	145 × 289.5 × 259	3.0

* **BTT880 BTT480 BTT460 BTT400**
The impedance of all the speakers is 3 Ω.

BTT300

The impedance of speakers:

- Front speakers, Centre speaker, Surround speakers: 5 Ω
- Subwoofer: 3 Ω

AMPLIFIER SECTION

RMS TTL POWER OUTPUT	BTT880 BTT480 BTT460 BTT400 1000 W BTT300 435 W
BTT880	1 kHz, 10 % total harmonic distortion FRONT: 185 W per ch (3 Ω) CENTRE: 180 W per ch (3 Ω) 100 Hz, 10 % total harmonic distortion SUBWOOFER: 200 W per ch (3 Ω)
BTT480 BTT460 BTT400	1 kHz, 10 % total harmonic distortion FRONT: 160 W per ch (3 Ω) CENTRE: 160 W per ch (3 Ω) SURROUND: 160 W per ch (3 Ω) 100 Hz, 10 % total harmonic distortion SUBWOOFER: 200 W per ch (3 Ω)
BTT300	1 kHz, 10 % total harmonic distortion FRONT: 67 W per ch (5 Ω) CENTRE: 67 W per ch (5 Ω) SURROUND: 67 W per ch (5 Ω) 100 Hz, 10 % total harmonic distortion SUBWOOFER: 100 W per ch (3 Ω)
Audio Input	AUX × 1
Digital Audio Input	Optical × 1 Sampling frequency: 32 kHz, 44.1 kHz, 48 kHz Audio Format: PCM, Dolby Digital, DTS

FM TUNER SECTION

Frequency range	87.50 MHz to 108.00 MHz (50 kHz step)
Antenna terminals	75 Ω (unbalanced)

TERMINAL SECTION

USB slot	USB2.0 BTT880 BTT480 BTT460 BTT400 2 system BTT300 1 system
SD card slot	Connector 1 system
Ethernet	10BASE-T/100BASE-TX 1 system
BTT880 Wireless LAN	Standard Compliance: IEEE802.11 b/g/n Frequency range: 2.4 GHz band Security: WPA™/WPA2™ (Encryption Type: TKIP/AES, Authentication Type: PSK), WEP (64 bit/128 bit)

VIDEO SECTION

Signal system	PAL/NTSC
HDMI AV output*	Output connector: Type A (19 pin) 1 system
BTT880 HDMI AV Input*	Input connector: Type A (19 pin) 2 system

* This unit supports "HDAVI Control 5" function.

BTT880 WIRELESS SYSTEM AND DIGITAL TRANSMITTER

<AMPLIFIER SECTION>	
RMS TTL POWER OUTPUT	250 W
	1 kHz, 10 % total harmonic distortion
	SURROUND: 125 W per ch (3 Ω)
<RF SECTION>	
Wireless module	Frequency range: 2.4 GHz to 2.4835 GHz No. of channels: 3
<GENERAL>	
Power supply	AC 220 V to 240 V, 50 Hz
Power consumption	Digital transmitter: 1.2 W
	Wireless system: 43 W
Power consumption in off mode	Approx. 0.3 W
Dimensions (W×H×D)	Digital transmitter: 43.3 mm×37.3 mm×8.2 mm
	Wireless system: 165 mm×91.5 mm×164 mm
Mass	Digital transmitter: Approx. 0.01 kg
	Wireless system: Approx. 0.66 kg
Operating temperature range	0 °C to 40 °C
Operating humidity range	35 % to 80 % RH (no condensation)

Specifications are subject to change without notice.

File format

File format	Extension	Reference
MP3	".MP3", ".mp3"	This unit supports ID3 tags, but only titles, artist names and album names can be displayed.
JPEG	".JPG", ".jpg"	<ul style="list-style-type: none"> MOTION JPEG and Progressive JPEG are not supported. You may not be able to play back the file if you have edited the folder structure or the file name on a PC or other device.
MKV	".MKV", ".mkv"	<ul style="list-style-type: none"> Except South East Asia The video file and subtitles text file are inside the same folder, and the file names are the same except for the file extensions. Some MKV file may not play back, depending on the video resolution and frame rate condition.
	Except South East Asia Subtitles text file ".SRT", ".srt", ".SSA", ".ssa", ".ASS", ".ass"	
FLAC	".FLAC", ".flac"	Maximum sampling rate: 192 kHz/24 bit
WAV	".WAV", ".wav"	Maximum sampling rate: 48 kHz/16 bit
MPO	".MPO", ".mpo"	3D still picture

- With certain recording states and folder structures, the play order may differ or playback may not be possible.

Supported format for DLNA

- File formats that are not supported by your DLNA server cannot be played.

Video

Container	Video codec	Audio codec	Example of file extension
AVCHD	H.264	Dolby Digital	.mts
MP4	H.264	AAC	.mp4
PS	MPEG2	Dolby Digital Linear PCM	.mpg, .mpeg
TS	MPEG2 H.264	AAC Dolby Digital	.m2ts .ts

Photo

Format	Example of file extension
JPEG	.jpg

Audio

Audio codec	Example of file extension
MP3	.mp3
AAC	.m4a
FLAC	.flac
Linear PCM	—

Display languages list

Display Language	Display Language	Display Language
ENG English	JPN Japanese	ARA Arabic
FRA French	CHI Chinese	HIN Hindi
DEU German	KOR Korean	PER Persian
ITA Italian	MAL Malay	IND Indonesian
ESP Spanish	VIE Vietnamese	MRI Maori
NLD Dutch	THA Thai	BUL Bulgarian
SVE Swedish	POL Polish	RUM Romanian
NOR Norwegian	CES Czech	GRE Greek
DAN Danish	SLK Slovak	TUR Turkish
POR Portuguese	HUN Hungarian	* Others
RUS Russian	FIN Finnish	

Language code list

Language	Code	Language	Code	Language	Code
Abkhazian:	6566	Gujarati:	7185	Rhaeto-Romance:	
Afar:	6565	Hausa:	7265		8277
Afrikaans:	6570	Hebrew:	7387	Romanian:	8279
Albanian:	8381	Hindi:	7273	Russian:	8285
Amharic:	6577	Hungarian:	7285	Samoan:	8377
Arabic:	6582	Icelandic:	7383	Sanskrit:	8365
Armenian:	7289	Indonesian:	7378	Scots Gaelic:	7168
Assamese:	6583	Interlingua:	7365	Serbian:	8382
Aymara:	6589	Irish:	7165	Serbo-Croatian:	8372
Azerbaijani:	6590	Italian:	7384	Shona:	8378
Bashkir:	6665	Japanese:	7465	Sindhi:	8368
Basque:	6985	Javanese:	7487	Singhalese:	8373
Bengali; Bangla:		Kannada:	7578	Slovak:	8375
	6678	Kashmiri:	7583	Slovenian:	8376
Bhutani:	6890	Kazakh:	7575	Somali:	8379
Bihari:	6672	Kirghiz:	7589	Spanish:	6983
Breton:	6682	Korean:	7579	Sundanese:	8385
Bulgarian:	6671	Kurdish:	7585	Swahili:	8387
Burmese:	7789	Laotian:	7679	Swedish:	8386
Byelorussian:	6669	Latin:	7665	Tagalog:	8476
Cambodian:	7577	Latvian, Lettish:	7686	Tajik:	8471
Catalan:	6765	Lingala:	7678	Tamil:	8465
Chinese:	9072	Lithuanian:	7684	Tatar:	8484
Corsican:	6779	Macedonian:	7775	Telugu:	8469
Croatian:	7282	Malagasy:	7771	Thai:	8472
Czech:	6783	Malay:	7783	Tibetan:	6679
Danish:	6865	Malayalam:	7776	Tigrinya:	8473
Dutch:	7876	Maltese:	7784	Tonga:	8479
English:	6978	Maori:	7773	Turkish:	8482
Esperanto:	6979	Marathi:	7782	Turkmen:	8475
Estonian:	6984	Moldavian:	7779	Tw:	8487
Faroese:	7079	Mongolian:	7778	Ukrainian:	8575
Fiji:	7074	Nauru:	7865	Urdu:	8582
Finnish:	7073	Nepali:	7869	Uzbek:	8590
French:	7082	Norwegian:	7879	Vietnamese:	8673
Frisian:	7089	Oriya:	7982	Volapük:	8679
Galician:	7176	Pashto, Pushto:	8083	Welsh:	6789
Georgian:	7565	Persian:	7065	Wolof:	8779
German:	6869	Polish:	8076	Xhosa:	8872
Greek:	6976	Portuguese:	8084	Yiddish:	7473
Greenlandic:	7576	Punjabi:	8065	Yoruba:	8979
Guarani:	7178	Quechua:	8185	Zulu:	9085

"AVCHD", "AVCHD 3D", "AVCHD Progressive" and "AVCHD 3D/Progressive" are trademarks of Panasonic Corporation and Sony Corporation.

Java is a registered trademark of Oracle and/or its affiliates.

Manufactured under license from Dolby Laboratories.

Dolby, Pro Logic, and the double-D symbol are trademarks of Dolby Laboratories.

Manufactured under license under U.S. Patent Nos. 5,956,674; 5,974,380; 6,226,616; 6,487,535; 7,392,195; 7,272,567; 7,333,929; 7,212,872 & other U.S. and worldwide patents issued & pending. DTS-HD, the Symbol, & DTS-HD and the Symbol together are registered trademarks & DTS-HD Master Audio | Essential is a trademark of DTS, Inc. Product includes software. © DTS, Inc. All Rights Reserved.

HDMI, the HDMI Logo, and High-Definition Multimedia Interface are trademarks or registered trademarks of HDMI Licensing LLC in the United States and other countries.

This product is licensed under the AVC patent portfolio license and VC-1 patent portfolio license for the personal and non-commercial use of a consumer to (i) encode video in compliance with the AVC Standard and VC-1 Standard ("AVC/VC-1 Video") and/or (ii) decode AVC/VC-1 Video that was encoded by a consumer engaged in a personal and non-commercial activity and/or was obtained from a video provider licensed to provide AVC/VC-1 Video. No license is granted or shall be implied for any other use. Additional information may be obtained from MPEG LA, LLC. See <http://www.mpegla.com>.

HDAVI Control™ is a trademark of Panasonic Corporation.

VIERA Connect is a trademark of Panasonic Corporation.

MPEG Layer-3 audio coding technology licensed from Fraunhofer IIS and Thomson.

SDXC Logo is a trademark of SD-3C, LLC.

"DVD Logo" is a trademark of DVD Format/Logo Licensing Corporation.

"Wi-Fi", "Wi-Fi Protected Setup", "Wi-Fi Direct", "WPA" and "WPA2" are marks or registered marks of the Wi-Fi Alliance.

The Wi-Fi CERTIFIED Logo is a certification mark of the Wi-Fi Alliance.

The Wi-Fi Protected Setup Mark is a mark of the Wi-Fi Alliance.

DLNA, the DLNA Logo and DLNA CERTIFIED are trademarks, service marks, or certification marks of the Digital Living Network Alliance.

Windows is a trademark or a registered trademark of Microsoft Corporation in the United States and other countries.

"Made for iPod", and "Made for iPhone" mean that an electronic accessory has been designed to connect specifically to iPod, or iPhone, respectively, and has been certified by the developer to meet Apple performance standards.

Apple is not responsible for the operation of this device or its compliance with safety and regulatory standards. Please note that the use of this accessory with iPod, or iPhone may affect wireless performance.

iPhone, iPod, iPod classic, iPod nano, and iPod touch are trademarks of Apple Inc., registered in the U.S. and other countries.

The Skype name, associated trade marks and logos and the "S" logo are trade marks of Skype.

Copyright 2004-2010 Verance Corporation. Cinavia™ is a Verance Corporation trademark. Protected by U.S. Patent 7,369,677 and worldwide patents issued and pending under license from Verance Corporation. All rights reserved.

This product incorporates the following software:

- (1) the software developed independently by or for Panasonic Corporation,
- (2) the software owned by third party and licensed to Panasonic Corporation,
- (3) the software licensed under the GNU General Public License, Version 2 (GPL v2),
- (4) the software licensed under the GNU LESSER General Public License, Version 2.1 (LGPL v2.1) and/or,
- (5) open sourced software other than the software licensed under the GPL v2 and/or LGPL v2.1

For the software categorized as (3) and (4), please refer to the terms and conditions of GPL v2 and LGPL v2.1, as the case may be at

<http://www.gnu.org/licenses/old-licenses/gpl-2.0.html> and

<http://www.gnu.org/licenses/old-licenses/lgpl-2.1.html>.

In addition, the software categorized as (3) and (4) are copyrighted by several individuals. Please refer to the copyright notice of those individuals at

<http://panasonic.net/avc/oss/bdplayer/AWBPP12.html>

The GPL/LGPL software is distributed in the hope that it will be useful, but WITHOUT ANY WARRANTY, without even the implied warranty of MERCHANTABILITY or FITNESS FOR A PARTICULAR PURPOSE.

At least three (3) years from delivery of products, Panasonic will give to any third party who contacts us at the contact information provided below, for a charge no more than our cost of physically performing source code distribution, a complete machine-readable copy of the corresponding source code covered under GPL v2/ LGPL v2.1.

Contact Information

cdrequest.bdplayer@gg.jp.panasonic.com

Source code is also freely available to you and any other member of the public via our website below.

<http://panasonic.net/avc/oss/bdplayer/AWBPP12.html>

For the software categorized as (5) includes as follows.

1. This product includes software developed by the OpenSSL Project for use in the OpenSSL Toolkit.
(<http://www.openssl.org/>)
2. This product includes software developed by the University of California, Berkeley and its contributors.
3. FreeType code.
4. The Independent JPEG Group's JPEG software.

(1) MS/WMA

This product is protected by certain intellectual property rights of Microsoft Corporation and third parties. Use or distribution of such technology outside of this product is prohibited without a license from Microsoft or an authorized Microsoft subsidiary and third parties.

(2) Vorbis, FLAC, WPA Supplciant

The software licenses are displayed when "Software Licence" in the Setup menu is selected. (→ 42)

BTT880

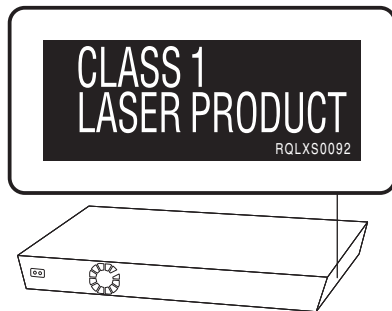

BTT480 BTT460 BTT400 BTT300

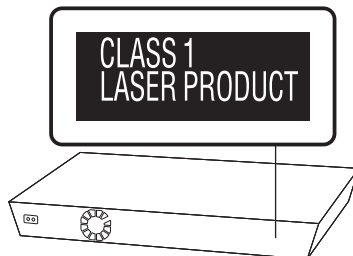

CAUTION	VISIBLE AND INVISIBLE LASER RADIATION WHEN OPEN. DO NOT STARE INTO BEAM. FDA 21CFR136.1 (IIa)
CAUTION	CLASS 2 VISIBLE AND INVISIBLE LASER RADIATION WHEN OPEN. DO NOT STARE INTO THE BEAM. IEC60825-1:CLASS 2
ATTENTION	RAYONNEMENT LASER VISIBLE ET INVISIBLE, CLASSE 2. EN CAS D'OUVERTURE, NE PAS REGARDER DANS LE FAISCEAU.
FORSIGTIG	SYNLIG OG USYNLIG LASERSTRÅLING KLASSE 2, NÅR LÅGET ER ÅBENT. UNDGÅ AT SE LIGE IND I STRÅLEN.
VARO	AVATTAESSA OLET ALTTIINA LUOKAN 2 NÄKYVÄÄ JA NÄKYMÄTÖNTÄ LASERISATEILYÄ; ÄLÄ TUJOTA SÄTEESEEN.
WARNING	CLASS 2 SYNLIG OCH OSYNLIG LASERSTRÅLNING NÄR DENNA DEL ÄR ÖPPNAD. STIRRA EJ IN I STRÅLEN.
VORSICHT	SICHTBARE UND UNSICHTBARE LASERSTRALUNG KLASSE 2, WENN ABDECKUNG GEÖFFNET, NICHT IN DEN STRAHL BLICKEN.
注意	打开时有可见及不可见激光辐射。避免光束照射。
注意	ここを開くとクラス2の可視及び不可視レーザー放射が出る。ビームをのぞき込まないこと。 VQL2P54

(Inside of product)



Limited Warranty (ONLY FOR AUSTRALIA)

Panasonic Warranty

1. The product is warranted for 12 months from the date of purchase. Subject to the conditions of this warranty Panasonic or its Authorised Service Centre will perform necessary service on the product without charge for parts or labour, if in the opinion of Panasonic, the product is found to be faulty within the warranty period.
2. This warranty only applies to Panasonic products purchased in Australia and sold by Panasonic Australia or its Authorised Distributors or Dealers and only where the products are used and serviced within Australia or its territories. Warranty cover only applies to service carried out by a Panasonic Authorised Service Centre and only if valid proof of purchase is presented when warranty service is requested.
3. This warranty only applies if the product has been installed and used in accordance with the manufacturer's recommendations (as noted in the operating instructions) under normal use and reasonable care (in the opinion of Panasonic). The warranty covers normal domestic use only and does not cover damage, malfunction or failure resulting from use of incorrect voltages, incorrect installation, accident, misuse, neglect, build-up of dirt or dust, abuse, maladjustment of customer controls, mains supply problems, thunderstorm activity, infestation by insects or vermin, tampering or repair by unauthorised persons (including unauthorised alterations), introduction of sand, humidity or liquids, commercial use such as hotel, office, restaurant, or other business or rental use of the product, exposure to abnormally corrosive conditions or any foreign object or matter having entered the product.
4. This warranty does not cover the following items unless the fault or defect existed at the time of purchase:
 - (a) Cabinet Part(s)
 - (b) Video or Audio Tapes
 - (c) SD cards or USB devices
 - (d) User replaceable Batteries etc
 - (e) DVD, Blu-ray or Recordable Discs
 - (f) Video / Audio Heads from wear and tear in normal use
 - (g) Information stored on Hard Disk Drive, USB stick or SD card
 - (h) DTV reception issues caused by TV Aerial / Cabling / Wall socket(s)
5. Some products may be supplied with Ethernet connection hardware. The warranty is limited on such products and will not cover
 - (a) Internet and or DLNA connection / setup related problems
 - (b) Access fees and or charges incurred for internet connection
 - (c) The use of incompatible software or software not specifically stipulated in the product operations manual; and
 - (d) Any indirect or consequential costs associated with the incorrect use or misuse of the hardware, its connection to the internet or any other device.
6. To claim warranty service, when required, you should:
 - Telephone Panasonic's Customer Care Centre on 132600 or visit our website referred to below and use the Service Centre Locator for the name/address of the nearest Authorised Service Centre.
 - Send or take the product to a Panasonic Authorised Service Centre together with your proof of purchase receipt as a proof of purchase date. Please note that freight and insurance to and / or from your nearest Authorised Service Centre must be arranged by you.
 - Note that home or pick-up/delivery service is available for the following products in the major metropolitan areas of Australia or the normal operating areas of the nearest Authorised Service Centres:
 - Plasma/LCD televisions / displays (screen size greater than 103 cm)
7. The warranties hereby conferred do not extend to, and exclude, any costs associated with the installation, de-installation or re-installation of a product, including costs related to the mounting, de-mounting or remounting of any screen, (and any other ancillary activities), delivery, handling, freight, transportation or insurance of the product or any part thereof or replacement of and do not extend to, and exclude, any damage or loss occurring by reason of, during, associated with, or related to such installation, de-installation, re-installation or transit.

Panasonic Authorised Service Centres are located in major metropolitan areas and most regional centres of Australia, however, coverage will vary dependant on product. For advice on exact Authorised Service Centre locations for your product, please telephone our Customer Care Centre on 132600 or visit our website and use the Service Centre Locator.

In addition to your rights under this warranty, Panasonic products come with consumer guarantees that cannot be excluded under the Australian Consumer Law. If there is a major failure with the product, you can reject the product and elect to have a refund or to have the product replaced or if you wish you may elect to keep the goods and be compensated for the drop in value of the goods. You are also entitled to have the product repaired or replaced if the product fails to be of acceptable quality and the failure does not amount to a major failure.

If there is a major failure in regard to the product which cannot be remedied then you must notify us within a reasonable period by contacting the Panasonic Customer Care Centre. If the failure in the product is not a major failure then Panasonic may choose to repair or replace the product and will do so in a reasonable period of time from receiving notice from you.

**THIS WARRANTY CARD AND THE PURCHASE DOCKET (OR SIMILAR PROOF OF PURCHASE)
SHOULD BE RETAINED BY THE CUSTOMER AT ALL TIMES**

If you require assistance regarding warranty conditions or any other enquiries, please visit the **Panasonic Australia** website www.panasonic.com.au or contact by phone on **132 600**
If phoning in, please ensure you have your operating instructions available.

Panasonic Australia Pty. Limited

ACN 001 592 187 ABN 83 001 592 187

1 Innovation Road, Macquarie Park NSW 2113

PRO-031-F11 Issue: 4.0

01-01-2011

Panasonic Corporation
Web Site: <http://panasonic.net>

